

GIZA PLATEAU MAPPING PROJECT

Grid Square(s) 101.X28	Area KKT	Context Type Deposit	Central Coords	Context 21880
DEPOSIT		<i>crushed</i>	CUT	
<ol style="list-style-type: none"> 1. Compaction 2. Colour 3. Composition/Particle Size (Over 10%) 4. Inclusions (Under 10%) occa / mod / freq 5. Thickness and extent 6. Top and bottom boundaries 7. Other comments 8. Method and conditions 		<ol style="list-style-type: none"> 1. Loose, soft, thin alluvial over limestone 2. Greyish, ashy black, dark 3. Silty about 90% 4. Small amounts of limestone & ceramics some ash 5. 2.5 m N-S 1.20 m E-W with thickness decreasing as you move south 6. N/A 		<ol style="list-style-type: none"> 1. Shape in plan 2. Corners 3. Dimension/Depth 4. Break of slope-top 5. Sides 6. Break of slope-base 7. Base 8. Orientation 9. Inclination of axis 10. Truncated (if known) 11. Fill #s 12. Other comments
Draw profile overleaf				

Type of feature:

Stratigraphic Matrix

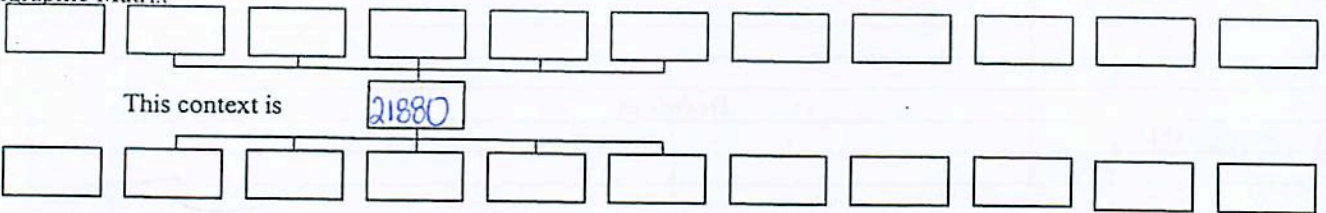

Your interpretation:

Mudbrick alluvial
over crushed limestone

Internal External Structural Other (specify)

Your discussion:

Feature overlays L
Crushed limestone surrounds feature 21880 ~~around~~ so that it
is an island of alluvial mud within the square.
It may be associated with the wall (feature 21876)
as it lies 1.65m to the east of it.

Placement in square

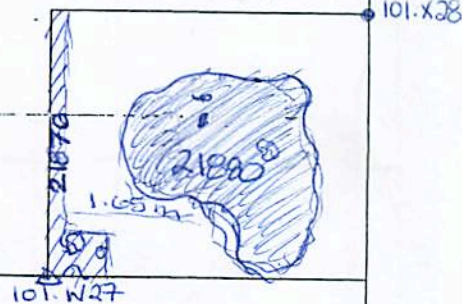

Context same as:

See contexts:

21876

Site Book Refs:

Matrix phase:

Initials and date

KLW 5.IV.2008

Checked Interpretation:

Provisional period

Group/Phase

Initials and date

Context Number 21880	GPMP
Bag Numbers	
Ceramics	Objects
Environmental Samples & Type	Exotics
Charcoal	
	Other
Bones	
Lithics	
Photographs	

Drawings	
Plans 2005.1419	Sections
Top Elevation 18.52	Bottom Elevations 18.43

