

GPMP 2008	GRID SQUARE(S) 101 V.29-30	ARCHITECTURE	CONTEXT 21885
------------------	--------------------------------------	---------------------	-------------------------

1. Material	1 - Mud
2. Size of materials	2 - 30:40 cm Long x 20 cm Wide x 13 cm thickness
3. Finish	3 - base rough setting uneven
4. Coursing/bond	4 - one row stretcher 3x40cm x 20cm / one row header 3x10cm
5. Form	5 - Wall
6. Direction of faces	6 - N-S
7. Orientation	7 - E-W
8. Dimensions	8 - 3.20 ^m Long x 70 cm : 93 cm wide
9. Associated collapse	9 - N.A
10. Founds, cuts & fills	10 - N.A
11. Repaired	11 - N.A
12. Associated floors	12 - N.A
13. Plastered	13 - N.A
14. Wall core	14 - N.A
15. Types of brick (%)	15 - Mud 80% and Sand 20%
16. Composition of bricks	16 - Mud (pubble guimne) Sand and straw
17. Dimensions of bricks (sample of three)	17 - see above

Stratigraphic Matrix 	Abuts	Above
	Abutted by	Below
	Bonded into	
	Contiguous with	21886

INTERPRETATION	Enclosing	Internal	External
Reason for decay	East-west W WALL South of the wall 21883 which meets corner 21886 (NS)		
Indications of original dimensions			
Indications of original functions			

Associated contexts:

Context Same As:

Drawing Nos: 2005-284-		Samples	
Photographs	Findings	Building Complex:	
Roll	Bag No. Type		
Frames		Phase	
+W			
CS			
DP			
CP	Site Book Pages	Checked	Initials DESJ Date 22-11-08

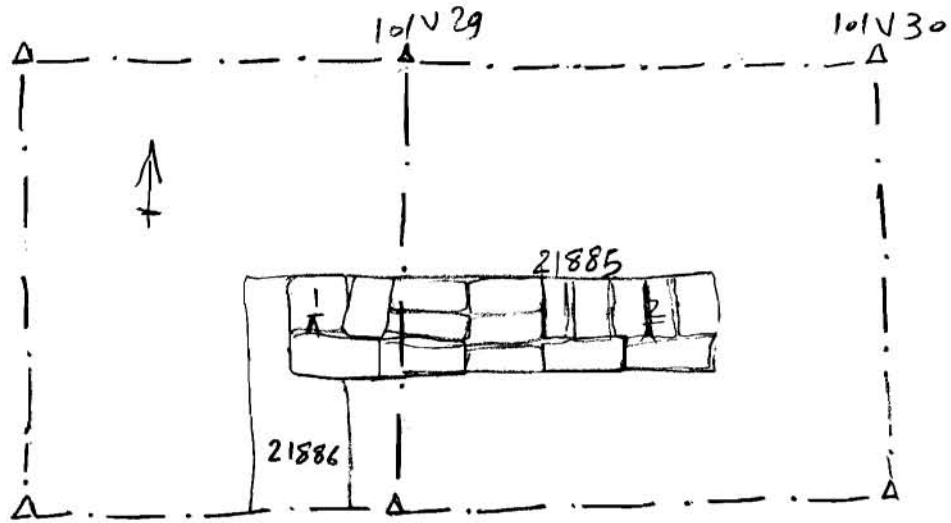

F# 21885

T.B.M: 18.54

B.S: 2.76

Loc: 21.30

π	RL
1- 3.08	1- 18.22
2- 3.25	2- 18.05