

GPMP 20045	GRID SQUARE(s) 101. U29, 101. U30	ARCHITECTURE	CONTEXT 21886
1. Material	1. Mudbrick, silty bricks		
2. Size of materials	2. Sizes range: 400mm x 200mm 330mm x 200mm		
3. Finish	3. N/A		
4. Coursing/bond	4.		
5. Form	5. wall		
6. Direction of faces	6. East & West faces		
7. Orientation	7. North-South -		
8. Dimensions	8. .60m Thick 7.20 m Long & meets 21923		
9. Associated collapse	9. N/A		
10. Founds, cuts & fills	10. Mainly silty mud deposits (see excavation)		
11. Repaired	11. N/A		
12. Associated floors	12. N/A		
13. Plastered	13. yellow wall plaster Yellow wall plaster, Gypsum Plaster lining		
14. Wall core	14. (see fills)		
15. Types of brick (%)	15-17: see above		
16. Composition of bricks			
17. Dimensions of bricks (sample of 3)			

Stratigraphic Matrix	Abuts 21885	Above
	Abutted by	Below
	Bonded into	
	Contiguous with 21923	

INTERPRETATION	Enclosing	Internal	External
Reason for decay	North South wall associated with 21885		
Indications of original dimensions	at the North & 21923 at the South		
Indications of original functions			

Associated contexts: 21923, 21885

Context Same As:

Drawing Nos: 2005.284 - 2008-41	Samples
Photographs 510871 - 510873	Finds Bag No. Type 05-508 COIN (FIND SPOT GENERALLY MARKED)
Roll	Building Complex;
Frames	Phase
B+W	
CS	
DP	
CP	Checked Initials DEJW Date 22-11-08
	Site Book Pages

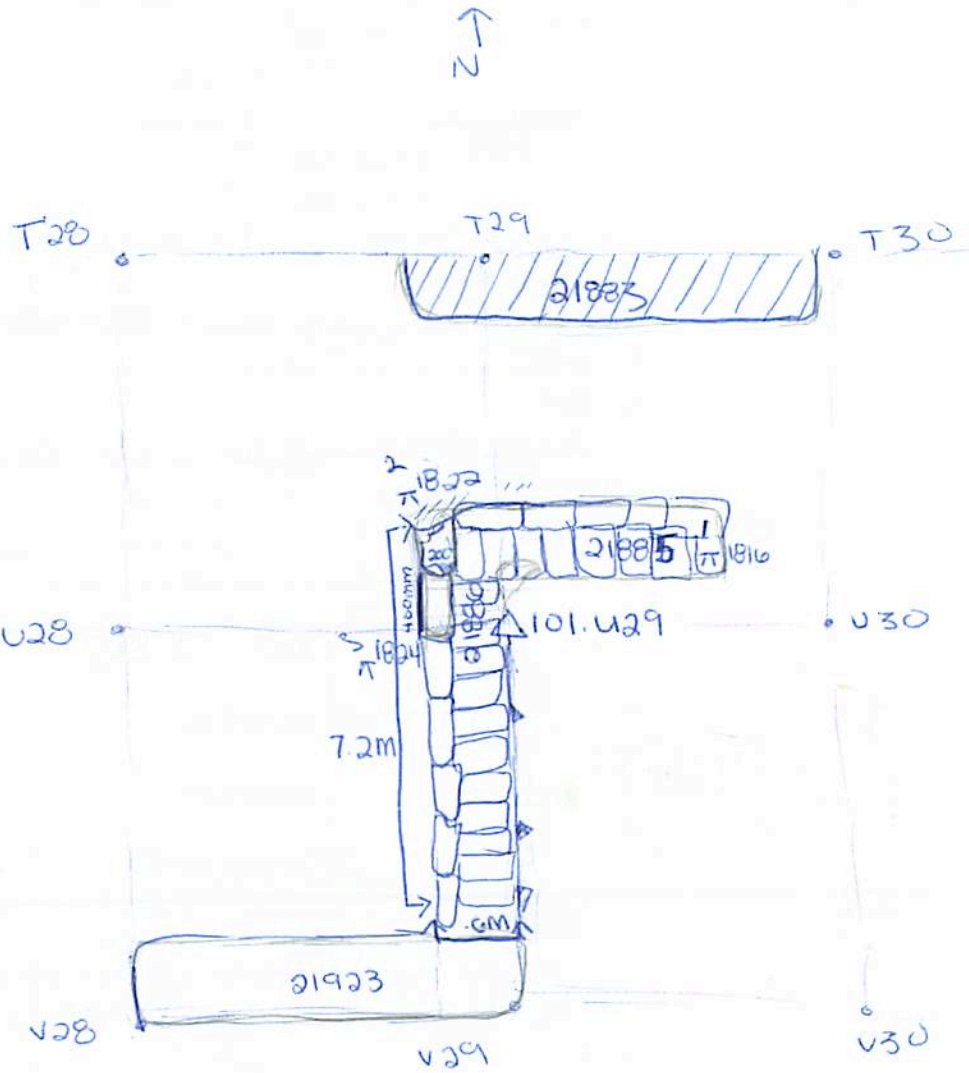

- 1 \varnothing 18.10
- 2 \varnothing 18.22
- 3 \varnothing 18.24