

[AWAITING EXCAVATION]

FF.changed  
3/2008

GIZA PLATEAU MAPPING PROJECT

Grid Square(s) 101.Y- Z 27-29/201.Y- 101.Y28, 101.Y29	Area KKT	Context Type DEPOSIT	Central Coords	Context 21931
DEPOSIT		1) COMPACT		CUT
1. Compaction	2) LIGHT YELLOWISH WHITE		1. Shape in plan	
2. Colour	3) LIMESTONE COBBLES (14-20cm), LIMESTONE CHIPS (LARGE 4-6 CM AND SMALL 1-4 CM) FINE TO MED SAND; ANGULAR TO SUB-ANGULAR; MOD. WELL-SORTED		2. Corners	
3. Composition/Particle Size (Over 10%)	4) MUD BRICK MATERIAL, MOD.; POT SHARD; OCC, FLICKS OF CHARRED MATERIAL, OCC.		3. Dimension/Depth	
4. Inclusions (Under 10%) occa / mod / freq	5) THICKNESS: 430 mm		4. Break of slope-top	
5. Thickness & extent	EXTENT: 6m x 20m m 202m Wide		5. Sides	
6. Top & bottom boundaries			6. Break of slope-base	
7. Other comments			7. Base	
8. Method and conditions			8. Orientation	
6)			9. Inclination of axis	
7)			10. Truncated (if known)	
8) CRUSHED LIMESTONE DEPOSIT			11. Fill #s	
Type of feature:			12. Other comments	
Stratigraphic Matrix			Draw profile overleaf	
<p>This context is 21931</p>				
Your interpretation:	Internal	External	Structural	Other (specify)
Your discussion: THIS DEPOSIT COMPRISES THE CRUSHED LIMESTONE LAYER TO THE WEST OF THE BASIN (21926 AND 21935). IT IS BOUNDED ON THE EAST BY THE BASIN, TO THE WEST BY WALL (21876), TO THE NORTH IT IS GENERALLY BOUNDED BY CUT (21927) AND TO THE SOUTH BY LIMESTONE POUCH CUT BLOCKS (21930) AND MUD BRICK WALL (21877) INSTALLED WITHIN IT ARE 2 PYROTECHNIC FEATURES (21829 AND 21828).				
Context same as:	See contexts: 21928			
Site Book Refs:	Matrix phase:	Initials and date KEP 11.05		
Checked Interpretation:				
Provisional period	Group/Phase	Initials and date		

Context Number 21931

GPMP 2005

Bag Numbers

Ceramics

Objects

Environmental Samples & Type

Exotics

Charcoal

Other

Bones

Lithics

Photographs

Drawings

Plans

Sections



Top Elevation 19.562 m ASL

Bottom Elevation 19.132 m ASL

Sketch Plan

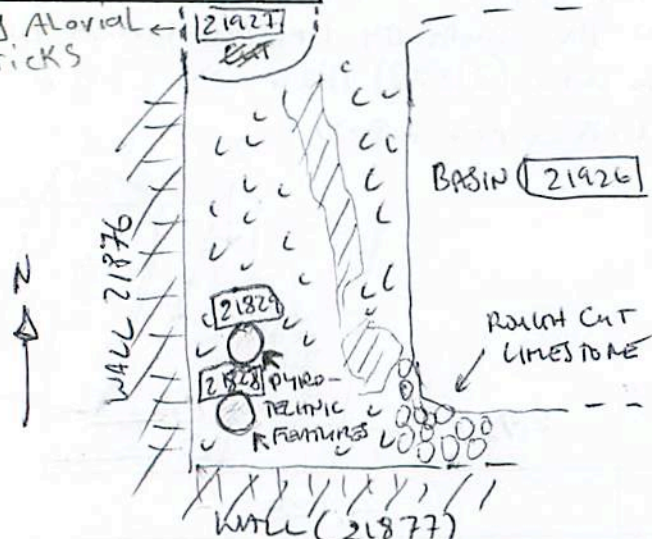
decay Alovial Bricks



-  = MUD BRICK / MUD BRICK MATERIAL
-  = CRUSHED LIMESTONE (21931)