

GPMP 2008	GRID SQUARE(S) 101728, 101729	ARCHITECTURE	CONTEXT 21938
1. Material	1. Mudbrick : UTA & silty bricks		
2. Size of materials	2. UTA bricks 33 cm x 19 cm x 11 cm		
3. Finish	silty 31 cm x 19 cm x 12 cm		
4. Coursing/bond	3. n/a		
5. Form	4. core of wall w/ one line of stretcher		
6. Direction of faces	bricks laid on edge and one line of headers		
7. Orientation	to the west one extra row of headers which		
8. Dimensions	are very worn.		
9. Associated collapse	5. na		
10. Foundations & fills	6. North to South		
11. Repaired	7. " "		
12. Associated floors	8 max lgth: 1.8m max width 1.5m		
13. Plastered	9 n/a		
14. Wall core	10 n/a		
15. Types of brick (%)	14-17 detailed above		
16. Composition of bricks			
17. Dimensions of bricks (sample of three)			

Stratigraphic Matrix	<input type="checkbox"/>	<input type="checkbox"/>	<input type="checkbox"/>	Abuts 21877 to the North	Above
	<input checked="" type="checkbox"/>	21938	<input type="checkbox"/>	Abutted by	Below
	<input type="checkbox"/>	21877	<input type="checkbox"/>	Bonded into	
				Contiguous with	

INTERPRETATION	Enclosing	Internal	External
Reason for decay	Mudbrick wall running north to south. To the north it is abutted by 21877 leading to the		
Indications of original dimensions	conclusion that 21877 is earlier than 21938		
Indications of original functions			

Associated contexts:			
Context Same As:			
Drawing Nos:		Samples	
Photographs	Findings		
Roll	Bag No.	Type	
Frames		Building Complex:	
B+W		Phase	
CS			
DP			
CP	Site Book Pages	Checked	Initials KLW Date 5. III. 2008

201.A27



201.A29



101.Z28

101.Z29

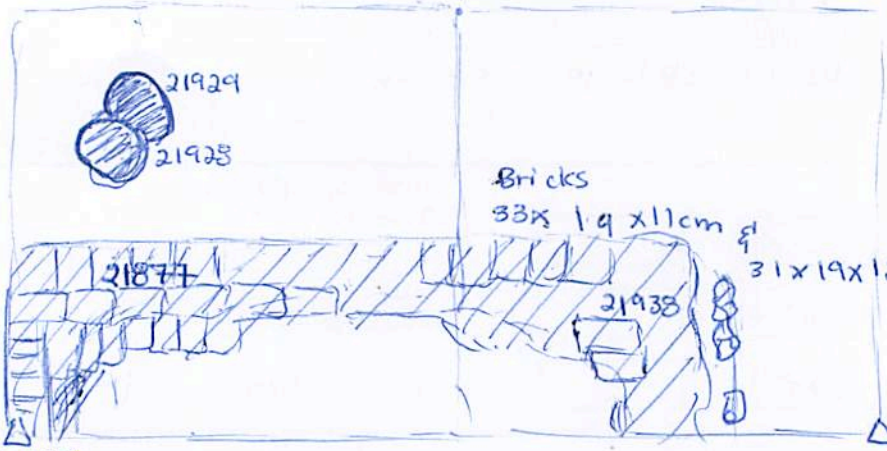

21929
21928

Bricks
33x19x11cm

31x19x12cm

21877

21938

101.V27

101.Y29



101.W27

101.W.29