

GIZA PLATEAU MAPPING PROJECT 2009

Grid Square(s) 201- G35, G36	Area KKTE.	Context Type DEPOSIT	Central Coords	Context 29053																																	
DEPOSIT		CUT																																			
1. Compaction 2. Colour 3. Composition/Particle Size (Over 10%) 4. Inclusions (Under 10%) occa / mod / freq 5. Thickness and extent 6. Top and bottom boundaries 7. Other comments 8. Method and conditions	1) COMPACT. 2) DARK BROWN 3) 90% FRAGMENTED MUDBRICK 10% COARSE SAND & LIMESTONE CHIPS. 4) FREQ POTTERY FRAGMENTS FREQ MARL FREQ CHARCOAL FLECKS AND LIME FREQ SMALL SHELLS. PLASTER FRAG FREQ SMALL LIMESTONE CHIPS 5) E/W: 5m 66cm N/S: 4m 24cm THICKNESS: 30cm (MAX) 6) BOTH CLEAR EXCEPT ITS WESTERN		1. Shape in plan 2. Corners 3. Dimension/Depth 4. Break of slope-top 5. Sides 6. Break of slope-base 7. Base 8. Orientation 9. Inclination of axis 10. Truncated (if known) 11. Fill #s 12. Other comments Draw profile overleaf																																		
INTERFACE WITH (29046)																																					
7) TRUNCATED AT EASTERN LIMIT BY EROSION (30826)																																					
ALL INCLUSIONS WELL SORTED. 8) WARM & DRY EXCAVATED WITH MATTOCK & TROWEL.																																					
Type of feature: COLLAPSE DEPOSIT																																					
Stratigraphic Matrix																																					
<table style="width: 100%; border: none;"> <tr> <td style="border: 1px solid black; width: 20px; height: 20px;"></td> <td style="border: 1px solid black; width: 20px; height: 20px;"></td> <td style="border: 1px solid black; width: 20px; height: 20px; text-align: center;">30823</td> <td style="border: 1px solid black; width: 20px; height: 20px; text-align: center;">30815</td> <td style="border: 1px solid black; width: 20px; height: 20px; text-align: center;">30826</td> <td style="border: 1px solid black; width: 20px; height: 20px; text-align: center;">30818</td> <td style="border: 1px solid black; width: 20px; height: 20px; text-align: center;">29827</td> <td style="border: 1px solid black; width: 20px; height: 20px; text-align: center;">29828</td> <td style="border: 1px solid black; width: 20px; height: 20px; text-align: center;">29847</td> <td style="border: 1px solid black; width: 20px; height: 20px; text-align: center;">30825</td> <td style="border: 1px solid black; width: 20px; height: 20px;"></td> </tr> <tr> <td colspan="11" style="text-align: center;">This context is 29053 = 30834 = 29046 = 29045 = 28998 = 29925 = 30883 = 30826</td> </tr> <tr> <td style="border: 1px solid black; width: 20px; height: 20px;"></td> <td style="border: 1px solid black; width: 20px; height: 20px;"></td> <td style="border: 1px solid black; width: 20px; height: 20px; text-align: center;">30821</td> <td style="border: 1px solid black; width: 20px; height: 20px; text-align: center;">30857</td> <td style="border: 1px solid black; width: 20px; height: 20px; text-align: center;">30845</td> <td style="border: 1px solid black; width: 20px; height: 20px; text-align: center;">32421</td> <td style="border: 1px solid black; width: 20px; height: 20px; text-align: center;">29882</td> <td style="border: 1px solid black; width: 20px; height: 20px; text-align: center;">30824</td> <td style="border: 1px solid black; width: 20px; height: 20px;"></td> <td style="border: 1px solid black; width: 20px; height: 20px;"></td> <td style="border: 1px solid black; width: 20px; height: 20px;"></td> </tr> </table>							30823	30815	30826	30818	29827	29828	29847	30825		This context is 29053 = 30834 = 29046 = 29045 = 28998 = 29925 = 30883 = 30826													30821	30857	30845	32421	29882	30824			
		30823	30815	30826	30818	29827	29828	29847	30825																												
This context is 29053 = 30834 = 29046 = 29045 = 28998 = 29925 = 30883 = 30826																																					
		30821	30857	30845	32421	29882	30824																														
Your interpretation: Internal External Structural Other (specify)																																					
Your discussion: <p style="text-align: center;">DEPOSIT OF COLLAPSE MATERIAL THAT APPEARS TO HAVE ORIGINATED FROM WALLS (29050) & (29047).</p> <div style="float: right; text-align: right;">Placement in square</div> <div style="border: 1px solid black; width: 150px; height: 100px; margin-left: auto; margin-right: 0;"></div>																																					
Context same as:		See contexts:																																			
Site Book Refs:		Matrix phase: 9		Initials and date LISA? DS 29-03-07																																	
Checked Interpretation:																																					
Provisional period		Group/Phase gr. 9726		Initials and date																																	

Context Number **29053** GPMP **2009.**

Bag Numbers

Ceramics **2009-0916**
2009-0933
2009-0934 Objects

Environmental Samples & Type Exotics

Charcoal

Bones Other

Lithics **2009-0935.**

Photographs

Drawings

Plans **29053 x2.** Sections

Top Elevation $\frac{25}{\pi}$ 17.95 Bottom Elevations $\frac{14}{\pi}$ 15.51

Sketch Plan NOT TO SCALE \uparrow

TBM: 17-10
 BS: 2-77
 IH: 20-47
 FS DL
 * 2.84 17.63
 2 3.13 17.34
 3 3.41 17.06
 4 3.84 16.63
 5 3.25 17.22
 6 3.47 17.00
 7 3.61 16.86
 8 2.95 17.52
 9 3.35 17.12
 10 3.52 16.95
 11 3.80 16.67
 12 4.21 16.26
 13 4.74 15.73
 14 4.96 15.51
 15 4.80 15.67
 16 4.15 16.32
 17 3.90 16.57
 18 3.65 16.82
 19 4.31 16.16.

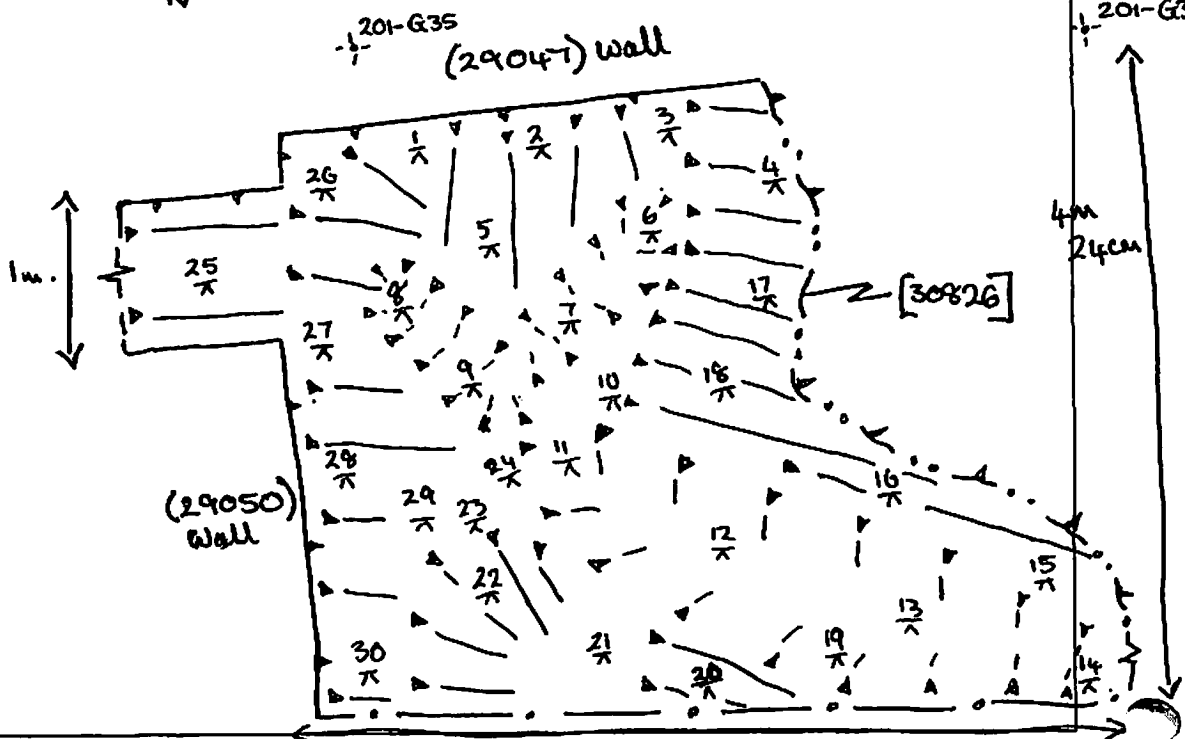

5m.66cm.

$\frac{20}{\pi}$ 4.07 16.40	$\frac{25}{\pi}$ 2.52 17.95
$\frac{21}{\pi}$ 3.72 16.75	$\frac{26}{\pi}$ 2.94 17.53
$\frac{22}{\pi}$ 3.46 17.01	$\frac{27}{\pi}$ 3.05 17.42
$\frac{23}{\pi}$ 3.09 17.38	$\frac{28}{\pi}$ 3.11 17.36
$\frac{24}{\pi}$ 3.25 17.22	$\frac{29}{\pi}$ 3.28 17.19
	$\frac{30}{\pi}$ 3.19 17.28.