

GPMP 2008	GRID SQUARE(S) 101. S27	ARCHITECTURE	CONTEXT 29286
1. Material 2. Size of materials 3. Finish 4. Coursing/bond 5. Form 6. Direction of faces 7. Orientation 8. Dimensions 9. Associated collapse 10. Foundations, cuts & fills 11. Repaired 12. Associated floors 13. Plastered 14. Wall core 15. Types of brick (%) 16. Composition of bricks 17. Dimensions of bricks (sample of three)	1. limestone 2. stones range 200 mm x 300 mm max 200 mm x 350 mm 50 x 30 mm 3. roughly hewn 4. random, coursing difficult to assess with remains 5. wall 6. west face, east face 7. North-South 8. 3.6m long .45 m wide 9. N/A 10. N/A 11. N/A 12. 29649 13. mudvender 14. mainly limestone, occasionally pottery fragment + small 15-17 see above		
Stratigraphic Matrix <div style="display: flex; justify-content: space-around; align-items: center;"> <div style="text-align: center;">  </div> <div style="text-align: center;"> <p>29649</p> <p>29286 =</p> <p>29601</p> </div> <div style="text-align: center;">  </div> </div>	Abuts Above Abuted by Below Bonded into 29601 Contiguous with		
INTERPRETATION (Enclosing) Internal (External)			
Reason for decay Indications of original dimensions Indications of original functions	North-South running wall, which possibly forms ^(Probably) east but is not clear. Possibly contiguous with wall in 101. R27.		
which bonded into wall 29601. It forms a room space 187 from Salim Hassan's plan as well as room 188			
Associated contexts:			
Context Same As:			
Drawing Nos: 2008.09		Samples	
Photographs		Finds Type	
Roll		Bag No.	
Frames		Building Complex:	
B-W		Phase	
CS		Checked	
DP 510842		Initials Date	
CP		Site Book Pages	

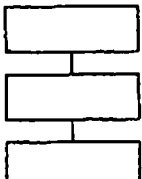
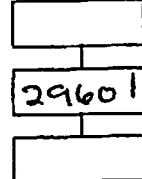
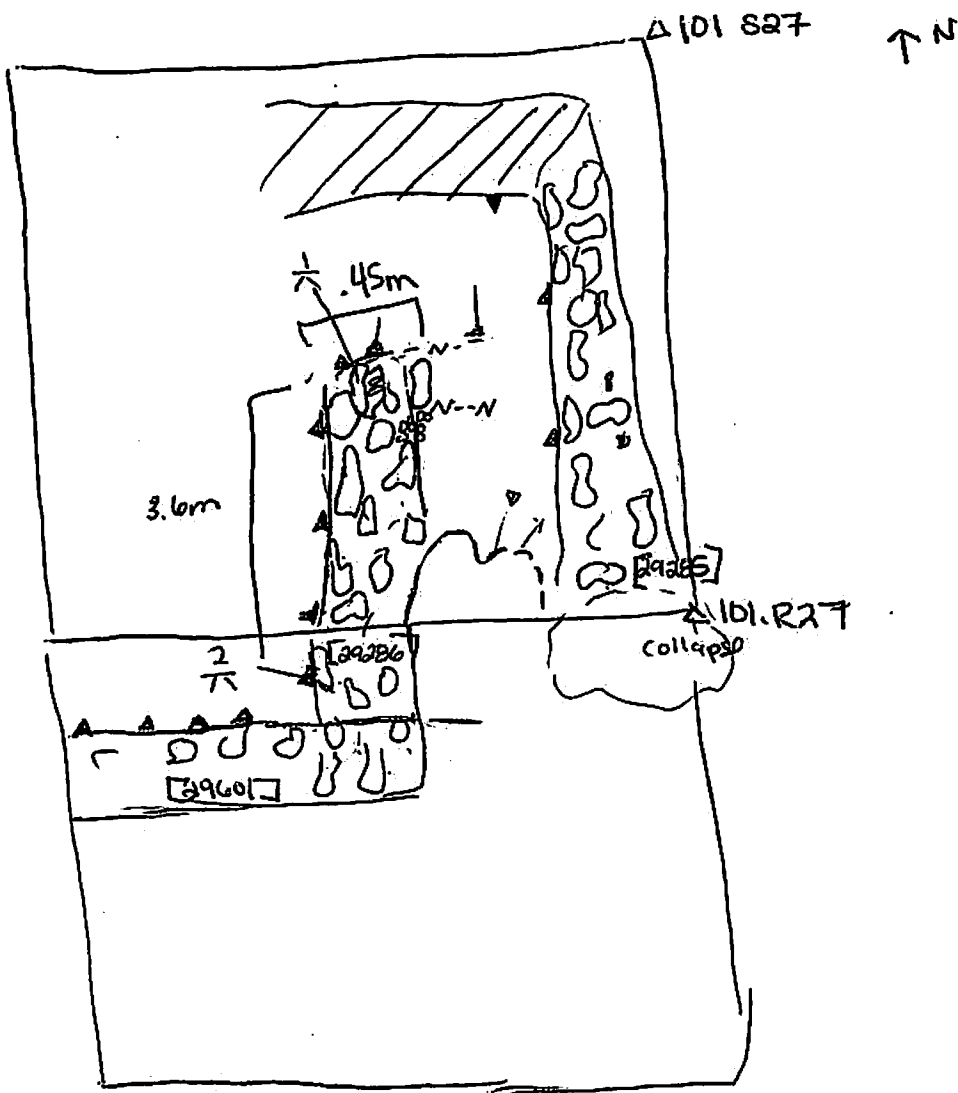

Elevations	14: 21.41
TBM: 18.54	
BS: 2.87	RL
FS: 1	18.24
2	18.21