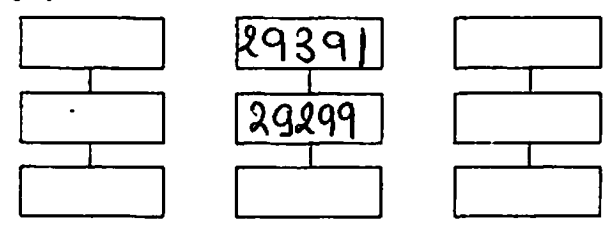

<b>GPMP 2008</b>	GRID SQUARE(S) 101- U 28 / U 29.	ARCHITECTURE	CONTEXT 29299
1. Material	1. Mudbrick		
2. Size of materials	2/		
3. Finish	3/ N/A		
4. Coursing/bond	4/ N/A		
5. Form	5/ WALL		
6. Direction of faces	6. N/S.		
7. Orientation	7/ E-W.		
8. Dimensions	8/ 0,74 m length and 0,70 m wide (before Excavation)		
9. Associated collapse	After Excavation: 1,86 m length and 0,66 m wide.		
10. Foundations cuts & fills	10/ N/A		
11. Repaired	11/ N/A		
12. Associated floors	12/ N/A		
13. Plastered	13/ N/A		
14. Wall core	14/ Sandy mud brick		
15. Types of brick (%)	15/ About 80% mud and 20% sand.		
16. Composition of bricks	16/ 39 x 20 cm ; 42 x 18 cm ; 40 x 18 cm		
17. Dimensions of bricks (sample of three)			

Stratigraphic Matrix	Abuts 21876; 21887	Above
	Abutted by	Below
	Bonded into	
	Contiguous with	

INTERPRETATION	Enclosing	<u>Internal</u>	External
Reason for decay	Mudbrick wall abuts to [21876]		
Indications of original dimensions	According S. Hassan Plan's, this wall continues		
Indications of original functions	to the East and join to the wall [21887]		
But it is covered by the layer 29391. After we have taken off this layer it appears that the wall continues to the wall [21887].			

Associated contexts: 21876, 21887, 29391-

Context Same As:  
Drawing Nos: 2008.39- , 29299-

Photographs (Digital)	Finds		Samples
	Bag No.	Type	
S10848 to S10852			Building Complex
S10980 - S10981			
S10982 - S10983			
			Phase
	Site Book Pages	Checked	Initials JED Date 22-III-08

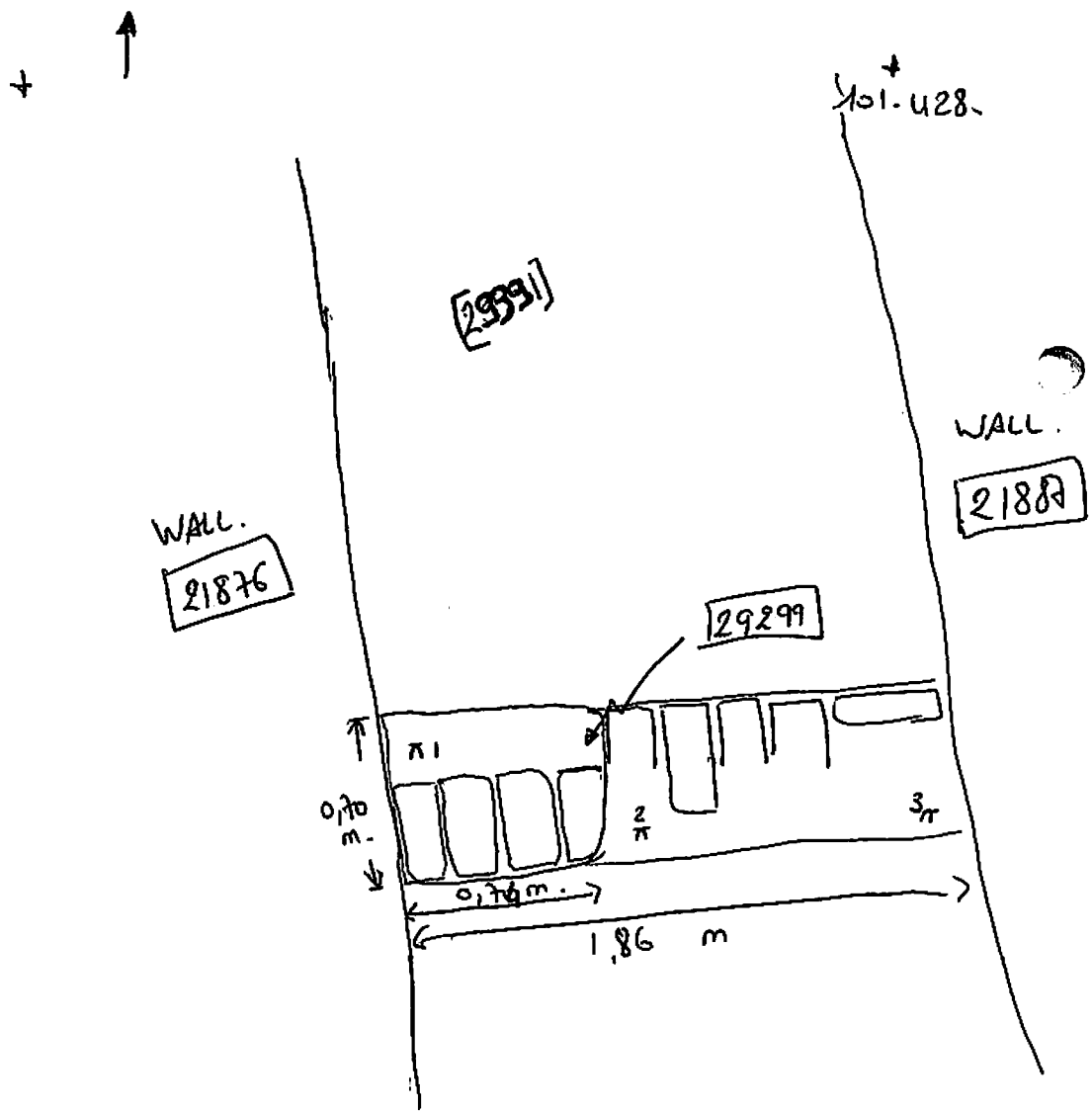

$\pi 1$	18,32
$\pi 2$	18,20
$\pi 1$	18,15-