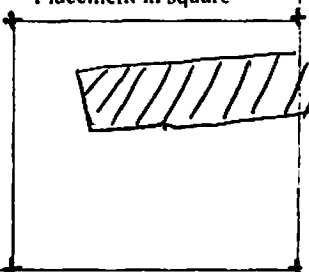

GIZA PLATEAU MAPPING PROJECT

Grid Square(s) 101-129-130	Area KKT	Context Type Proposed Fill.	Central Coords	Context 29430	
DEPOSIT				CUT	
<ol style="list-style-type: none"> 1. Compaction 2. Colour 3. Composition/Particle Size (Over 10%) 4. Inclusions (Under 10%) occa / mod / freq 5. Thickness and extent 6. Top and bottom boundaries 7. Other comments 8. Method and conditions 		<ol style="list-style-type: none"> 1) Loose 2) greyish - light brownish. 3) silt with some small patches of yellowish plaster 4) occa. pebbles (1-10 cm), freq. fragments of ceramics, patches of plaster 5) extent: at least: 4.70 m length and 1.32 m wide. 6) Top boundary: diffuse to clear 		<ol style="list-style-type: none"> 1. Shape in plan 2. Corners 3. Dimension/Depth 4. Break of slope-top 5. Sides 6. Break of slope-base 7. Base 8. Orientation 9. Inclination of axis 10. Truncated (if known) 11. Fill #s 12. Other comments 	
Not Excavated.					
Type of feature: Stratigraphic Matrix					
<div style="display: flex; justify-content: space-around; align-items: center;"> <div style="border: 1px solid black; width: 20px; height: 20px; margin: 2px;"></div> <div style="border: 1px solid black; width: 20px; height: 20px; margin: 2px;"></div> <div style="border: 1px solid black; width: 20px; height: 20px; margin: 2px;"></div> <div style="border: 1px solid black; width: 20px; height: 20px; margin: 2px;"></div> <div style="border: 1px solid black; width: 20px; height: 20px; margin: 2px;"></div> <div style="border: 1px solid black; width: 20px; height: 20px; margin: 2px;"></div> <div style="border: 1px solid black; width: 20px; height: 20px; margin: 2px;"></div> <div style="border: 1px solid black; width: 20px; height: 20px; margin: 2px;"></div> <div style="border: 1px solid black; width: 20px; height: 20px; margin: 2px;"></div> <div style="border: 1px solid black; width: 20px; height: 20px; margin: 2px;"></div> <div style="border: 1px solid black; width: 20px; height: 20px; margin: 2px;"></div> </div> <p style="text-align: center;">This context is 29430</p> <div style="display: flex; justify-content: space-around; align-items: center;"> <div style="border: 1px solid black; width: 20px; height: 20px; margin: 2px;"></div> <div style="border: 1px solid black; width: 20px; height: 20px; margin: 2px;"></div> <div style="border: 1px solid black; width: 20px; height: 20px; margin: 2px;"></div> <div style="border: 1px solid black; width: 20px; height: 20px; margin: 2px;">29433</div> <div style="border: 1px solid black; width: 20px; height: 20px; margin: 2px;">29440</div> <div style="border: 1px solid black; width: 20px; height: 20px; margin: 2px;">21921</div> <div style="border: 1px solid black; width: 20px; height: 20px; margin: 2px;"></div> <div style="border: 1px solid black; width: 20px; height: 20px; margin: 2px;"></div> <div style="border: 1px solid black; width: 20px; height: 20px; margin: 2px;"></div> <div style="border: 1px solid black; width: 20px; height: 20px; margin: 2px;"></div> <div style="border: 1px solid black; width: 20px; height: 20px; margin: 2px;"></div> </div>					
Your interpretation:		Internal	External	Structural	Other (specify)
Your discussion:					
<p>Silty layer between wall [21923] to the North, [29429] to the West and [29432] and [21921] to the South.</p> <p>It seems that this layer is late: maybe a phase of abandon probably post-excavations of S. Hassan (?).</p>					
				Placement in square	
					
Context same as:		See contexts:			
Site Book Refs:		Matrix phase:		Initials and date DEJ 31-iii-08	
Checked Interpretation:					
Provisional period		Group/Phase		Initials and date	

Context Number 29430 GPMP 2008

Bag Numbers

Ceramics	Objects

Environmental Samples & Type	Exotics

Charcoal	Other

Bones	

Lithics	

Photographs
S10920 to S10924

Drawings

Plans 2008-38	Sections

Top Elevation 18,05.	Bottom Elevations
----------------------	-------------------

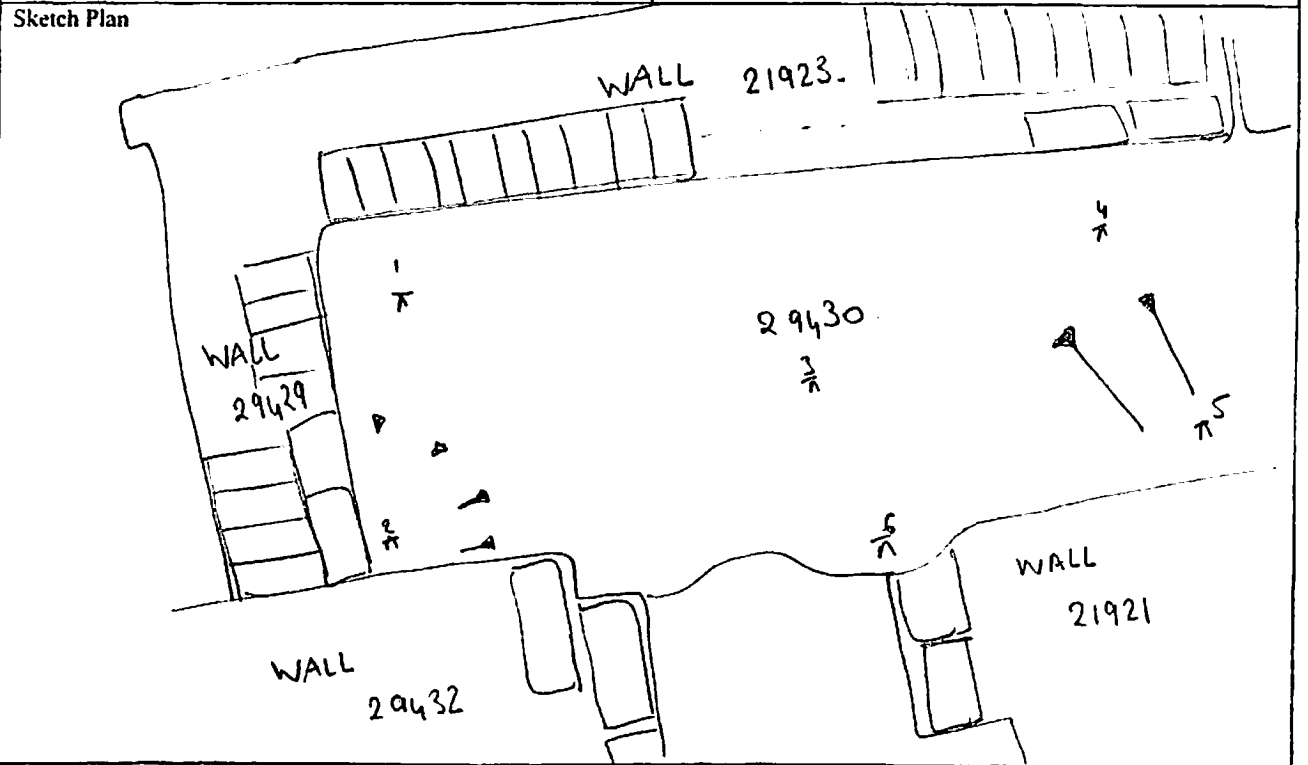

BM: 18,54 BS: 1,63 EH: 20,17

π1	2,12	18,05
π2	2,22	17,95
π3	2,16	18,01

π4	2,16	18,01
π5	2,23	17,94
π6	2,20	17,97.