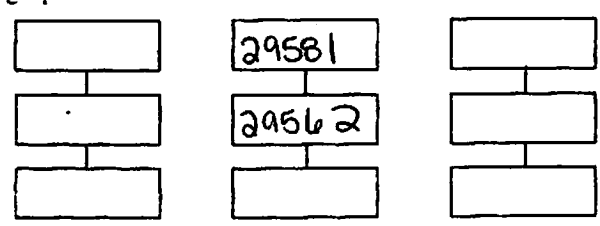

<b>GPMP 2008</b>	GRID SQUARE(S) 101.529	<b>ARCHITECTURE</b>	CONTEXT 29562
------------------	---------------------------	---------------------	------------------

1. Material	(1) MUD-BRICK (SLIP)
2. Size of materials	(2) 300mm x 180mm / 300mm x 180mm / 230mm x 180mm
3. Finish	(3)
4. Coursing/bond	(4) IRREGULAR CROSS AS FOR TOP LAYER PARTIALLY BOND, BRICKS 2 LAYERS
5. Form	BONDED W/ FINE GREY SLIP SAND.
6. Direction of faces	(5) N-S WALL
7. Orientation	(6) S. FACING + W. FACING
8. Dimensions	(7) N-S. (8) N-S. = 3.10m (approx.)
9. Associated collapse	E-W = 0.85m
10. Founds, cuts & fills	(9) - (10) (11)
11. Repaired	(12) # (29560) TO E.
12. Associated floors	(13) E FACE PLASTERED W/
13. Plastered	(14)
14. Wall core	(15) see above
15. Types of brick (%)	(16)
16. Composition of bricks	
17. Dimensions of bricks (sample of three)	

Stratigraphic Matrix	Abuts	Above
	Abutted by	Below
	2955 - 29563?	
	+ 21922.	
	Bonded into	
	Contiguous with	

<b>INTERPRETATION</b>	Enclosing	<u>Internal</u>	External
Reason for decay	N-S mudbrick wall		
Indications of original dimensions	Wall very eroded in the N. part (mudbrick debris still visible but impossible to see the courses.)		
Indications of original functions			

Associated contexts: 29581

Context Same As:  
Drawing Nos: 2008-3 ; 2008-38.

Photographs (Digital)	Finds		Samples
	Bag No.	Type	
510865			Building Complex
510866			
			Phase
			Checked
		Site Book Pages	Initials Date

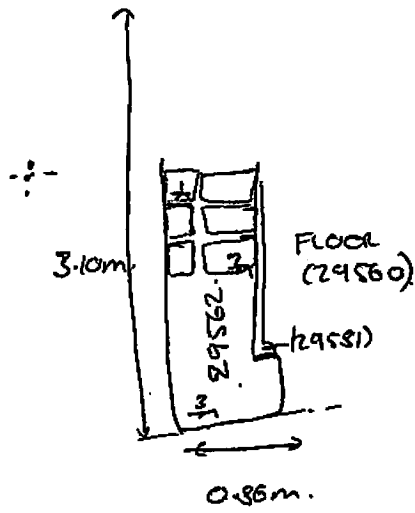

sq.



Area	Area
1	17.95
2	17.91
3	17.87