

<b>GPMP 2008</b>	<b>GRID SQUARE(S)</b> 10.529 - 528.	<b>ARCHITECTURE</b>	<b>CONTEXT</b> 29563
1. Material	① MUD-BRICK.		
2. Size of materials	② / ⑦ 380mm x 200mm / 260mm x 160mm / 180mm x 150mm		
3. Finish	③ -		
4. Coursing/bond	④ STRETCHERS COURSE w/ HEADERS TO ⑤?		
5. Form	BONDED w/ FINE GREY SANDY SILT		
6. Direction of faces	⑤ E-W WALL.		
7. Orientation	⑥ N + S FACING ⑦ E-W.		
8. Dimensions	⑧ E-W (L) = approx 7.70m. N-S (W) = 1.10m.		
9. Associated collapse	⑨ - ⑩		
10. Foundations & fills	⑪ -		
11. Repaired	⑫ - ⑬ -		
12. Associated floors	⑭ MED SANDS + SILT w/ SM FRAGS CONSISTENT CRUSH.		
13. Plastered	⑮ ALL SILY / GRAY MUD.		
14. Wall core	⑯		
15. Types of brick (%)			
16. Composition of bricks			
17. Dimensions of bricks (sample of three)			

<b>Stratigraphic Matrix</b>	Abuts 21870	Above
	Abutted by	Below
	Bonded into	
	Contiguous with	

INTERPRETATION	Enclosing	Internal	External
Reason for decay	E-W mudbrick wall <del>fragment</del>		
Indications of original dimensions	ABUTTING LARGE N-S WALL (21876) TO W		
Indications of original functions	+ ROSS ORIGINALLY ABUTTED (29562) TO E		
BUT NOW ERODED.			
TRUNCATED TO W - ROSS ROBBING - BRICKS 1/2 SECTORED			

Associated contexts:

Context Same As:  
Drawing Nos: 2008.3

Photographs (Digital)	Finds		Samples
	Bag No.	Type	
510845			Building Complex
510840			
510866			
			Phase
		Site Book Pages	Checked
			Initials Date

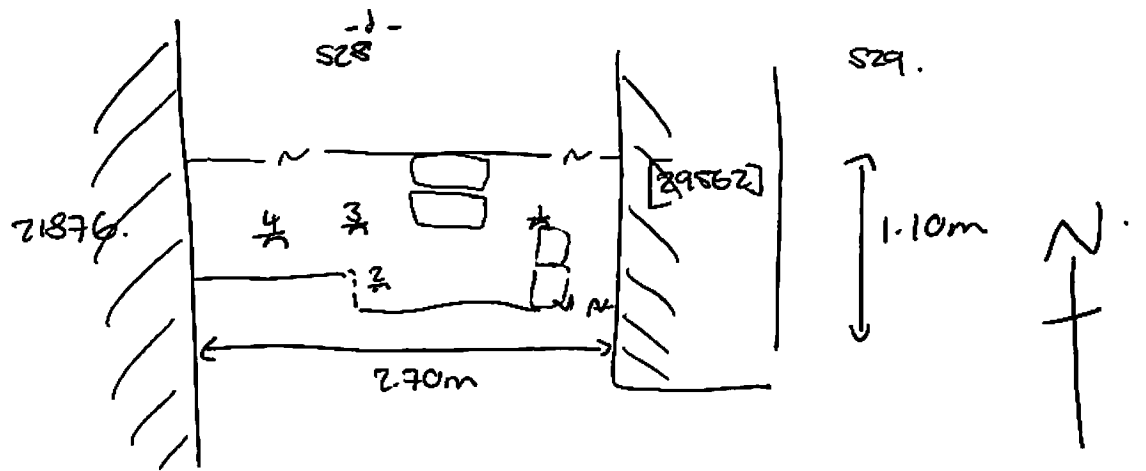

+

Point	RL
1	17.91
2	17.86
3	17.84
4	17.91