

<b>GPMP 2008</b>	GRID SQUARE(S) 101-0-227	ARCHITECTURE	CONTEXT 29602
1. Material	① LIMESTONE Boulders <sup>(A)</sup> + RED GRANITE <sup>(B)</sup>		
2. Size of materials	② (A) = 360mm x 120mm x 160mm (MAX) 70mm x 70mm (MIN)		
3. Finish	③ = 220mm x 160mm (MAX) 150mm x 55mm (MIN)		
4. Coursing/bond	④ ONLY 2 RAUGH LAYERS REMAIN. APPEAR RANDOM, UNCOURSED.		
5. Form	BONDED w/ SLTY COARSE SAND w/LS FLECKS, OCCAS. MUDR LENSES + SM POT FRAGR.		
6. Direction of faces	⑤ WALL. ⑥ E+W. ⑦ N-S		
7. Orientation	⑧ N-S = 1.78m E-W = 0.48m DEPTH = 0.40m		
8. Dimensions	⑨ - ⑩ - ⑪ - ⑫ SURFACES (29881) TO W + (29982) TO E.		
9. Associated collapse	⑬ - ⑭ - ⑮ (95% LS < 5% RED GRANITE)		
10. Founds. cuts & fills	⑯ - ⑰ -		
11. Repaired			
12. Associated floors			
13. Plastered			
14. Wall core			
15. Types of brick (%)			
16. Composition of bricks			
17. Dimensions of bricks (sample of three)			

MIN

Stratigraphic Matrix	Abuts	Above
	Abutted by	Below
	29607.	
	Bonded into	
	Contiguous with	

INTERPRETATION	Enclosing	<u>Internal</u>	External
Reason for decay	N-S FIELDSTONE WALL WITHIN 'HOUSE', DEMOLISHED		
Indications of original dimensions	ROOM 186 TO W + POSS SMALLER CHAMBER		
Indications of original functions	P NE. ABUTTED BY MB WALLS 29607		
	TRUNCATED N S BY [299643].		

Associated contexts:

Context Same As:

Drawing Nos: 2008-16 2008-13.

Photographs (Digital)	Finds		Samples
	Bag No.	Type	
51940			
161540-161542			Building Complex
			Phase
	Site Book Pages	Checked	Initials Date

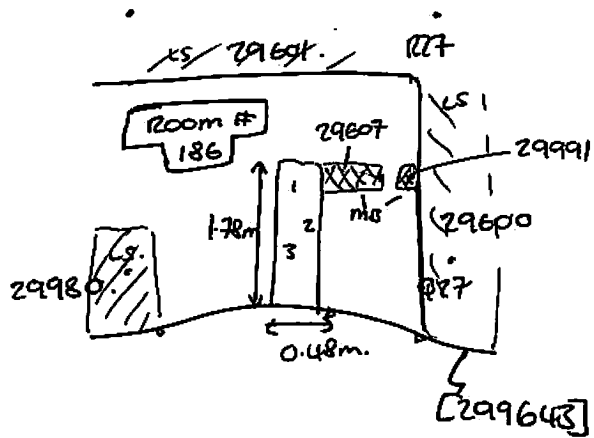

π	RL
1	18.22
2	18.19
3	18.04.