

GPMP 2008	GRID SQUARE(S) 101 R27	ARCHITECTURE	CONTEXT 29607 29607
1. Material	① ② = SILT + ③ = MARL MLD-BLOCKS		
2. Size of materials	② -		
3. Finish	② SQUARED.		
4. Coursing/bond	④ ROUNDED w/ FINE SILTY SAND		
5. Form	APPROX 5 COURSES USABLE (MIX OF HEADERS + STRETCHERS) DEPTH x 2 COURSES WIDE.		
6. Direction of faces	⑤ INTERNAL WALL		
7. Orientation	⑥ N-T-S ⑦ E-W ⑧ 1.51m (E-W) x 0.78m (N-S)		
8. Dimensions	x 0.46m (MAX DEPTH)		
9. Associated collapse	⑨ - ⑩ - ⑪ -		
10. Founds, cuts & fills	⑫ (29982)		
11. Repaired	⑬ - ⑭ - ⑮ 95% SILT 5% MARL.		
12. Associated floors	⑯		
13. Plastered	⑰ ⑱ = 260mm x 120mm x 90mm (d) ? x 110mm x 65mm (d)		
14. Wall core	⑲ ? x 740mm x 70mm ? x 110mm x 70mm		
15. Types of brick (%)			
16. Composition of bricks			
17. Dimensions of bricks (sample of three)			

Stratigraphic Matrix	<input type="checkbox"/>	<input type="checkbox"/>	<input type="checkbox"/>	Abuts	Above
	<input type="checkbox"/>	<input type="checkbox"/>	<input type="checkbox"/>	Abuted by	Below
	<input type="checkbox"/>	<input type="checkbox"/>	<input type="checkbox"/>	Bonded into	
	<input type="checkbox"/>	<input type="checkbox"/>	<input type="checkbox"/>	Contiguous with	

INTERPRETATION	Enclosing	<u>Internal</u>	External
Reason for decay	INTERNAL DIPPING MB WALL BEHINDING BRUN		
Indications of original dimensions	N-S LS WALLS (29600) E-W + (296027) TOW		
Indications of original functions	DOES TO DIVIDE INTERNAL SPACE WITHIN		
HOUSE - POSS DOORWAY TO E OR BELONGS TRUNCATED			

Associated contexts:

Context Same As:

Drawing Nos: 2008 - 13.

Photographs (Digital)	Finds		Samples
	Bag No.	Type	
101540-42.			Building Complex
			Phase
	Site Book Pages	Checked	Initials Date

1207

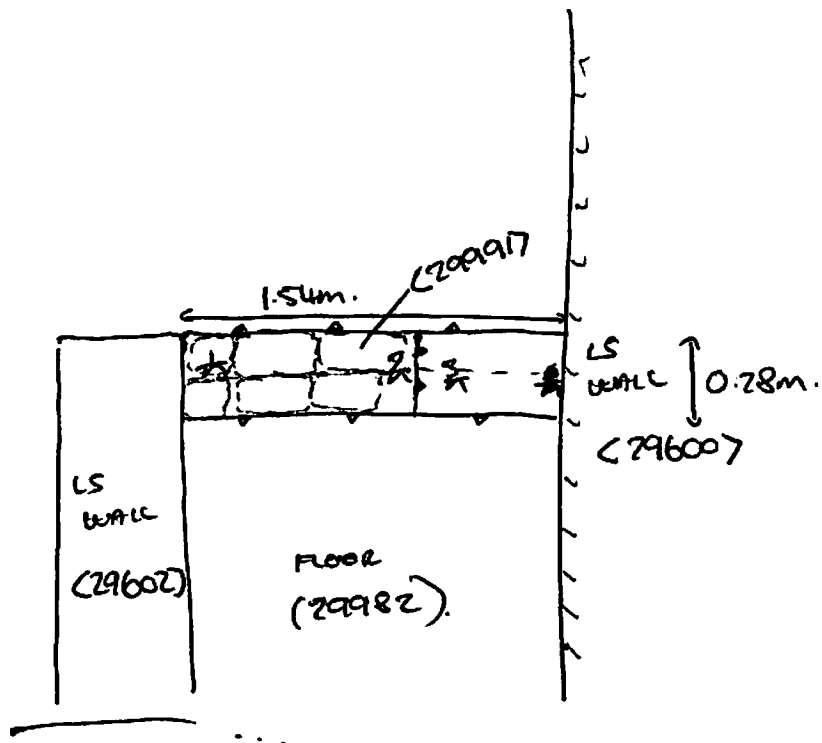

TT	RL
1	18.31
2	18.32
3	18.00

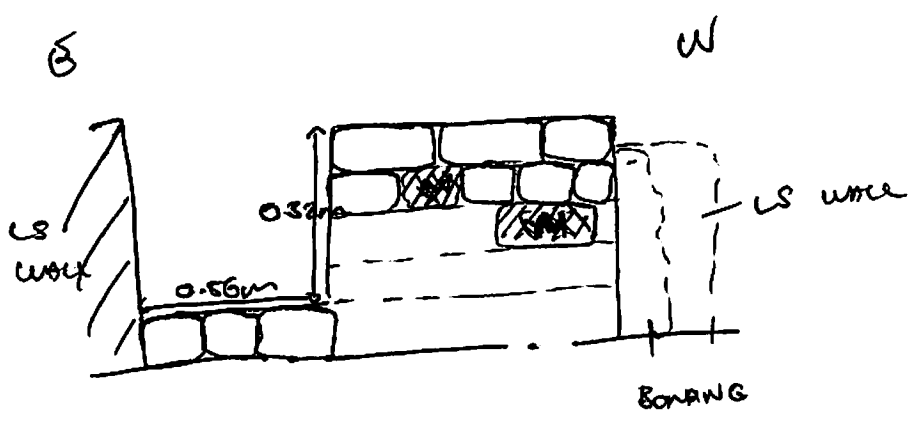

N. FACING SKETCH PROFILE.