

GPMP GIZA

Site: <b>SAPS 2/LFM</b> Area: <b>KKT-N.</b>	GRID SQUARE(S) <b>201-D22</b>	ARCHITECTURE	FEATURE <b>34367</b>								
1. Material	1) <b>UNKNOWN</b>										
2. Size of materials	2) <b>"</b>										
3. Finish	3) <b>"</b>										
4. Coursing/bond	4) <b>"</b>										
5. Form	5) <b>WALL CORE</b>										
6. Direction of faces	6) <b>N/A</b>										
7. Orientation	7) <b>NE/SW</b>										
8. Dimensions	8) <b>1.41m (L) X 0.67m (W)</b>										
9. Associated collapse	9) <b>UNKNOWN</b>										
10. Finds, cuts & fills	10) <b>CUT [34368]</b>										
11. Repaired	11) <b>UNKNOWN</b>										
12. Associated floors	12) <b>"</b>										
13. Plastered	13) <b>N/A</b>										
14. Wall core	14) <b>"</b>										
15. Types of brick (%)	15) <b>UNKNOWN</b>										
16. Composition of bricks	16) <b>"</b>										
17. Dimensions of bricks (sample of three)	17) <b>"</b>										
Stratigraphic Matrix	<table border="1"> <tr><td></td><td></td><td></td></tr> <tr><td></td><td><b>34367</b></td><td></td></tr> <tr><td></td><td></td><td></td></tr> </table>					<b>34367</b>					Abuts Above Abutted by Below Bonded into Contiguous with
	<b>34367</b>										
INTERPRETATION	Enclosing	<u>Internal</u>	External								
Reason for decay	<b>NOT EXCAVATED - NUMBER ASSIGNED DURING</b>										
Indications of original dimensions	<b>DATA CURATION PROJECT.</b>										
Indications of original functions											
<b>CORE OF REPAIR WALL (31106)</b>											
<b>SPACE: 11571, 10953</b>											
<b>STRUCTURE: 15255</b>											
Associated contexts: <b>(31106), [34368]</b>											
Context Same As:											
Drawing Nos: <b>2009-91</b>											
<b>Photographs</b> (feature in plan, elevation, materials used, surface treatment e.g. plaster, paint etc.)	<b>Finds</b>		<b>Samples</b> (flotation, wet sieve, materials used e.g. bricks, stone, wood, bonding material etc.)								
Photograph No. Description	Description	Artefact no.	Sample No. Description								
	Phase:	Checked	Initials <b>DCS</b> Date <b>23 APRIL 2013</b>								

34367

Sketch Drawings (in plan and in profile)

Remember: do not just draw the architectural feature in isolation. Show how it relates to surrounding features and include details of surface treatments, repairs/modifications/damage, bonding material(s), and associated cuts. Annotate all aspects of the feature or use a Drawing Key. Measurements must be included for all aspects of the feature and surrounding features.

Sketch Plan - Include grid co-ordinates, North arrow, and elevations.

NOT TO SCALE

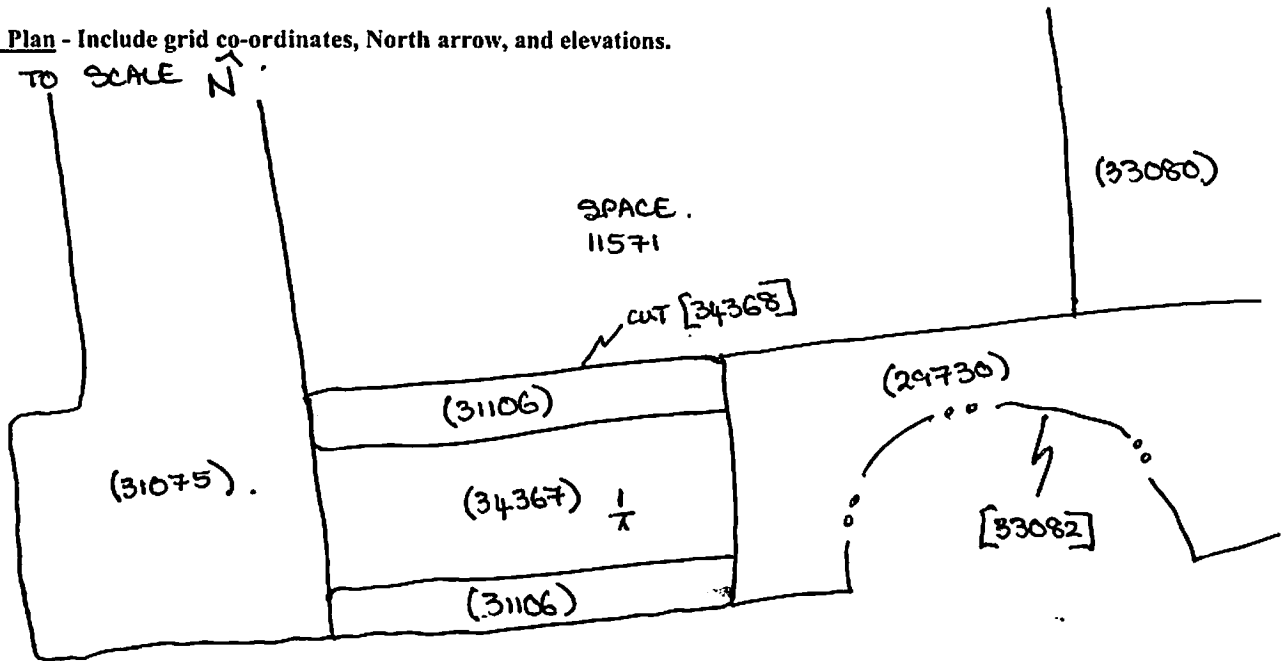

CAUSEWAY SPACE

10953 . 201-  
D22 - 1

Profile Sketch

- State direction the elevation of the feature being drawn is facing e.g. 'West Facing Elevation of Feature ....
- If feature was drawn in section then include the grid co-ordinates and elevations.

TBM: 23.23

BS: 1.76

IH: 24.99

FS            RL

1/2 2.49        22.50 .