

GPMP GIZA

Site: SAPS 2 / LTM Area: KKT-N		GRID SQUARE(S) 201-D22	ARCHITECTURE	FEATURE 34375			
1. Material	1) MIXED - LIMESTONE FRAGS DRAWN						
2. Size of materials	2) 0.17m (L) X 0.10m (W) OF LARGEST PIECE ON PLAN						
3. Finish	3) IRREGULAR						
4. Coursing/bond	4) "						
5. Form	5) WALL CORE						
6. Direction of faces	6) N/A						
7. Orientation	7) NW/SE & NE/SW						
8. Dimensions	8) 3.96m (L) X 0.21m (W)						
9. Associated collapse	9) UNKNOWN						
10. Finds, cuts & fills	10) CUT [34376] [31172]						
11. Repaired	11) UNKNOWN						
12. Associated floors	12) N/A						
13. Plastered	13) "						
14. Wall core	14) "						
15. Types of brick (%)	15) UNKNOWN						
16. Composition of bricks	16) "						
17. Dimensions of bricks (sample of three)	17) "						
Stratigraphic Matrix		Abuts Above					
		Abutted by Below					
		Bonded into					
		Contiguous with					
INTERPRETATION		Enclosing <u>Internal</u> External					
Reason for decay		*** EXCAVATED - NUMBER ASSIGNED DURING DATA					
Indications of original dimensions		CURATION PROJECT					
Indications of original functions		DRAWN BUT NOT NUMBERED. MUST HAVE BEEN					
TAKEN OUT AS PART OF THE REPAIR WALL.							
CORE OF REPAIR WALL (31105), (34372), (34373), (34374)							
SPACE: 11574, 11573, 10953, 11571							
STRUCTURE: 15112, 15255							
Associated contexts:							
Context Same As:							
Drawing Nos: 2009-31105, 2009-91.							
Photographs (feature in plan, elevation, materials used, surface treatment e.g. plaster, paint etc.)		Finds		Samples (flotation, wet sieve, materials used e.g. bricks, stone, wood, bonding material etc.)			
Photograph No.	Description	Description	Artefact no.	Sample No. Description			
		Phase:	Checked	Initials DCJ Date 24 APRIL 2013			

34375

Sketch Drawings (in plan and in profile)

Remember: do not just draw the architectural feature in isolation. Show how it relates to surrounding features and include details of surface treatments, repairs/modifications/damage, bonding material(s), and associated cuts. Annotate all aspects of the feature or use a Drawing Key. Measurements must be included for all aspects of the feature and surrounding features.

Sketch Plan - Include grid co-ordinates, North arrow, and elevations.

NOT TO SCALE \uparrow N

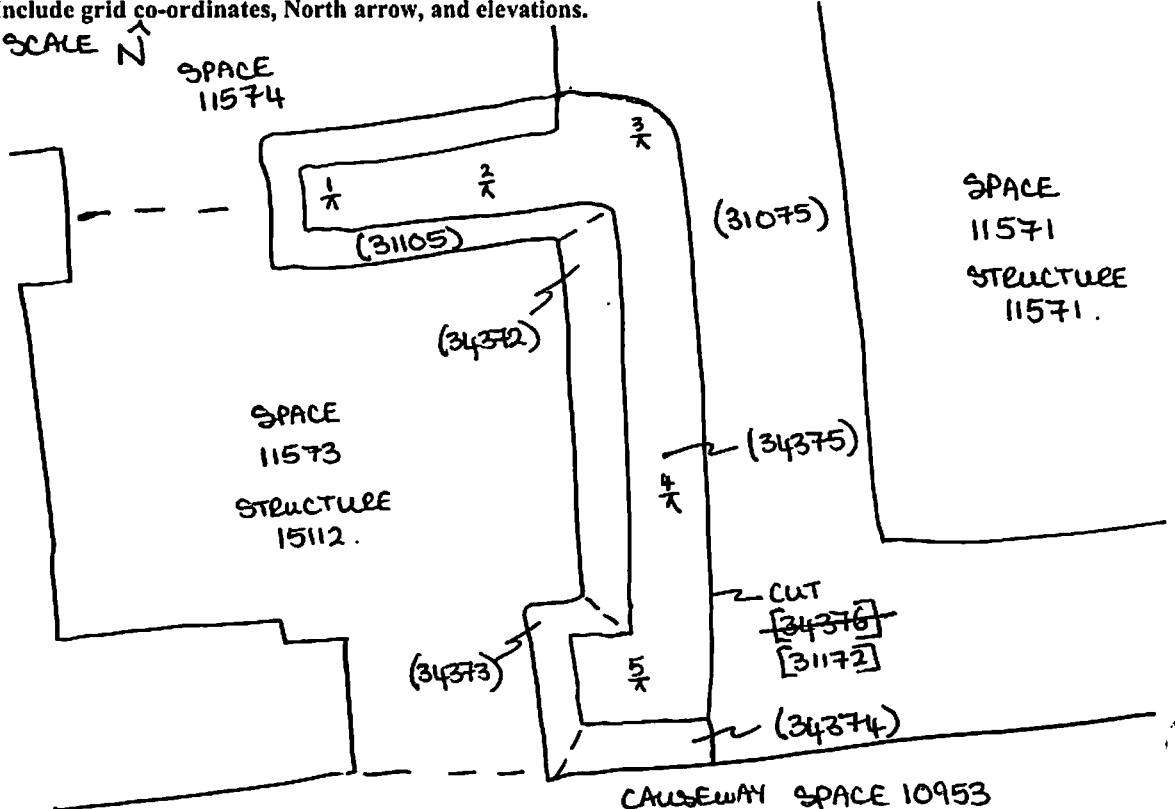

Profile Sketch

- State direction the elevation of the feature being drawn is facing e.g. 'West Facing Elevation of Feature ...'
- If feature was drawn in section then include the grid co-ordinates and elevations.

1 201-D22 .
- 0 -
1

TEM: 23.23
BB: 1.41
IH: 24.64

FS	EL
1/π	22.91
2/π	22.89
3/π	22.89
4/π	22.74
5/π	22.64