

GPMP GIZA

Site: SAFS 2/LFM Area: KKT-N		GRID SQUARE(S) 201-D21	ARCHITECTURE	FEATURE 34378
1. Material		1) UNKNOWN		
2. Size of materials		2) "		
3. Finish		3) "		
4. Coursing/bond		4) "		
5. Form		5) WALL CORE		
6. Direction of faces		6) N/A		
7. Orientation		7) NW/SE		
8. Dimensions		8) 0.82m (L) x 0.14m (W)		
9. Associated collapse		9) UNKNOWN		
10. Finds, cuts & fills		10) "		
11. Repaired		11) "		
12. Associated floors		12) "		
13. Plastered		13) N/A		
14. Wall core		14) N/A		
15. Types of brick (%)		15) UNKNOWN		
16. Composition of bricks		16) "		
17. Dimensions of bricks (sample of three)		17) "		
Stratigraphic Matrix		Abuts Above Abutted by Below Bonded into Contiguous with		
INTERPRETATION		Enclosing (Internal) External		
Reason for decay		EXCAVATED IN 2009 AS PART OF REPAIR WALL		
Indications of original dimensions		(3114) ALTHOUGH IDENTIFIED AS A SEPARATE		
Indications of original functions		FEATURE. - SEE 2009-3114.		
CORE OF REPAIR WALL (3114)				
STRUCTURE: 1512.				
SPACE: 11574, 11580				
Associated contexts:				
Context Same As:				
Drawing Nos: 2009-3114				
Photographs (feature in plan, elevation, materials used, surface treatment e.g. plaster, paint etc.) Photograph No. Description		Finds Description Artefact no.		Samples (flotation, wet sieve, materials used e.g. bricks, stone, wood, bonding material etc.) Sample No. Description
/		/		/
		Phase:		Checked
				Initials DCS Date 25 APRIL 2013

34378

Sketch Drawings (in plan and in profile)

Remember: do not just draw the architectural feature in isolation. Show how it relates to surrounding features and include details of surface treatments, repairs/modifications/damage, bonding material(s), and associated cuts. Annotate all aspects of the feature or use a Drawing Key. Measurements must be included for all aspects of the feature and surrounding features.

Sketch Plan - Include grid co-ordinates, North arrow, and elevations.

NOT TO SCALE \uparrow

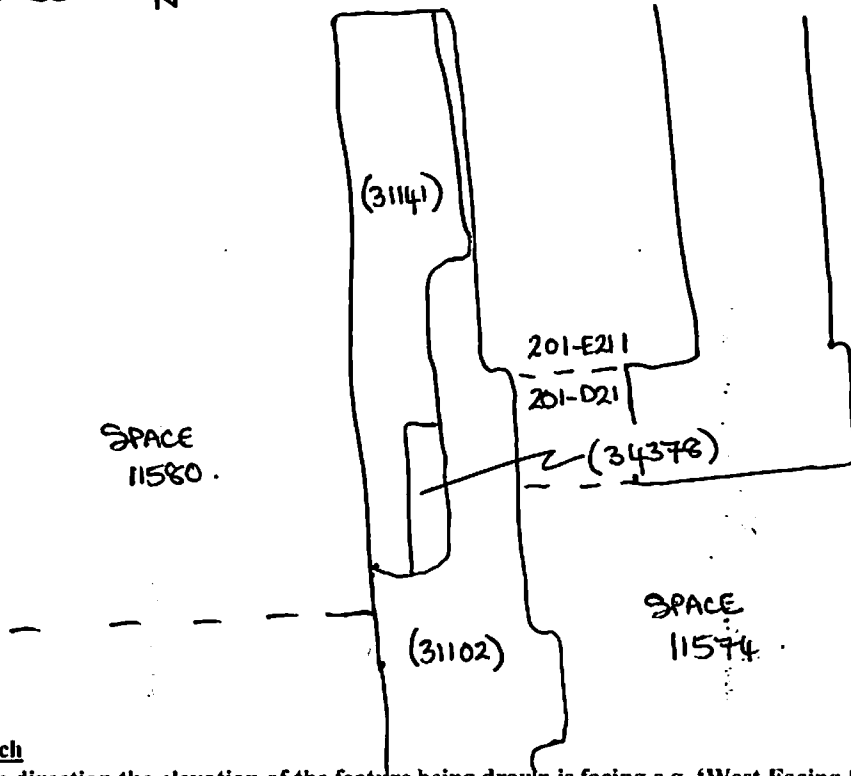

Profile Sketch

- State direction the elevation of the feature being drawn is facing e.g. 'West Facing Elevation of Feature
- If feature was drawn in section then include the grid co-ordinates and elevations.