

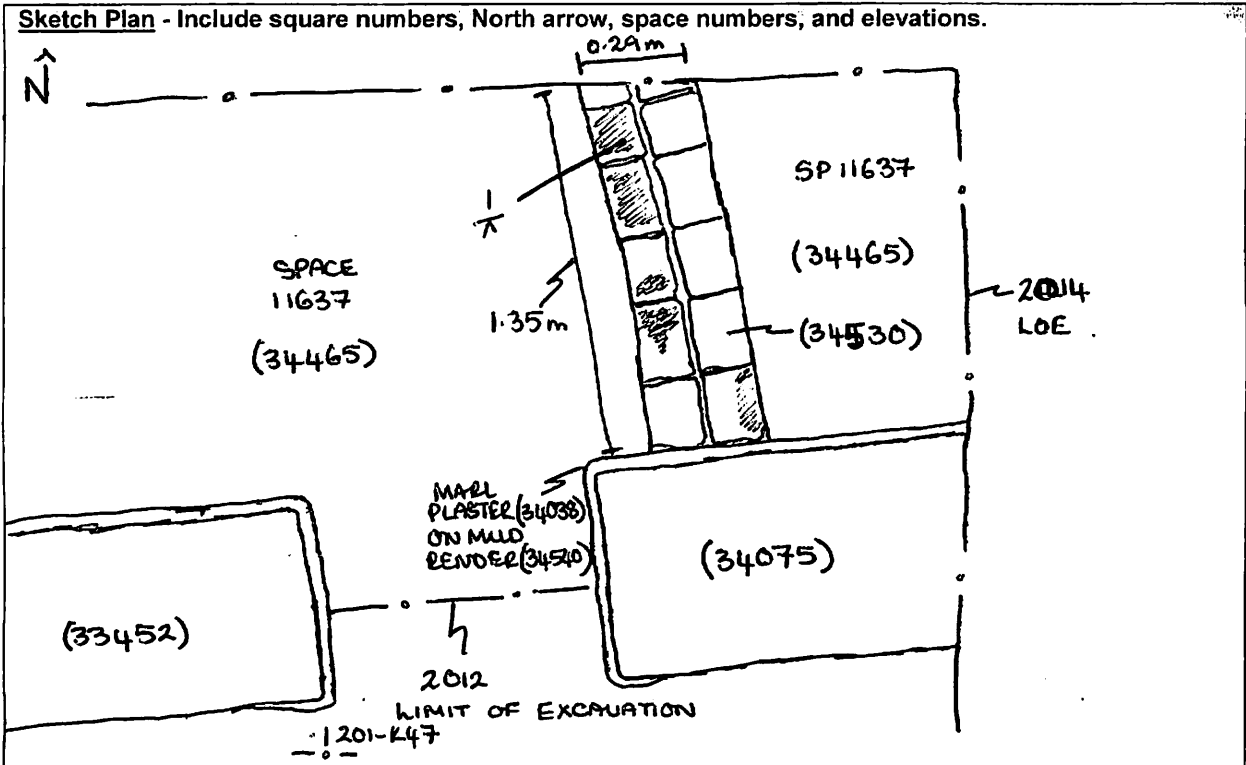

AREA: KKT-E+	GRID SQUARES: 201-K47	INITIALS & DATE: DLJ 02 APRIL 2014	FEATURE No.: 34530							
FEATURE TYPE (For example wall, staircase, bench, foundation structure, platform etc.): WALL		Full extent visible in plan: YES / <input checked="" type="radio"/> NO								
1. Dimensions (in metres)	Length: 1.35m	Width: 0.29m	Height: 0.13m							
2. Type of material(s) used	SANDY MUDBRICKS									
3. Coursing (form of construction)	TWO ROWS OF STRETCHERS									
4. Orientation	NW/SE									
5. Associated collapse	NO									
6. Cut & fill feature #'s	NOT USABLE									
7. Repaired?	" "									
8. Associated floors	" "									
9. Surface treatments? E.g. plaster, paint, mouldings	POSSIBLE REMAINS OF A MUD RENDER ON THE EAST & WEST FACING ELEVATIONS.									
10. Size of one component	0.27m(L) X 0.15m(W) HEIGHT UNKNOWN.									
11. Bonding material	THIN LAYER OF SILTY, ARMY SAND.									
12. Excavated	Yes <input checked="" type="radio"/> No									
Mini stratigraphic matrix <table border="1" style="width: 100%; text-align: center;"> <tr> <td style="width: 33%; height: 20px;"></td> <td style="width: 33%; height: 20px;"></td> <td style="width: 33%; height: 20px;"></td> </tr> <tr> <td></td> <td style="border: 1px solid black;">34530</td> <td></td> </tr> <tr> <td style="height: 20px;"></td> <td style="height: 20px;"></td> <td style="height: 20px;"></td> </tr> </table>					34530					Abuts: Same as:  Abutted by: Associated features:  Bonded into:  Contiguous with:
	34530									
Discussion and interpretation:  THIN DIVIDING WALL BETWEEN SPACE 11637 AND 11638. THE MAJORITY OF THE BRICKS ARE BURNT RED & BLACK. ONLY EXPOSED TO A MAX HEIGHT OF 0.13m TO THE WEST IN 2014.										

Remember: do not just draw the architectural feature in isolation. Show how it relates to surrounding features and include details of surface treatments, repairs/modifications/damage, bonding material(s), and associated cuts. Annotate all aspects of the feature or use a Drawing Key. Measurements must be included for all aspects of the feature and surrounding features.



Profile Sketch - State direction the elevation of the feature being drawn is facing e.g. 'West Facing Elevation of Feature .... If feature was drawn in section then include the grid co-ordinates and elevations.

ONLY USABLE IN PLAN IN 2014  
WHEN FIRST EXPOSED.

KEY  BURNING & SCORCHING.

TBM: 16.81.  
 BB: 0.90  
 IH: 17.71  
 FS            RL.  
 1/4 1.10      16.61.

Drawing No.'s: 2014-12	Photo No.'s: 815215
Space No.: 11637, 11638	Structure No.:
Matrix Group: 18227	Matrix Phase:
Samples taken:	Sondage No.: