

Grid Square(s) 201-146	Area KKT-ET	Feature Type deposit	Central Co-ords	Feature Number 34575
DEPOSIT				CUT
1. Compaction 2. Colour 3. Composition/Particle Size (Over 10%) 4. Inclusions (Under 10%) 5. Thickness and extent 6. Top and bottom boundaries 7. Other comments 8. Method and conditions		1: Loose 2: Dark 3: Ash 4: - 5: 1.30m E/W by 0.52m N-S 6: top is clear 7: Excavated - YES/NO 100% Excavated - YES/NO Feature fully visible in plan - YES/NO		1. Shape in plan 2. Corners 3. Dimension/Depth 4. Break of slope-top 5. Sides 6. Break of slope-base 7. Base 8. Orientation 9. Inclination of axis 10. Truncated (if known) 11. Fill #s 12. Other comments Draw profile overleaf
8:				

Type (refer to synoptic categories): Ash Rich

Stratigraphic Matrix

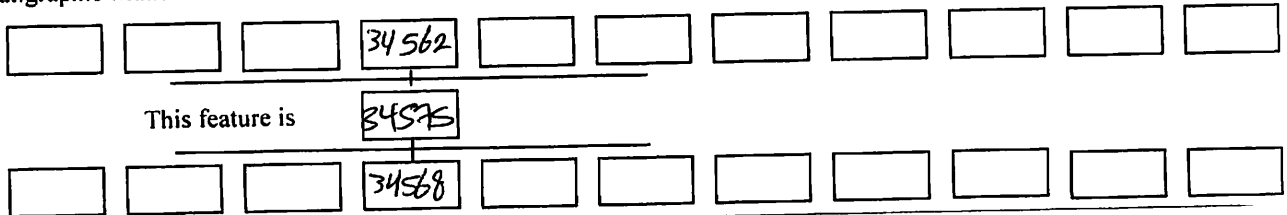

Your interpretation: Internal External Structural Other (specify)

Your discussion:  
 Dark ash rich deposit occupies a rectangular area located directly to the northern end of floor (34568) and to the southern face of a mud-brick enclosure wall (33262). It appears that if it is a fill of rectangular depression which were filled with bread molds while the baking process. It is similar to what has been discovered in Lake Rics EoG and  
 Volume of feature: 1991 at HGG  
 Not excavated during 2014

Placement in square:

Feature same as:	See features:
Space no.: 11640	Structure no.: —
Sondage no.: 183	Initials and date Rem HRK do-10-14

Checked Interpretation:			
Provisional period	Local Area Phase:	Site Meta-Phase:	Initials and date
	Group: 18220		

Feature Number **34575** AERA 2014  
 KRT. et sondage 183

Finds	
Ceramics	Objects
Environmental Samples & Type	Exotics
Charcoal	Lithics
Bone	Other

PHOTOGRAPHS  
 2011-815323 → 815331

DRAWINGS

Plans 2011-36	Sections
------------------	----------

Top Elevation: **15.48 m AL** Bottom Elevation: **15.42 m ASL**

Sketch Plan. Include: North arrow, grid square, levels, measurements, sondage no. (if applicable), space number, surrounding feature numbers. FOR CUTS INCLUDE A PROFILE SKETCH.

+Bm 16.81  
 Bs 2.05  
 Loc 18.86  
 F > RL  
 1 π 3.44 15.42  
 2 π 3.43 15.43

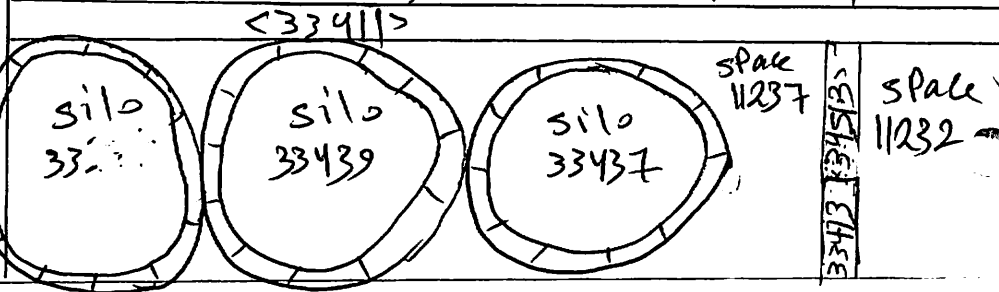
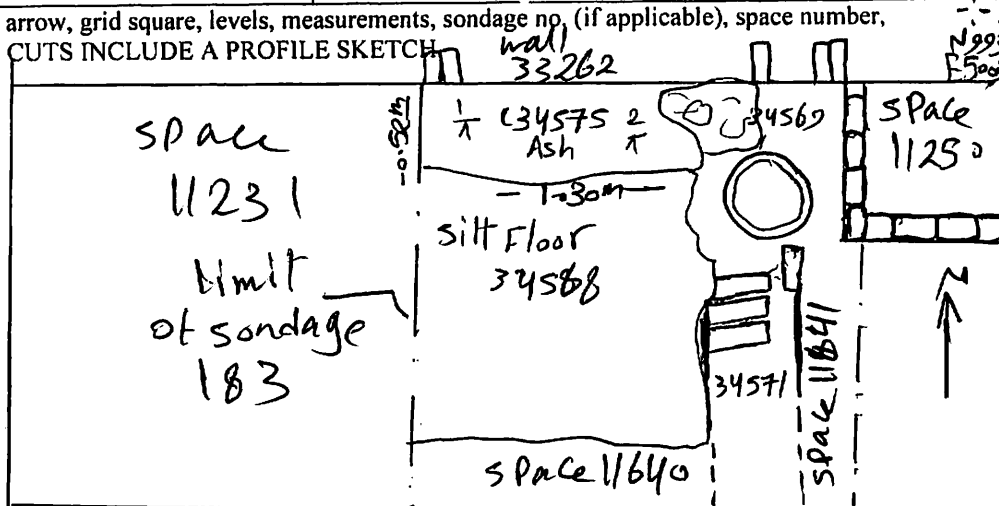

1-146  
 N99344.39  
 E50060.00