

AREA: KKT-E+		GRID SQUARES: 201-H47		INITIALS & DATE: DCJ 13 APRIL 2014		FEATURE No.: 34587	
FEATURE TYPE (For example wall, staircase, bench, foundation structure, platform etc.): TURNING STONE - DOOR SUPPORT				Full extent visible in plan: YES / <input checked="" type="radio"/> NO			
1. Dimensions (in metres)		Length: 0.29m	Width: 0.11m		Height: 0.06m.		
2. Type of material(s) used		ONE PIECE OF LIMESTONE					
3. Coursing (form of construction)		/					
4. Orientation		E/W					
5. Associated collapse		/					
6. Cut & fill feature #'s		UNKNOWN					
7. Repaired?		"					
8. Associated floors		(33854)					
9. Surface treatments? E.g. plaster, paint, mouldings		/					
10. Size of one component		/					
11. Bonding material		/					
12. Excavated		Yes <input checked="" type="radio"/> No					
Mini stratigraphic matrix			Abuts: Same as:				
			Abutted by: Associated features:				
			Bonded into:				
			Contiguous with: (33857)				
Discussion and interpretation:							
<p>CURVED PIECE OF LIMESTONE ON THE SOUTHERN SIDE OF RED GRANITE DOOR SOCKET (33857).</p> <p>UPPER SURFACE HAS INGRAINED CURVED STRIATIONS FROM USE.</p> <p>FUNCTIONED WITH RED GRANITE DOOR SOCKET (33857)</p>							

Remember: do not just draw the architectural feature in isolation. Show how it relates to surrounding features and include details of surface treatments, repairs/modifications/damage, bonding material(s), and associated cuts. Annotate all aspects of the feature or use a Drawing Key. Measurements must be included for all aspects of the feature and surrounding features.

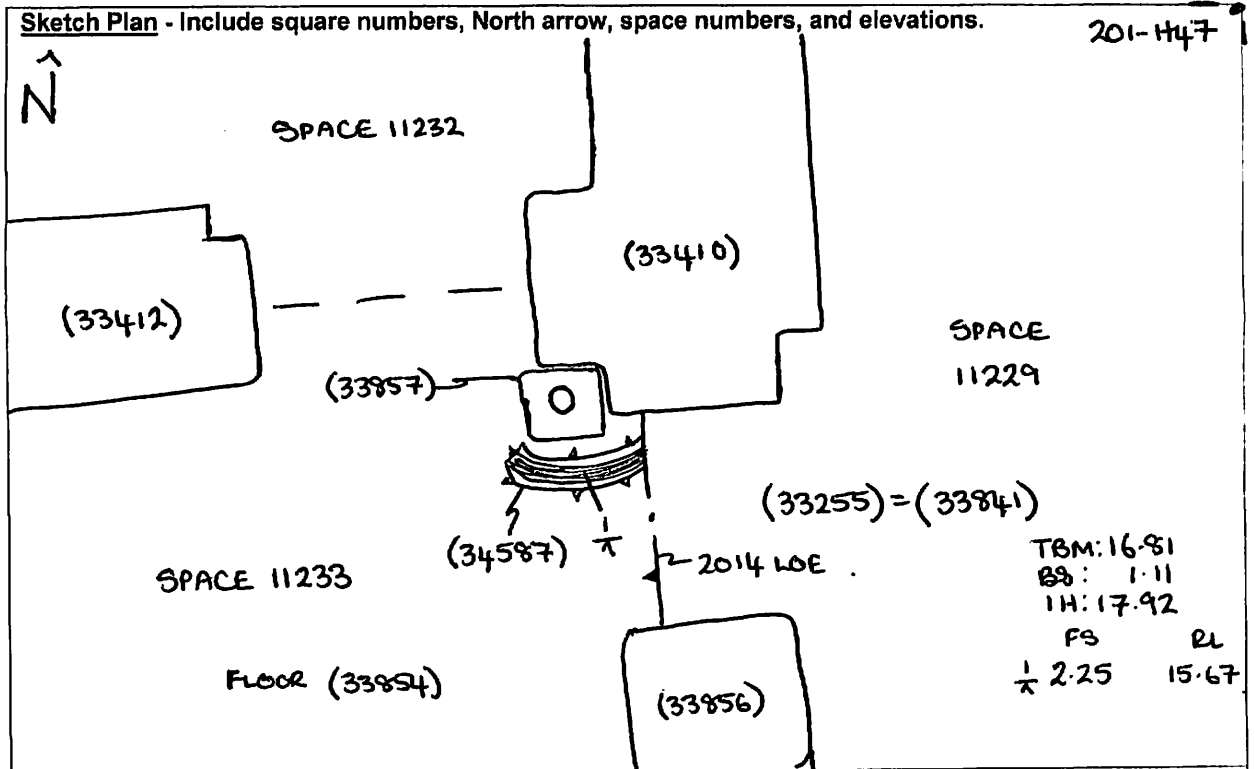

Profile Sketch - State direction the elevation of the feature being drawn is facing e.g. 'West Facing Elevation of Feature If feature was drawn in section then include the grid co-ordinates and elevations.

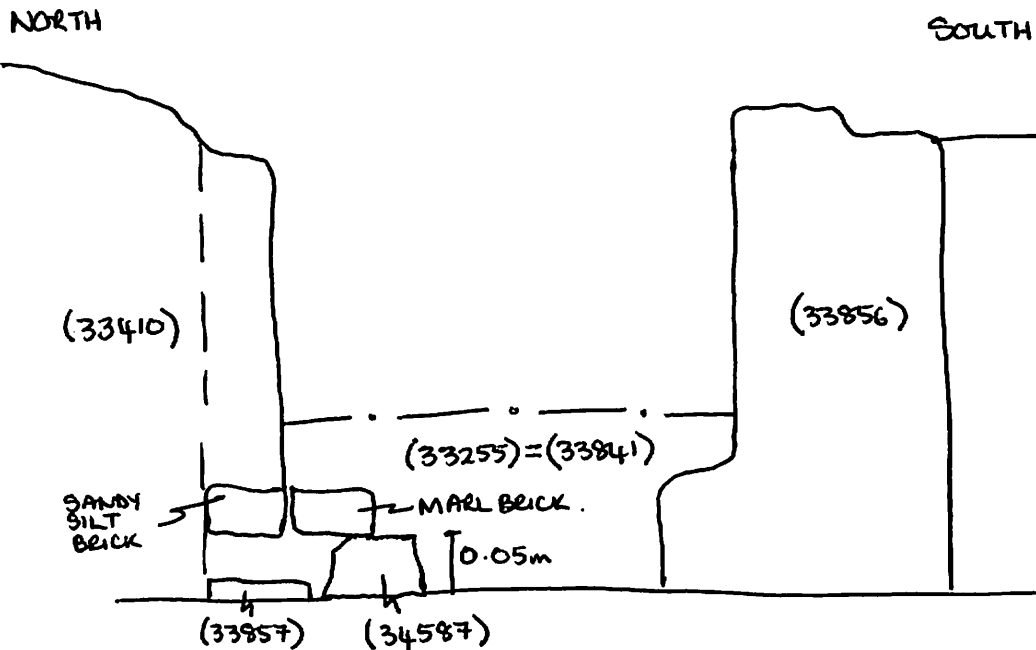

Drawing No.'s:	2012-121 (201-447)	Photo No.'s:	815352, 815353
Space No.:	11233	Structure No.:	15124
Matrix Group:	18134	Matrix Phase:	
Samples taken:	/	Sondage No.:	/