

AREA: KKT- & + SBC		GRID SQUARES: 201-I46		INITIALS & DATE: REM, HRK 13-IV-2014		FEATURE No.: 34594												
FEATURE TYPE (For example wall, staircase, bench, foundation structure, platform etc.): platform?				Full extent visible in plan: <input checked="" type="checkbox"/> YES / NO														
1. Dimensions (in metres)		Length: 0.46m	Width: 0.46m	Height: —														
2. Type of material(s) used		Lime stone																
3. Coursing (form of construction)		N/A																
4. Orientation		/																
5. Associated collapse		—																
6. Cut & fill feature #'s		—																
7. Repaired?		—																
8. Associated floors		—																
9. Surface treatments? E.g. plaster, paint, mouldings		—																
10. Size of one component		—																
11. Bonding material																		
12. Excavated		Yes/No																
Mini stratigraphic matrix <table border="1" style="width: 100%; text-align: center;"> <tr> <td style="width: 25%; height: 20px;"></td> <td style="width: 25%; height: 20px;">34576</td> <td style="width: 25%; height: 20px;"></td> </tr> <tr> <td></td> <td style="border-top: 1px solid black;">34594</td> <td></td> </tr> <tr> <td style="height: 20px;"></td> <td style="border-top: 1px solid black;">NFE</td> <td style="height: 20px;"></td> </tr> </table>					34576			34594			NFE		Abuts: 33262 Abutted by: Bonded into: Contiguous with:				Same as: Associated features:	
	34576																	
	34594																	
	NFE																	
Discussion and interpretation: Lime stone squared feature, suggest that it could be a remain of hearth platform setting over baking area - it might be similar to the hearths' platform that had been discovered in HeG site such as 1991 bakeries and bakery of EOG-D Not excavated during 2014 season																		

Remember: do not just draw the architectural feature in isolation. Show how it relates to surrounding features and include details of surface treatments, repairs/modifications/damage, bonding material(s), and associated cuts. Annotate all aspects of the feature or use a Drawing Key. Measurements must be included for all aspects of the feature and surrounding features.

Sketch Plan - Include square numbers, North arrow, space numbers, and elevations.

TBM 16.81
 BS 2.05
 Loc 18.86
 1 F₂ RL
 K 3.41 15.45
 2
 K 3.39 15.47

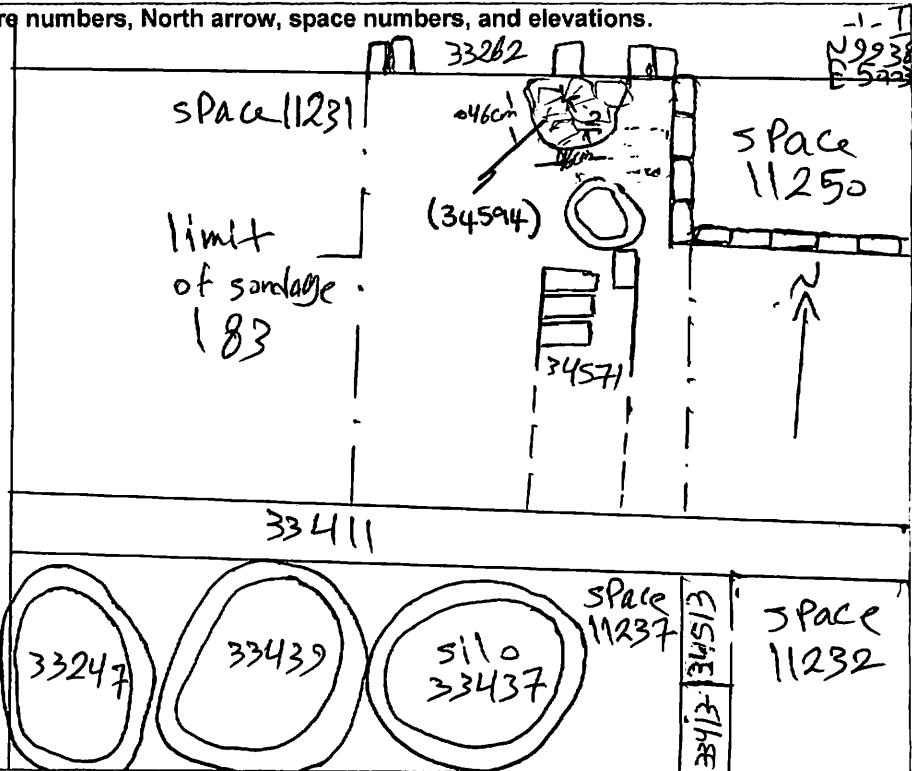

Profile Sketch - State direction the elevation of the feature being drawn is facing e.g. 'West Facing Elevation of Feature If feature was drawn in section then include the grid co-ordinates and elevations.

Drawing No.'s: 2014-36, 2014-37	Photo No.'s: 2014-815328 → 815331
Space No.: 11640	Structure No.:
Matrix Group: 18220	Matrix Phase:
Samples taken:	Sondage No.: 183