

5C

GPMP 2008	GRID SQUARE(S) 10L R26	ARCHITECTURE	CONTEXT 29641
1. Material	1. limestone, mud render, marl		
2. Size of materials	2. stones range from pebble/chips to cobble & boulder size		
3. Finish	3. roughly hewn		
4. Coursing/bond	4. random coursed to random uncoursed		
5. Form	5. wall		
6. Direction of faces	6. E & W		
7. Orientation	7. N-S		
8. Dimensions	8. 2.98m x 3.4m - .27m		
9. Associated collapse	9. N/A		
10. Founds, cuts & fills	10. N/A		
11. Repaired	11. mud rendering along the bottom but otherwise repairs not visible		
12. Associated floors	12. 29981		
13. Plastered	13. evidence of mud render but not plaster over limestone		
14. Wall core	14. sandy mud, occasional pottery bits, small stone pebbles		
15. Types of brick (%)	15. 17. nearly all limestone		
16. Composition of bricks			
17. Dimensions of bricks (sample of three)			

Stratigraphic Matrix	Abuts	Above									
<table border="1" style="width: 100%; height: 100%;"> <tr> <td style="width: 33%; height: 30px;"></td> <td style="width: 33%; height: 30px;"></td> <td style="width: 33%; height: 30px;"></td> </tr> <tr> <td style="width: 33%; height: 30px;"></td> <td style="width: 33%; height: 30px; text-align: center;">29641</td> <td style="width: 33%; height: 30px; text-align: center;">29601</td> </tr> <tr> <td style="width: 33%; height: 30px;"></td> <td style="width: 33%; height: 30px;"></td> <td style="width: 33%; height: 30px;"></td> </tr> </table>					29641	29601				Abutted by	Below
	29641	29601									
	Bonded into 29601										
	Contiguous with										

INTERPRETATION	(Enclosing)	Internal	External
Reason for decay	N-S fieldstone wall which meets E-W fieldstone wall 29601 and possibly 29594.		
Indications of original dimensions			
Indications of original functions	N-S fieldstone wall which is bonded into wall 29601 at the corner. However 29601 may actually be a wall which was abutted by 29641 east of the corner to form an enclosed area/room 186 of Salim Hassan's plan		

Associated contexts:

Context Same As:

Drawing Nos: 2008-14, 2008-52 section

Photographs (Digital)	Finds		Samples
	Bag No.	Type	
510880			Building Complex
510881			
			Phase
	Site Book Pages	Checked	Initials Date

18.63
18.38
18.21

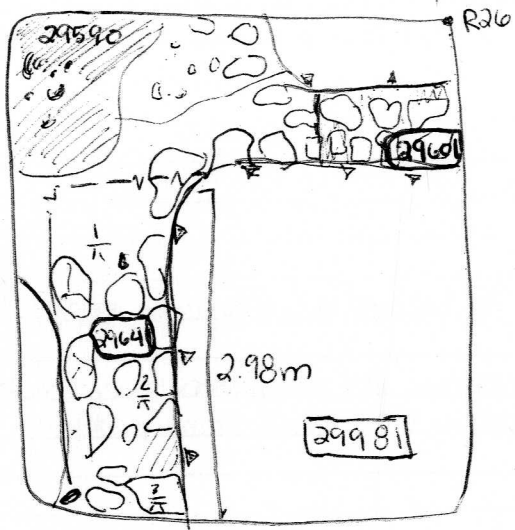

N
↑

$\frac{1}{\wedge}$ 18.63

$\frac{2}{\wedge}$ 18.30

$\frac{3}{\wedge}$ 18.21