

GIZA PLATEAU MAPPING PROJECT

Grid Square(s) 101-129/129	Area KKI	Context Type Deposit	Central Coords	Context 29764
DEPOSIT				CUT
1. Compaction		1. Loose		1. Shape in plan 2. Corners 3. Dimension/Depth 4. Break of slope-top 5. Sides 6. Break of slope-base 7. Base 8. Orientation 9. Inclination of axis 10. Truncated (if known) 11. Fill #s 12. Other comments Draw profile overleaf
2. Colour		2. Light greyish brown		
3. Composition/Particle Size (Over 10%)		3. Silt (86%) - Sand (15%)		
4. Inclusions (Under 10%) occa / mod / freq		4. Occa. medium pebbles and very occa. fragments of ceramics.		
5. Thickness and extent		5. Thickness: N/A (not excavated)		
6. Top and bottom boundaries		6. Extent: at least 1.24 m length		
7. Other comments		7. 1.0 m wide		
8. Method and conditions		8. Top boundary: clear		
NOT EXCAVATED				
Type of feature:				
Stratigraphic Matrix				
This context is 29764				
29762 29769				
Your interpretation:		Internal External Structural Other (specify)		
Your discussion:				
Sandy silt layer which look likes the layer of S. Hassan post Excavation. [29391] - (?).				
Placement in square				
				
Context same as:		See contexts:		
Site Book Refs:		Matrix phase:		Initials and date DEID 27-III-08
Checked Interpretation:				
Provisional period		Group/Phase		Initials and date

Context Number	29764	GPMP	2008
Bag Numbers			
Ceramics		Objects	
Environmental Samples & Type		Exotics	
Charcoal		Other	
Bones			
Lithics			

Photographs
S10871 - S10873

Drawings	
Plans	Sections
2008-41	

Top Elevation 17,87. Bottom Elevations

Wrong
levels

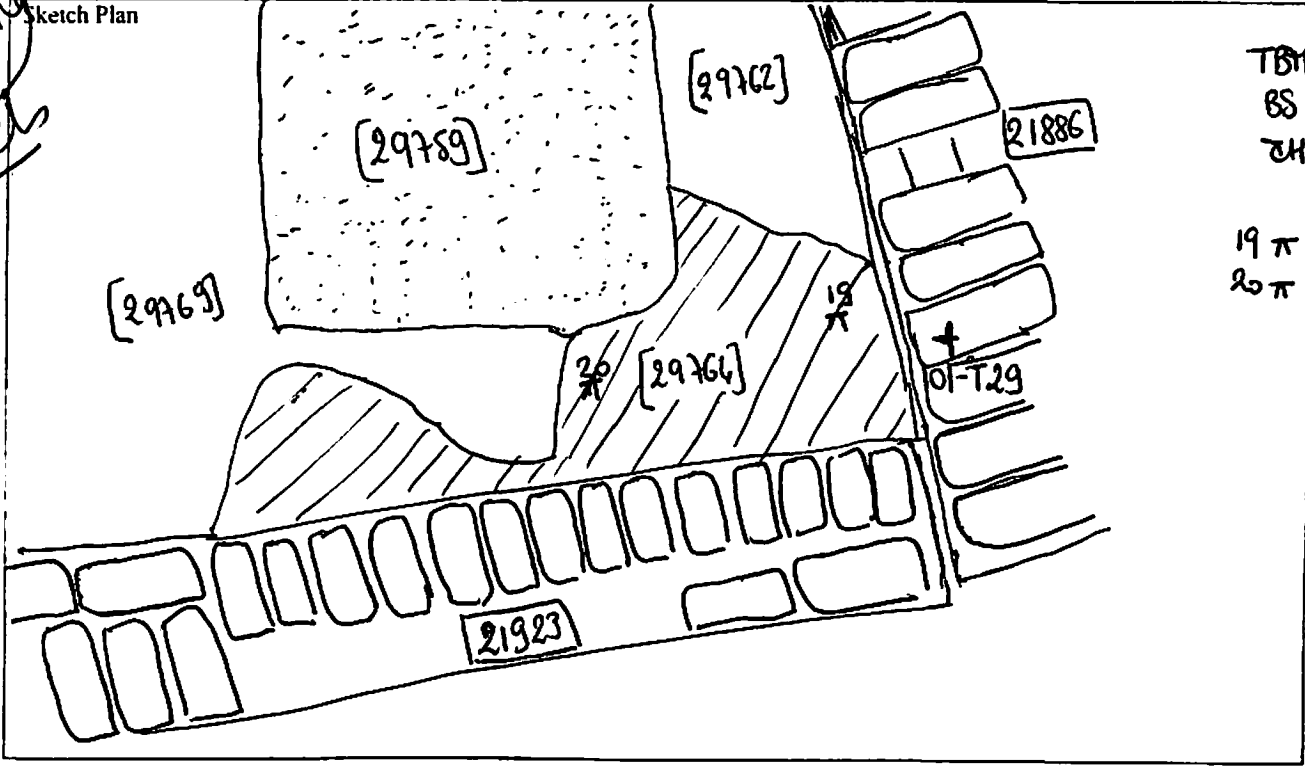

TBM: 18,54
BS: 2,40
CH: 20,94
19 π 3,07
20 π 3,07