

AREA: MVT-E	GRID SQUARE (S): 101-N22, 101-N23 101-O22, 101-O23	GRID CO-ORDINATES: E N	INITIALS & DATE: MAAG-AMAG 8 II 2012	FEATURE No.: <29808>
-----------------------	--	------------------------------	--	-------------------------

FEATURE TYPE (For example wall, staircase, bench, foundation structure, platform etc.): wall	Full extent visible in plan: YES / NO <input checked="" type="checkbox"/> / <input type="checkbox"/>
--	--

1. Dimensions (in metres)	Length: 5.50 M	Width: 1.35 M	Height: 1.25 M
---------------------------	--------------------------	-------------------------	--------------------------

2. Type of material(s) used	Mud brick
-----------------------------	------------------

3. Coursing (form of construction)	10 coursings, all stretcher
------------------------------------	------------------------------------

4. Orientation	East-west
----------------	------------------

5. Associated collapse	(32768)
------------------------	----------------

6. Cut & fill feature #'s	—
---------------------------	----------

7. Repaired?	—
--------------	----------

8. Associated floors	(33111)
----------------------	----------------

9. Surface treatments? E.g. plaster, paint, mouldings	(33360) plaster
---	------------------------

10. Size of one component	0.34 M Length X 0.18 M width X 0.14 M Height
---------------------------	---

11. Bonding material	Sandy silt
----------------------	-------------------

12. Excavated	Yes/No <input checked="" type="checkbox"/> / <input type="checkbox"/> No
---------------	--

Mini stratigraphic matrix 	Abuts: <32863> Same as: Abutted by: Associated features: Bonded into: Contiguous with:
-------------------------------	---

Discussion and interpretation:

*the northern enclosure wall to the ~~south~~ East north of
the enclosure ~~ten~~ wall of the temple <32863>*

Remember: do not just draw the architectural feature in isolation. Show how it relates to surrounding features and include details of surface treatments, repairs/modifications/damage, bonding material(s), and associated cuts. Annotate all aspects of the feature or use a Drawing Key. Measurements must be included for all aspects of the feature and surrounding features.

Sketch Plan - Include grid co-ordinates, North arrow, and elevations.

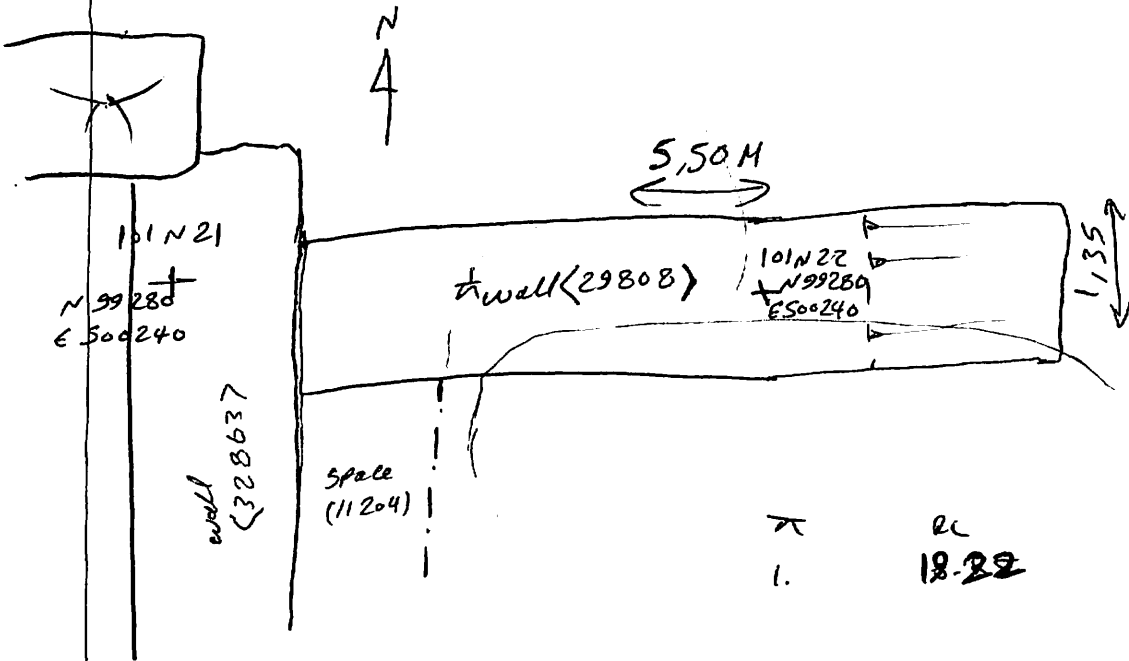

Profile Sketch - State direction the elevation of the feature being drawn is facing e.g. 'West Facing Elevation of Feature If feature was drawn in section then include the grid co-ordinates and elevations.

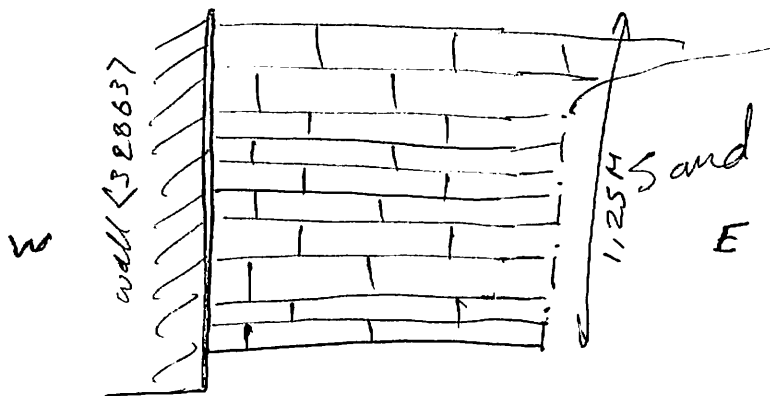

Drawing No.'s: 2012 - 21 22	Photo No.'s: 512854 - 55
Space No.:	Structure No.:
Matrix Group:	Matrix Phase:
Samples taken:	