

AREA: KKT-E	GRID SQUARE (S): 201-C36	GRID CO-ORDINATES: E 500310.000 N 99355.000	INITIALS & DATE: DCJ 09/02/11	FEATURE No.: 29918
FEATURE TYPE (For example wall, staircase, bench, foundation structure, platform etc.):			Full extent visible in plan: <input checked="" type="checkbox"/> YES / NO IN SONDAGE ONE.	
1. Dimensions (in metres)	Length: 15.58 +1.15m	Width: 0.74m	Height: 0.44m	
2. Type of material(s) used	UN FIRED BRICKS 100%			
3. Coursing (form of construction)	ALTERNATE ROWS OF HEADERS & STRETCHERS. 4 COURSES HIGH.			
4. Orientation	NW/SE.			
5. Associated collapse	POSSIBLY (30883).			
6. Cut & fill feature #'s	NONE.			
7. Repaired?	NONE VISIBLE ON THIS SECTION OF THE WALL			
8. Associated floors	(32421), (30871), (30882), (32916), (29028) & (32923)			
9. Surface treatments? E.g. plaster, paint, mouldings	MARL RENDER (29917) LIME WASH (32923) MARL RENDER (29027) LIME WASH (29028) NO PAINT OR DECORATION.			
10. Size of one component	0.11m x 0.30m x 0.14m WIDTH.			
11. Bonding material	OCCASIONAL USE OF MARL BUT MOSTLY NONE.			
12. Excavated	<input checked="" type="checkbox"/> Yes/No IN SONDAGE ONE.			
Mini stratigraphic matrix		Abuts: Same as: N/A.		
<pre> graph TD     A[ ] --- B[29917]     B --- C[29918]     C --- D[32927]     C --- E[ ]     E --- F[32934]             </pre>		Abutted by: Bonded into: <input checked="" type="checkbox"/> Contiguous with: (29913)		
		Associated features: (29917) (32923) (29027) (29028) (32927) (32934)		
Discussion and interpretation:				
NO TRUNCATIONS OR CUTS VISIBLE IN THIS SECTION OF THE WALL.				
SOUTHERN EAST BOUNDING WALL OF SLR.				
CONCENTRATED ROOTS WITHIN WALL				
2 TYPES OF BRICKS USED 1 WITH HIGH SILT CONTENT 1 WITH HIGH SAND CONTENT.				

Remember: do not just draw the architectural feature in isolation. Show how it relates to surrounding features and include details of surface treatments, repairs/modifications/damage, bonding material(s), and associated cuts. Annotate all aspects of the feature or use a Drawing Key. Measurements must be included for all aspects of the feature and surrounding features.

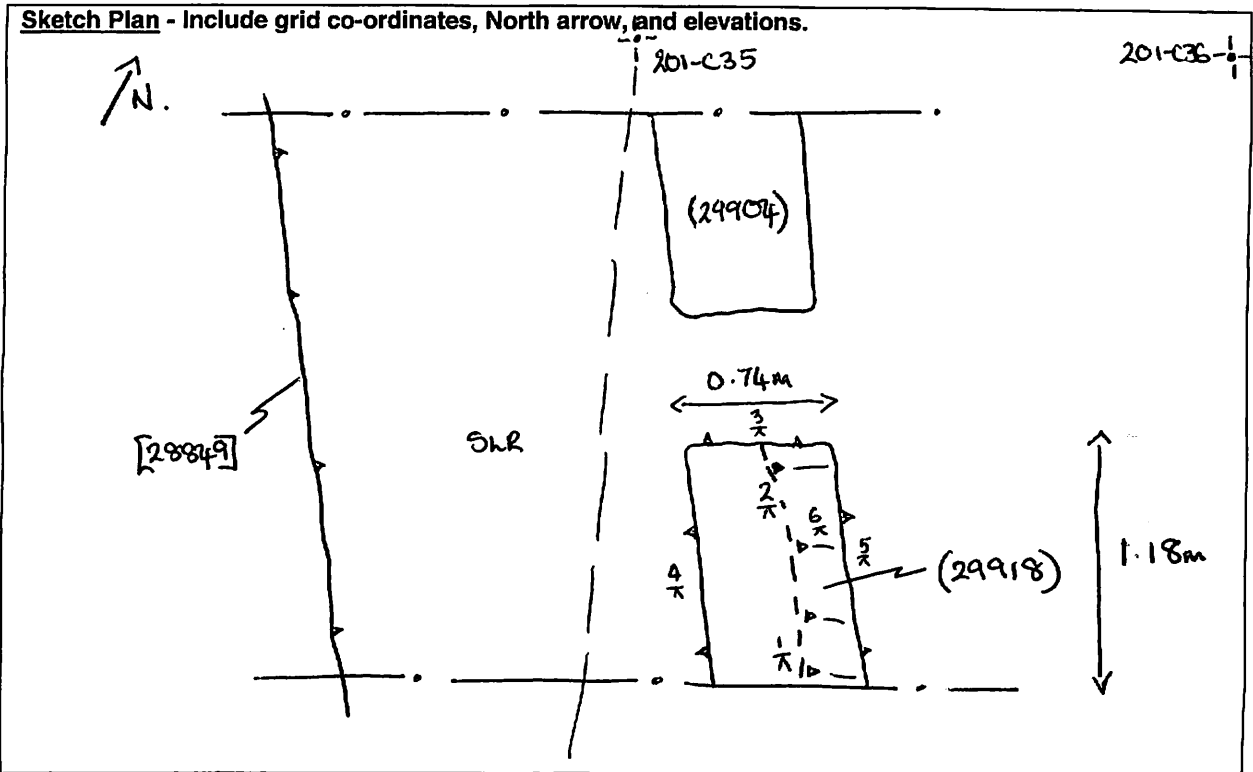

**Profile Sketch - State direction the elevation of the feature being drawn is facing e.g. 'West Facing Elevation of Feature .... If feature was drawn in section then include the grid co-ordinates and elevations.**

TBM: 17.68  
 BS: 0.71  
 IH: 18.39

FS	R.
1/x 1.28	17.11
2/x 1.29	17.10
3/x 1.70	16.69
4/x 1.71	16.68
5/x 1.76	16.63
6/x 1.93	16.86

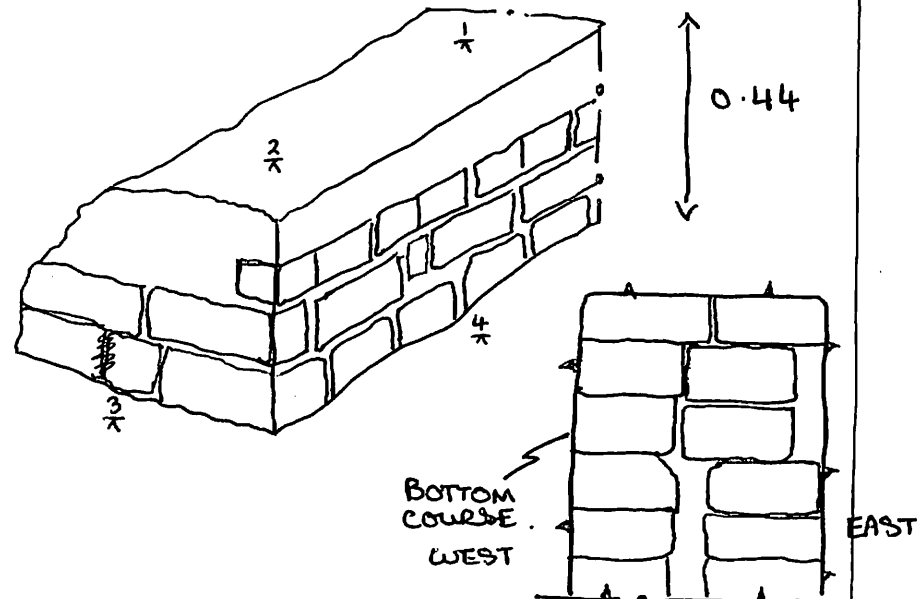

Drawing No.'s: (29918) x 1 .	Photo No.'s: <del>14-14, 15, 16, 17, 18</del> 613363, 306711, 306712, 306713
Space No.:	Structure No.: 306714, 306715
Matrix Group:	Matrix Phase:
Samples taken:	