

DB✓

# GIZA PLATEAU MAPPING PROJECT

Grid Square(s) 101 - Q+R 25	Area KKT-A1	Context Type DEPOSIT	Central Coords —	Context 30246																																		
DEPOSIT		CUT																																				
1. Compaction 2. Colour 3. Composition/Particle Size (Over 10%) 4. Inclusions (Under 10%) occa / mod / freq 5. Thickness and extent 6. Top and bottom boundaries 7. Other comments 8. Method and conditions	1/ Firm - yet friable 2/ LIGHT YELLOWISH BROWN 3/ 30% LIME STONE CHIPS 20% SAND 4/ OCCASIONAL PINK GRANITE CHIPS ; ALABASTER LUMPS ; FLINT AND CHERT KNIBBLES ; FINE STONE ; DOLENITE / GRANITE ; QUARTZITE ; POSSIBLY NY TWO WASTERS ; MALL CHUNK (NO INCLUSIONS) ; 1X CYALLET OBJECT ; MUD BRICK FRAG 5/ 4.50m NW x 2.00m (SOUNDGE) x 0.95m THICK 6/ TOP - CLEAR BOTTOM STAMP 7/ DNG 12 2m WIDE SOUNDGE 8/ HOT, DRY, WINDY		1. Shape in plan 2. Corners 3. Dimension/Depth 4. Break of slope-top 5. Sides 6. Break of slope-base 7. Base 8. Orientation 9. Inclination of axis 10. Truncated (if known) 11. Fill #s 12. Other comments Draw profile overleaf																																			
Type of feature:																																						
Stratigraphic Matrix																																						
<table border="1" style="width: 100%; border-collapse: collapse;"> <tr> <td style="width: 10%;"></td> <td style="width: 10%;"></td> <td style="width: 10%; text-align: center;">29643</td> <td style="width: 10%; text-align: center;">30021</td> <td style="width: 10%;"></td> <td style="width: 10%;"></td> <td style="width: 10%;"></td> <td style="width: 10%;"></td> <td style="width: 10%;"></td> <td style="width: 10%;"></td> <td style="width: 10%;"></td> </tr> <tr> <td colspan="3" style="text-align: center;">This context is</td> <td style="text-align: center;">30246</td> <td colspan="8"></td> </tr> <tr> <td style="width: 10%;"></td> <td style="width: 10%;"></td> <td style="width: 10%;"></td> <td style="width: 10%; text-align: center;">29994</td> <td style="width: 10%;"></td> <td style="width: 10%;"></td> <td style="width: 10%;"></td> <td style="width: 10%;"></td> <td style="width: 10%;"></td> <td style="width: 10%;"></td> <td style="width: 10%;"></td> </tr> </table>							29643	30021								This context is			30246												29994							
		29643	30021																																			
This context is			30246																																			
			29994																																			
Your interpretation:																																						
<table style="width: 100%;"> <tr> <td style="width: 25%;">Internal</td> <td style="width: 25%; text-align: center;"><u>External</u></td> <td style="width: 25%;">Structural</td> <td style="width: 25%;">Other (specify)</td> </tr> </table>					Internal	<u>External</u>	Structural	Other (specify)																														
Internal	<u>External</u>	Structural	Other (specify)																																			
Your discussion:																																						
<p>FILL OF LINEAR E-W <del>CH</del> CHANNEL - <del>SECONDARY DEPOSITED</del></p> <p>THE FILL CONSISTS PRIMARILY OF LIME STONE CHIPS - BUT ALSO CONTAINS <del>SOME</del> SEVERAL OTHER EXOTIC STONE TYPES.</p> <p>INCLUDING PINK GRANITE AND ALABASTER. - POSS. MAXIMUM DEPTH -</p>																																						
				Placement in square <div style="border: 1px solid black; width: 100%; height: 100%;"></div>																																		
Context same as: <i>Identical to 31010</i>		See contexts:																																				
Site Book Refs:		Matrix phase:		Initials and date MWH 09/02/09																																		
Checked Interpretation:																																						
Provisional period		Group/Phase		Initials and date																																		

Context Number 30246.	GPMP 2009.
-----------------------	------------

Bag Numbers

Ceramics 2009 - <del>2009</del> 1207	Objects CU ALLOY OBJECT 2009-1205
Environmental Samples & Type 2009-1209.	Exotics PINK GRANITE.
	DOLENITE / BASALT
Charcoal	FLINT / CHERT.
	DOLENITE
	Other
Bones 2009-1206	MARL LUMP - 2009-1208.
Lithics	
Photographs	

Drawings

Plans P-30246	Sections 2009-65, 2009-66
Top Elevation 17.34.	Bottom Elevations 16.93.

Sketch Plan

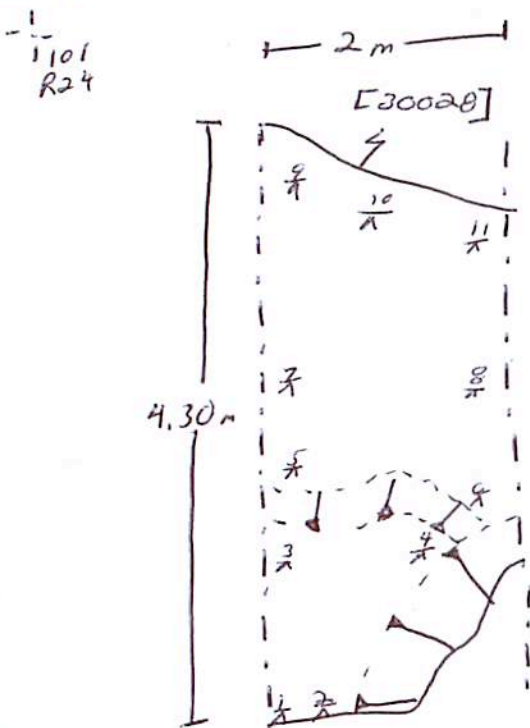

- |    |                        |
|----|------------------------|
| π  |                        |
| 1  | 17.34                  |
| 2  | 17.27                  |
| 3  | 17.29                  |
| 4  | 17.24                  |
| 5  | 17.11                  |
| 6  | 17.07                  |
| 7  | <del>16.99</del> 17.13 |
| 8  | 16.99                  |
| 9  | 17.25                  |
| 10 | 17.03                  |
| 11 | 16.93                  |

NT 19  
R25