

# GIZA PLATEAU MAPPING PROJECT

Grid Square(s) <b>21-G36, H35</b>	Area <b>KKT-E</b>	Context Type <b>DEPOSIT</b>	Central Coords	Context <b>20840</b>
<b>DEPOSIT</b>				<b>CUT</b>
<ol style="list-style-type: none"> <li>1. Compaction</li> <li>2. Colour</li> <li>3. Composition/Particle Size (Over 10%)</li> <li>4. Inclusions (Under 10%) occa / mod / freq</li> <li>5. Thickness and extent</li> <li>6. Top and bottom boundaries</li> <li>7. Other comments</li> <li>8. Method and conditions</li> </ol>		<ol style="list-style-type: none"> <li>1. <b>COMPACT</b></li> <li>2. <b>LIGHT GREYISH BROWN</b></li> <li>3. <b>SANDY SILT</b></li> <li>4. <b>mod. pattern charcoal (mod), (acc) bone acc shells</b></li> <li>5. <b>depth: max. ca. 0.15m</b></li> <li>6. <b>2.15m (N/S); E/W: ca 5m; width: 1.15-1.65m</b></li> <li>7. <b>top: clear; bottom: slightly defused in places</b></li> </ol>		<ol style="list-style-type: none"> <li>1. Shape in plan</li> <li>2. Corners</li> <li>3. Dimension/Depth</li> <li>4. Break of slope-top</li> <li>5. Sides</li> <li>6. Break of slope-base</li> <li>7. Base</li> <li>8. Orientation</li> <li>9. Inclination of axis</li> <li>10. Truncated (if known)</li> <li>11. Fill #s</li> <li>12. Other comments Draw profile overleaf</li> </ol>
		<b>8. bowl, garden; clay + sunny</b>		
Type of feature:				
Stratigraphic Matrix				
<div style="display: flex; justify-content: space-around; align-items: center;"> <div style="border: 1px solid black; width: 30px; height: 30px; margin: 2px;"></div> <div style="border: 1px solid black; width: 30px; height: 30px; margin: 2px;"></div> <div style="border: 1px solid black; width: 30px; height: 30px; margin: 2px;"></div> <div style="border: 1px solid black; width: 30px; height: 30px; margin: 2px; text-align: center;">30839</div> <div style="border: 1px solid black; width: 30px; height: 30px; margin: 2px; text-align: center;">= 30806</div> <div style="border: 1px solid black; width: 30px; height: 30px; margin: 2px; text-align: center;">= 30825</div> <div style="border: 1px solid black; width: 30px; height: 30px; margin: 2px; text-align: center;">= 30871</div> <div style="border: 1px solid black; width: 30px; height: 30px; margin: 2px;"></div> <div style="border: 1px solid black; width: 30px; height: 30px; margin: 2px;"></div> <div style="border: 1px solid black; width: 30px; height: 30px; margin: 2px;"></div> <div style="border: 1px solid black; width: 30px; height: 30px; margin: 2px;"></div> </div> <p style="text-align: center; margin: 5px 0;">This context is <span style="border: 1px solid black; padding: 2px;">30840</span> = 30843 = 30815</p> <div style="display: flex; justify-content: space-around; align-items: center;"> <div style="border: 1px solid black; width: 30px; height: 30px; margin: 2px;"></div> <div style="border: 1px solid black; width: 30px; height: 30px; margin: 2px;"></div> <div style="border: 1px solid black; width: 30px; height: 30px; margin: 2px;"></div> <div style="border: 1px solid black; width: 30px; height: 30px; margin: 2px; text-align: center;"><del>30874</del></div> <div style="border: 1px solid black; width: 30px; height: 30px; margin: 2px; text-align: center;">30809</div> <div style="border: 1px solid black; width: 30px; height: 30px; margin: 2px;"></div> <div style="border: 1px solid black; width: 30px; height: 30px; margin: 2px;"></div> <div style="border: 1px solid black; width: 30px; height: 30px; margin: 2px;"></div> <div style="border: 1px solid black; width: 30px; height: 30px; margin: 2px;"></div> <div style="border: 1px solid black; width: 30px; height: 30px; margin: 2px;"></div> </div>				
Your interpretation: <input checked="" type="radio"/> Internal <input type="radio"/> External <input checked="" type="radio"/> Structural <input type="radio"/> Other (specify)				
Your discussion: <b>BEDDING LAYER FOR MARL FLOOR 30839. it is fairly thin and rests above both 30810, and patches in places where 30810 is hollowed; possibly on another floor.</b>				
Placement in square				
<div style="border: 1px solid black; width: 100%; height: 100%;"></div>				
Context same as: <b>30815, 30843</b>		See contexts: <b>30806, 30815, 30843, 30839, 30875</b>		
Site Book Refs:		Matrix phase: <b>VII</b>		Initials and date <b>KO 3/03/09</b>
Checked Interpretation:				
Provisional period		Group/Phase <b>gr. 9722</b>		Initials and date

Context Number **30840** GPMP **09**

Ceramics **2009-1094 - pot from sieving** Bag Numbers  
**#2009-1079** Objects  
**2009-1116**  
**2009-1079 to 1083 - WET SIEVE**  
~~2009-1096~~

Environmental Samples & Type  
**#2009-1091** Exotics  
**2009-1072** ROTATION

Charcoal  
**2009-1085 - charcoal from sieving**  
**2009-1117 - " " "** Other

Bones  
**2009-1097 - bones (from sieving)**  
**2009-1118 - " " "** 2009-1113 - shells (from sieving)  
 2009-1096 - shells (from sieving)

Lithics  
**2009-1113**  
**2009-1114** WET SIEVE  
**2009-1115**

Photographs  
**#511824 (only)**  
**511825 (probably)**  
**511826**  
**511827 511828-86**

Plans **30840 X3** Drawings Sections

Top Elevation **30840 X3 17.96** Bottom Elevations **17.47**

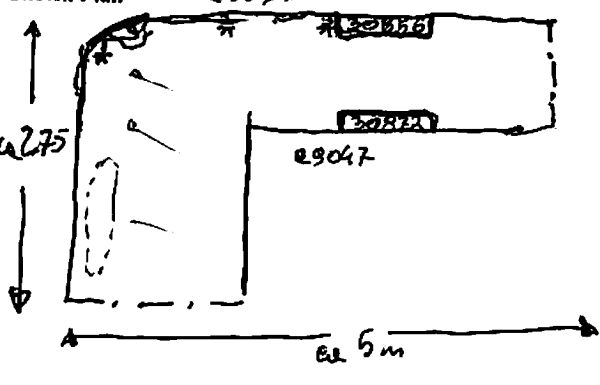

1	0.94	12.86	9	1.23	17.59
2	1.04	12.86	10	1.27	17.55
3	1.16	17.74	11	1.16	17.66
4	1.17	17.73	12	1.19	17.63
5	0.99	17.51			
6	1.12	12.78	Tom 17.30		
7	1.20	17.30	BS 1.06		
8	1.26	17.64	14 18.74		
13	0.99	17.91	20	1.11	17.63
14	0.98	12.92	21	1.20	17.54
15	1.08	17.82	22	1.16	17.58
16	1.16	17.74	23	1.19	17.55
17	1.13	17.77	24	1.20	17.54
18	1.12	17.78	25	1.19	17.55
19	1.15	17.75	26	1.22	17.52
			27	1.27	17.47