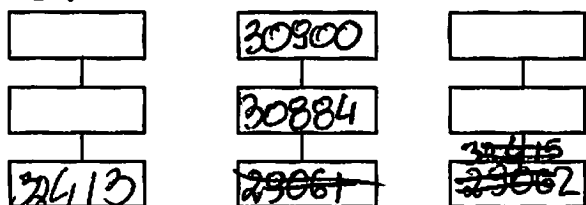

Site: GPMP 09 Area: KRIE	GRID SQUARE(S) 201. H36	ARCHITECTURE	FEATURE 30884
1. Material	1. mud bricks		
2. Size of materials	2. 32cm x 12.5cm x 16cm		
3. Finish	3. -		
4. Coursing/bond	4. mostly stretchers with a few headers		
5. Form	5. wall		
6. Direction of faces	6. N/A		
7. Orientation	7. N-E		
8. Dimensions	8. pos. 30876		
9. Associated collapse	9. E-W: 1.80m; N-S 0.50m; height (exposed): 0.90m (max.)		
10. Founds, cuts & fills	10. -		
11. Repaired	11. -		
12. Associated floors	12. -		
13. Plastered	13. on the N side (#30900)		
14. Wall core	14. -		
15. Types of brick (%)	15. primarily "BUBBLE GUM" BRICKS AND SANDY SILTY BRICKS		
16. Composition of bricks	16. CLAYEY SILT; SANDY SILT		
17. Dimensions of bricks (sample of three)	17. 32cm x 12.5cm x 16cm		

Stratigraphic Matrix	Abuts 29068	Above 29061, 32415
	Abutted by 30891	Below 30900
	Bonded into unknown	
	Contiguous with 30886	

INTERPRETATION	Enclosing	Internal	External
Reason for decay	This feature is a badly damaged well (cut by [30867] and prob. by [30826]); it is blocking an entranceway between 29068 and 29062		
Indications of original dimensions	It has been partially exposed but not excavated.		
Indications of original functions			

Associated contexts: 30891, 30886

Context Same As: -

Drawing Nos: 30884, 2009-57 (elevation) (3. facing elevation), 2009-52, 2009-351

Photographs (feature in plan, elevation, materials used, surface treatment e.g. plaster, paint etc.)		Finds		Samples (flotation, wet sieve, materials used e.g. bricks, stone, wood, bonding material etc.)	
Photograph No.	Description	Bag No.	Description	Bag No.	Description
511909	Down (S)				
511910	- " -				
511911	facing N				
511912	DETAIL, facing Down (N)				
511883		Phase: IV / Gr. 9717		Checked	Initials RO
511884					Date 21/03/08

Sketch Drawings (in plan and in profile)

Remember: do not just draw the architectural feature in isolation. Show how it relates to surrounding features and include details of surface treatments, repairs/modifications/damage, bonding material(s), and associated cuts. Annotate all aspects of the feature or use a Drawing Key. Measurements must be included for all aspects of the feature and surrounding features.

Sketch Plan - Include grid/co-ordinates, North arrow, and elevations, 201. H36

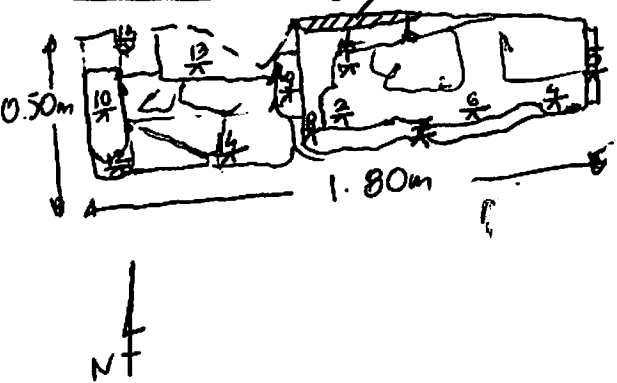

TBM	17.70
PS	2.82
IH	20.52
1)	1.45 19.02
2)	1.56 18.96
3)	1.41 19.11
4)	1.52 19.00
5)	1.64 18.88
6)	1.56 18.96
7)	1.90 18.62
8)	1.99 18.53
9)	2.18 18.34

TBM	17.70
PS	2.75
IH	20.45
10)	2.08 18.37
11)	2.04 18.41

TBM	17.70
PS	2.71
IH	20.41
12)	2.21 18.20
13)	2.27 18.14
14)	2.37 18.04

Profile Sketch

- State direction the elevation of the feature being drawn is facing e.g. 'West Facing Elevation of Feature
- If feature was drawn in section then include the grid co-ordinates and elevations.

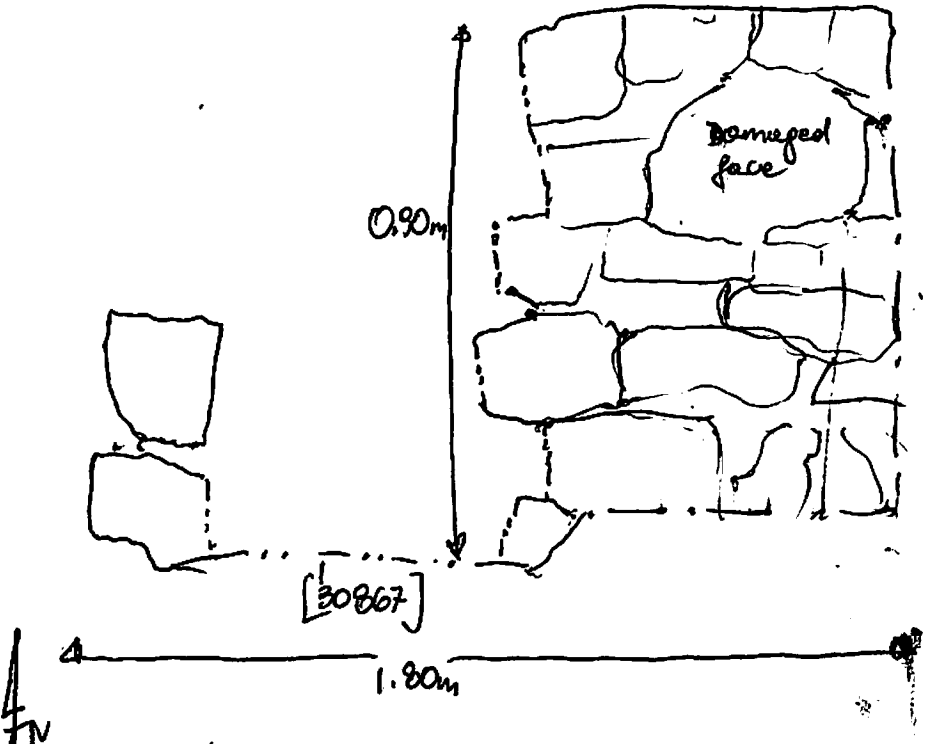

South facing elevation