

Site: GPMP Area: KKTAI	GRID SQUARE(S) S225 Q22 R22+23	ARCHITECTURE	FEATURE 30958
----------------------------------	--	--------------	-------------------------

1. Material	1, limestone blocks
2. Size of materials	2, various large rectangular sizes: sample: 66 x 35 x 15,
3. Finish	2.5 x 27 x 23, 40 x 36 x 25
4. Coursing/bond	
5. Form	3, all even, once polished
6. Direction of faces	4, 5 courses of stretchers, a few are headers
7. Orientation	5, interior of water basin
8. Dimensions	6, N/S/E/W
9. Associated collapse	7, N/S, along grid i.e. true N/S
10. Founds, cuts & fills	8, 5.30 long x 2.65 wide x 1.40 deep
11. Repaired	9, —
12. Associated floors	10, Salin Harin over burden
13. Plastered	11, —
14. Wall core	
15. Types of brick (%)	12, 30960, 30961
16. Composition of bricks	13, —
17. Dimensions of bricks (sample of three)	14, unknown 15, —, 16, — 17, see above # 2

Stratigraphic Matrix <pre> graph TD 30960 --- 30958 30958 --- 30964_30969["30964/30969"] 30958 --- 1metre["1 metre support"] 1metre --- 30973_29813["30973/29813"] </pre>	Abuts Abuted by 30960 Bonded into Contiguous with Above 1 metre support / 30961 Below 30960
--	--

INTERPRETATION	Enclosing <u>Internal Structure</u>	External
Reason for decay	Block structure, lower construction of basin,	
Indications of original dimensions	well constructed a lot of time went into this. No sign	
Indications of original functions	of residuals. Likel held water, stone walls step in towards bottom, which is only .95 meters wide at the base.	

Associated contexts:
 Context Same As:
 Drawing Nos: **2009-67, 2009-146, 153, 256, 260**

Photographs (feature in plan, elevation, materials used, surface treatment e.g. plaster, paint etc.)		Finds		Samples (flotation, wet sieve, materials used e.g. bricks, stone, wood, bonding material etc.)	
Photograph No.	Description	Bag No.	Description	Bag No.	Description
306 494-	details of in				
306507	walls of basin				
JPR	J				
			Phase:	Checked	Initials 3.11.09 Date 12.11.09

Sketch Drawings (in plan and in profile)

Remember: do not just draw the architectural feature in isolation. Show how it relates to surrounding features and include details of surface treatments, repairs/modifications/damage, bonding material(s), and associated cuts. Annotate all aspects of the feature or use a Drawing Key. Measurements must be included for all aspects of the feature and surrounding features.

Sketch Plan - Include grid co-ordinates, North arrow, and elevations.

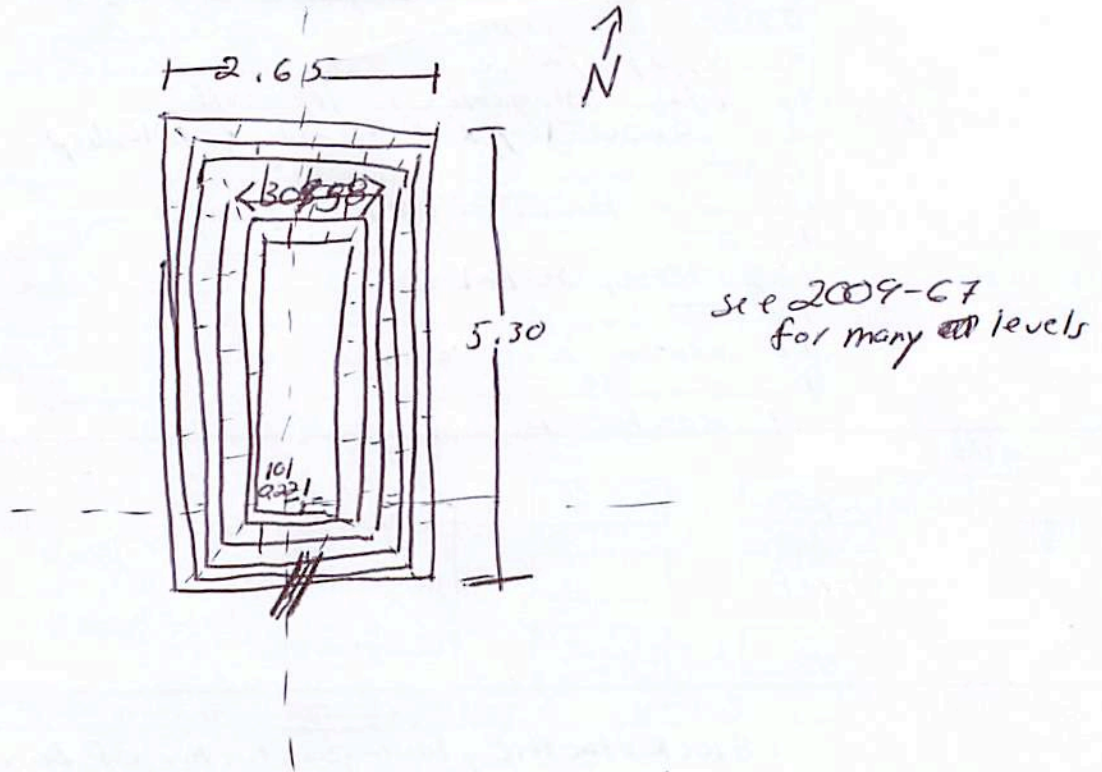

Profile Sketch

- State direction the elevation of the feature being drawn is facing e.g. 'West Facing Elevation of Feature
- If feature was drawn in section then include the grid co-ordinates and elevations.

