

Site: GPMP 2009. Area: IKT-N	GRID SQUARE(S) 201-E20/F20	ARCHITECTURE	FEATURE 31094
1. Material	1/. MUDBRICK 2/. - 3/. -		
2. Size of materials	4/. TWO COURSES, TOP COURSE IS FACED WITH STRACTIONS		
3. Finish	WITH ROW OF HERRINGS IN MIDDLE		
4. Coursing/bond	5/. N-S EXTERNAL WALL		
5. Form	6/. C/W		
6. Direction of faces	7/. N-S		
7. Orientation	8/. LENGTH= 5.40m; WIDTH= 0.82m; HEIGHT= 0.21m		
8. Dimensions	9/. - 10/. - 11/. - 12/. () ()		
9. Associated collapse	13/. 300x ()		
10. Founds, cuts & fills	14/. -		
11. Repaired	15/. 100% NILE CLAY		
12. Associated floors	16/. OMIC GRAY CLAY		
13. Plastered	17/. 390x180x UNCERTAIN MORTAR		
14. Wall core			
15. Types of brick (%)			
16. Composition of bricks			
17. Dimensions of bricks (sample of three)			

Stratigraphic Matrix	Abuts	Above
	Abutted by (31095)	Below
	Bonded into	
	Contiguous with	

INTERPRETATION	Enclosing	Internal	External
Reason for decay	NORTHERN PART OF WESTERN & WALL OF BUILDING E.		
Indications of original dimensions			
Indications of original functions			

Associated contexts:

Context Same As:

Drawing Nos: 2009-161, 162.

Photographs (feature in plan, elevation, materials used, surface treatment e.g. plaster, paint etc.)		Finds		Samples (flotation, wet sieve, materials used e.g. bricks, stone, wood, bonding material etc.)	
Photograph No.	Description	Bag No.	Description	Bag No.	Description
		Phase:	So	Checked	Initials LMY Date 2 iii '09

Sketch Drawings (in plan and in profile)

Remember: do not just draw the architectural feature in isolation. Show how it relates to surrounding features and include details of surface treatments, repairs/modifications/damage, bonding material(s), and associated cuts. Annotate all aspects of the feature or use a Drawing Key. Measurements must be included for all aspects of the feature and surrounding features.

Sketch Plan - Include grid co-ordinates, North arrow, and elevations.

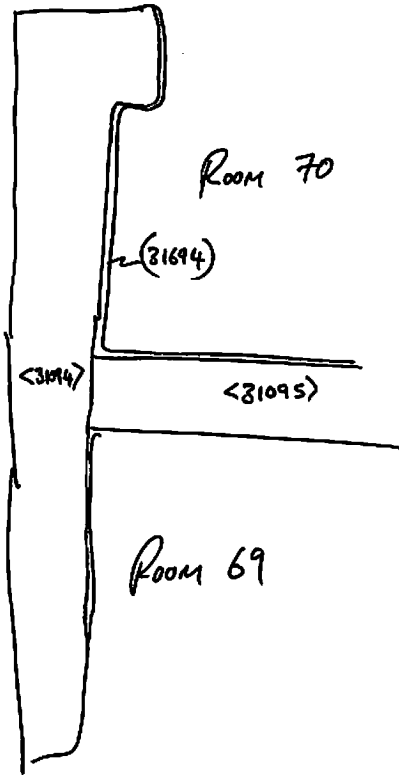

1
1201-F20

Profile Sketch

- State direction the elevation of the feature being drawn is facing e.g. 'West Facing Elevation of Feature
- If feature was drawn in section then include the grid co-ordinates and elevations.