

Site: GPMP Area: KKT-N	GRID SQUARE(S) 201E22, D22	ARCHITECTURE	FEATURE 31148
1. Material	1. mud Brick		
2. Size of materials	2. 230mm x 140mm x 50mm		
3. Finish	3. —		
4. Coursing/bond	4. only one course of headers surviving		
5. Form	5. v. slightly silty sand bonding material		
6. Direction of faces	6. —		
7. Orientation	7. —		
8. Dimensions	8. 2.60m (N-S) x 0.23 x 0.6m depth		
9. Associated collapse	9. —		
10. Founds, cuts & fills	10. —		
11. Repaired	11. —		
12. Associated floors	12. (31150) / (31151)		
13. Plastered	13. (31150) (31151)		
14. Wall core	14. yes mixed sandy clay matrix frog limestone frog mod pottery shard		
15. Types of brick (%)	15. silty sand Brick		
16. Composition of bricks	16. v. slightly silty sand light brown		
17. Dimensions of bricks (sample of three)	17. 230mm x 140mm x 50mm		

Stratigraphic Matrix	Abuts	Above
Abutted by	Below	
Bonded into		
Contiguous with		

Diagram showing stratigraphic matrix with boxes for features 31676, 31150/31151, 31148, and 31149/31148A.

INTERPRETATION	Enclosing	Internal	External
Reason for decay	Brown sandy brick as repair for the wall		
Indications of original dimensions	(31103) from the both side with wall		
Indications of original functions	Core sandy clay which separated between Room (74D) and the Corridor (74C)		

Associated contexts:

Context Same As:

Drawing Nos: 2009-31148				
Photographs (feature in plan, elevation, materials used, surface treatment e.g. plaster, paint etc.)	Finds		Samples (flotation, wet sieve, materials used e.g. bricks, stone, wood, bonding material etc.)	
	Bag No.	Description	Bag No.	Description
Photograph No.	Description	2009-1711	W/S	
306139		2009-1715	W/S	
306140		2009-1716	Mud Brick Sample	
		Phase:	6	Checked
				Initials 18 ii 09 Date HMM

**Sketch Drawings (in plan and in profile)**

Remember: do not just draw the architectural feature in isolation. Show how it relates to surrounding features and include details of surface treatments, repairs/modifications/damage, bonding material(s), and associated cuts. Annotate all aspects of the feature or use a Drawing Key. Measurements must be included for all aspects of the feature and surrounding features.

**Sketch Plan** - Include grid co-ordinates, North arrow, and elevations.

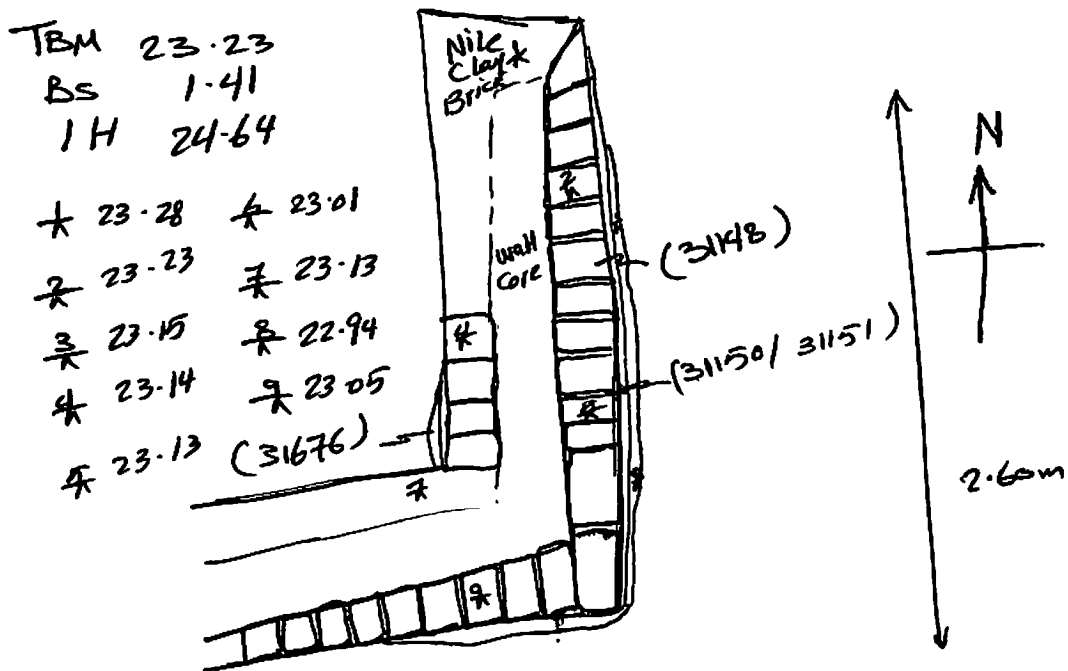

**Profile Sketch**

- State direction the elevation of the feature being drawn is facing e.g. 'West Facing Elevation of Feature ....
- If feature was drawn in section then include the grid co-ordinates and elevations.