

52

Site: GPMP KKT-N Area: 2009. GRID SQUARE(S) 201-E20 ARCHITECTURE FEATURE 31165

- 1. Material 4. Mudbrick
- 2. Size of materials 2/ - 3/ -
- 3. Finish
- 4. Coursing/bond 4/ - 3 COURSE OF BRICKS OF WALL WITH STRUCTURAL AND TWO COURSE OF BRICKS AS PARAPETS IN MIDDLE
- 5. Form 5/ DOOR BLOCKING
- 6. Direction of faces
- 7. Orientation 6/ - E-W
- 8. Dimensions 7/ - N-S
- 9. Associated collapse 8/ - LENGTH = 0.62m; WIDTH = 0.77m; HEIGHT = 0.27m
- 10. Foundations, cuts & fills 9/ - 10/ - 11/ - 12/ - 13/ - No 14/ -
- 11. Repaired 15/ - NICE CLAY 100%
- 12. Associated floors 16/ - " "
- 13. Plastered
- 14. Wall core 17/ - 390mm x 160mm x c. 90-100mm
- 15. Types of brick (%)
- 16. Composition of bricks
- 17. Dimensions of bricks (sample of three)

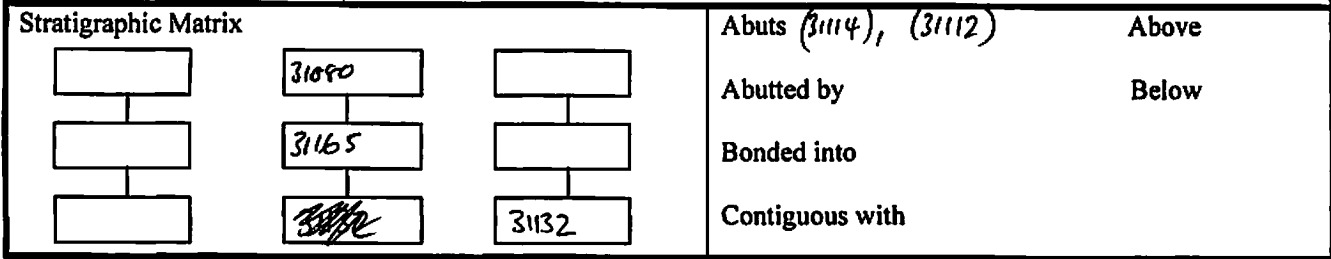

INTERPRETATION

	Enclosing	Internal	External
Reason for decay	CRACKING BETWEEN WALLS (31114) + (31112)		
Indications of original dimensions			
Indications of original functions	ONLY PARTIAL WALL EXCAVATED SO AS NOT TO LOSE STRUCTURAL INTEGRITY IN FOUNDATION.		

Associated contexts:

Context Same As:

Drawing Nos: 31165

Photographs (feature in plan, elevation, materials used, surface treatment e.g. plaster, paint etc.)		Finds		Samples (flotation, wet sieve, materials used e.g. bricks, stone, wood, bonding material etc.)	
		Bag No.	Description	Bag No.	Description
Photograph No.	Description				
		Phase:	S	Checked	Initials LMY Date 21 11 09

Sketch Drawings (in plan and in profile)

Remember: do not just draw the architectural feature in isolation. Show how it relates to surrounding features and include details of surface treatments, repairs/modifications/damage, bonding material(s), and associated cuts. Annotate all aspects of the feature or use a Drawing Key. Measurements must be included for all aspects of the feature and surrounding features.

Sketch Plan - Include grid co-ordinates, North arrow, and elevations.

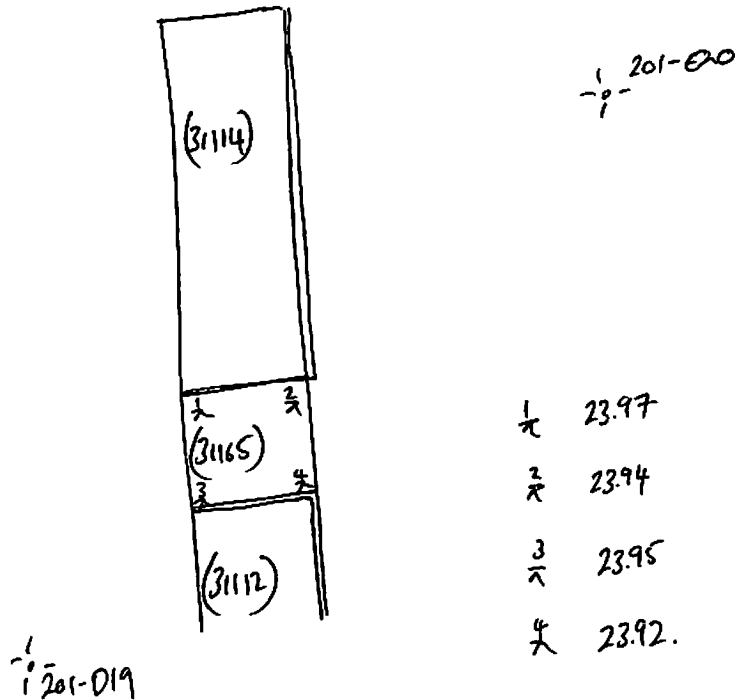

Profile Sketch

- State direction the elevation of the feature being drawn is facing e.g. 'West Facing Elevation of Feature
- If feature was drawn in section then include the grid co-ordinates and elevations.