

AREA: MVE	GRID SQUARE (S): 101-J22	GRID CO-ORDINATES: E N	INITIALS & DATE: HMM-MAR 24 ii 2011	FEATURE No.: 32885									
FEATURE TYPE (For example wall, staircase, bench, foundation structure, platform etc.): An earlier wall for MVE			Full extent visible in plan: YES / NO										
1. Dimensions (in metres)		Length: 0.84	Width: 0.09m	Height: 0.12m									
2. Type of material(s) used		Nile clay Brick											
3. Coursing (form of construction)		FOUR Courses stretcher											
4. Orientation		N-S											
5. Associated collapse		/											
6. Cut & fill feature #'s		/											
7. Repaired?		NO											
8. Associated floors		marl floor (32887)											
9. Surface treatments? E.g. plaster, paint, mouldings		mud Rendre (32886) plaster (32887)											
10. Size of one component		0.27m x 0.07m											
11. Bonding material		Light Brown silty sand											
12. Excavated		Yes/No <input checked="" type="checkbox"/> Yes											
Mini stratigraphic matrix <table border="1" style="width: 100%; text-align: center;"> <tr> <td style="width: 30%; height: 20px;"></td> <td style="width: 30%; height: 20px;">32886</td> <td style="width: 30%; height: 20px;"></td> </tr> <tr> <td></td> <td style="border-top: 1px solid black;">32887</td> <td></td> </tr> <tr> <td style="height: 20px;"></td> <td style="border-top: 1px solid black;">MVE</td> <td style="height: 20px;"></td> </tr> </table>			32886			32887			MVE		Abuts: Same as: Abutted by: Bonded into: Contiguous with: Associated features: mud Rendre (32886) plaster (32887)		
	32886												
	32887												
	MVE												
Discussion and interpretation: An earlier Nile clay wall for MVE, The wall has been coated by marl plaster + floor (32887)													

Remember: do not just draw the architectural feature in isolation. Show how it relates to surrounding features and include details of surface treatments, repairs/modifications/damage, bonding material(s), and associated cuts. Annotate all aspects of the feature or use a Drawing Key. Measurements must be included for all aspects of the feature and surrounding features.

Sketch Plan - Include grid co-ordinates, North arrow, and elevations.

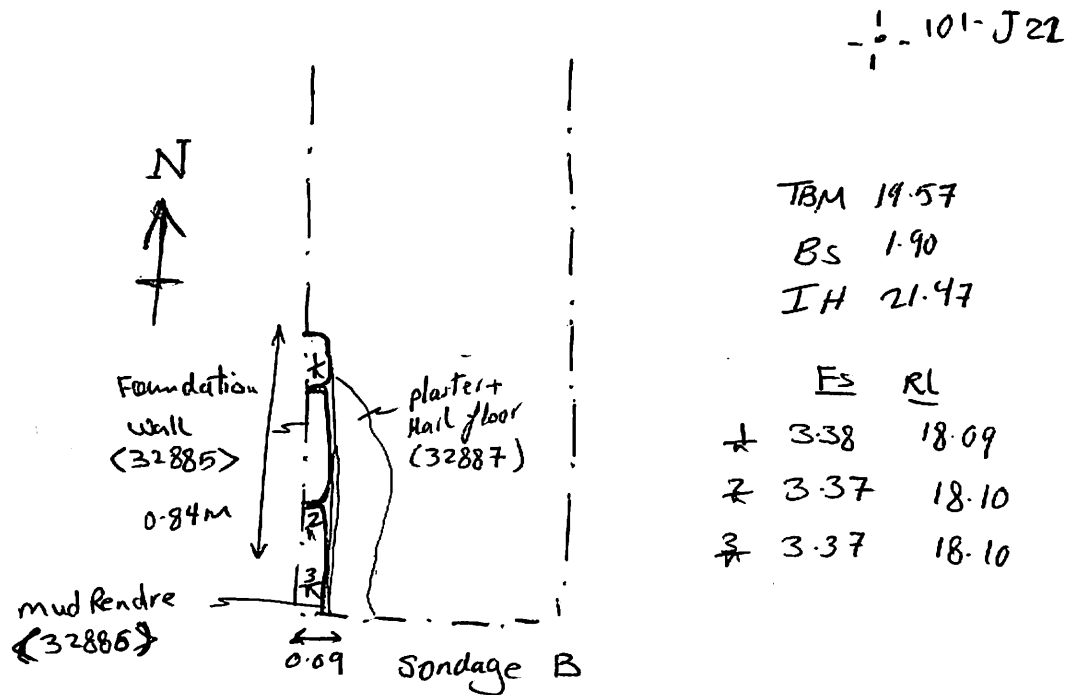

Profile Sketch - State direction the elevation of the feature being drawn is facing e.g. 'West Facing Elevation of Feature If feature was drawn in section then include the grid co-ordinates and elevations.

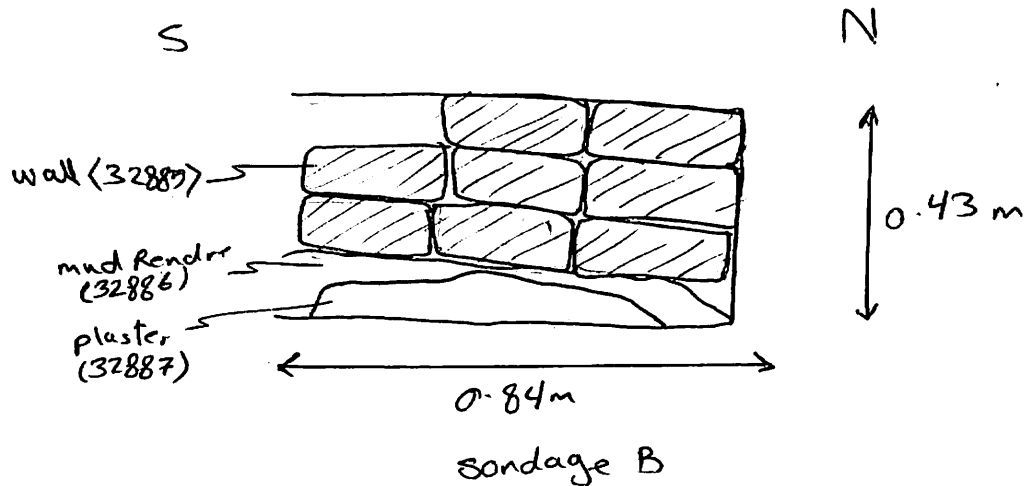

Drawing No.'s: (32885) 7 2011-98	Photo No.'s:
Space No.:	Structure No.:
Matrix Group:	Matrix Phase:
Samples taken:	