

AREA: <i>MVT-E</i>	GRID SQUARE (S): <i>K21,22</i> <i>J21,22</i>	GRID CO-ORDINATES: <i>E</i> <i>N</i>	INITIALS & DATE: <i>REM, MAR</i> <i>HMM/27/02</i>	FEATURE No.: <i>32907</i>
FEATURE TYPE (For example wall, staircase, bench, foundation structure, platform etc.): <i>wall</i>			Full extent visible in plan: <b>YES / NO</b> <input checked="" type="radio"/>	
1. Dimensions (in metres)		Length: <i>4.20</i>	Width: <i>2.20</i>	Height: <i>0.83 m</i>
2. Type of material(s) used		<i>Mud bricks</i>		
3. Coursing (form of construction)		<i>7 Courses ?</i>		
4. Orientation		<i>North / South</i>		
5. Associated collapse				
6. Cut & fill feature #'s		<i>32824, 3</i>		
7. Repaired?		<i>—</i>		
8. Associated floors		<i>32866</i>		
9. Surface treatments? E.g. plaster, paint, mouldings		<i>Plastered</i>		
10. Size of one component		<i>32cm x 20cm</i>		
11. Bonding material		<i>Sandy silt</i>		
12. Excavated		<b>Yes/No</b> <input checked="" type="radio"/>		
Mini stratigraphic matrix		Abuts: <b>Same as:</b>		
<pre> graph TD     A["(32907)"] --- B["(32866)"]     B --- C["(33136)"]     </pre>		Abuted by: <i>32860</i>		
		Bonded into:		
		Contiguous with: <i>32863, 33136.</i>		
Discussion and interpretation:				
<p><i>massive mud brick wall, it located at the southern end of the excavation area 'MVT-E'. it appeared to be a massive door jamb of the vestruiken tranche before the blocked wall which happened in later time</i></p> <p><i>COUNTERPART TO (32863) - ROSS ABUTTED BY (33136) BUT HEAVILY TRUNCATED.</i></p> <p><i>ROSS DEGRADED REMAINS OF BUTTBESS TO W. (NOT QUON SOP-REARLS #)</i></p>				

Remember: do not just draw the architectural feature in isolation. Show how it relates to surrounding features and include details of surface treatments, repairs/modifications/damage, bonding material(s), and associated cuts. Annotate all aspects of the feature or use a Drawing Key. Measurements must be included for all aspects of the feature and surrounding features.

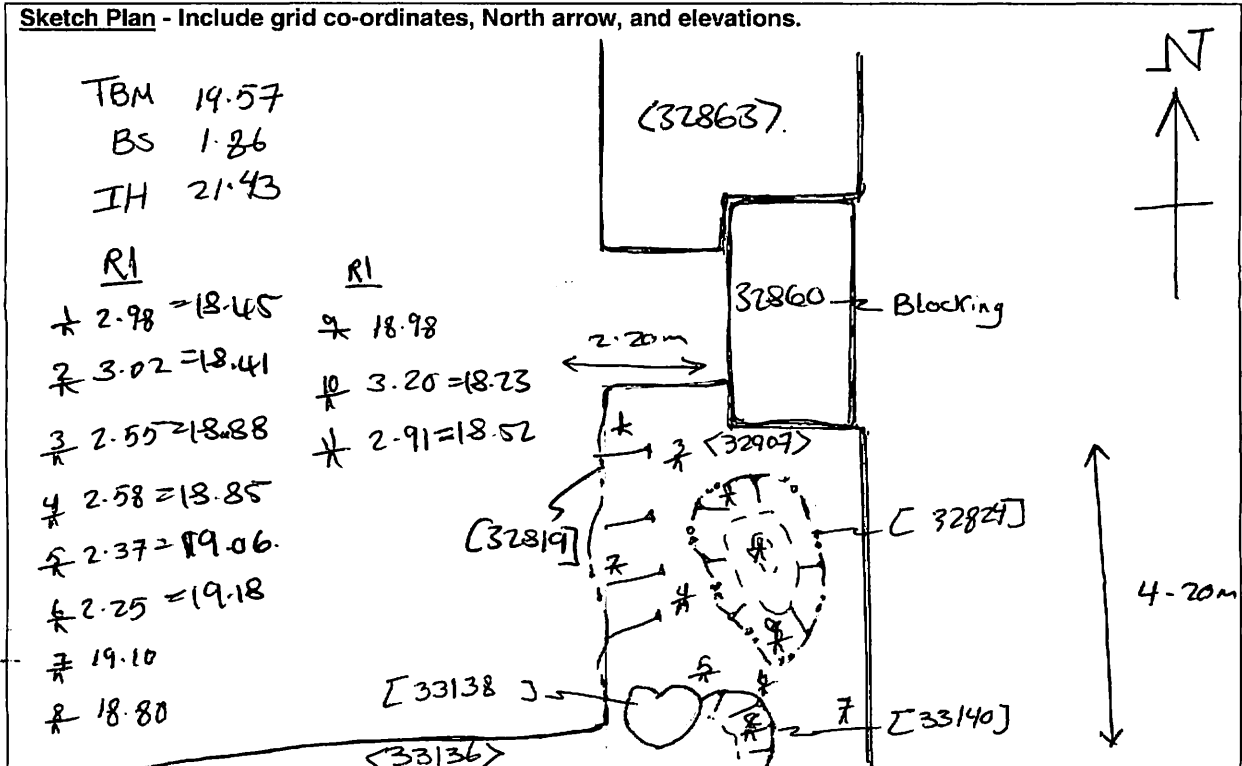

**Profile Sketch - State direction the elevation of the feature being drawn is facing e.g. 'West Facing Elevation of Feature .... If feature was drawn in section then include the grid co-ordinates and elevations.**

Drawing No.'s:	2011-92	Photo No.'s:	105104.
Space No.:	11122	Structure No.:	15169
Matrix Group:		Matrix Phase:	
Samples taken:			