

# GIZA PLATEAU MAPPING PROJECT

Grid Square(s) <b>201, H36</b>	Area <b>KKI-E</b>	Context Type <b>DEPOSIT</b>	Central Coords	Context <b>32925</b>
<b>DEPOSIT</b>		<b>CUT</b>		
1. Compaction	1. well compacted		1. Shape in plan	
2. Colour	2. mid grey brown		2. Corners	
3. Composition/Particle Size (Over 10%)	3. clayey silt		3. Dimension/Depth	
4. Inclusions (Under 10%) occa / mod / freq	4. small limestone, few yellow sand, & granite, mod pottery frag, broken mudbricks, acmrl fragments		4. Break of slope-top	
5. Thickness and extent	occ. large limestone occ. clastic		5. Sides	
6. Top and bottom boundaries	occ. root action		6. Break of slope-base	
7. Other comments	5. N-S : ~ 1.80 m		7. Base	
8. Method and conditions	E-W : ~ 1.30 m		8. Orientation	
	thickness: max 0.30 m		9. Inclination of axis	
	6. top delused bottom clear		10. Truncated (if known)	
	7. not fully excavated; previously observed in W-facing section of slot B		11. Fill #s	
	8. mid size gravel, silt		12. Other comments Draw profile overleaf	

Type of feature:

Stratigraphic Matrix

			<b>32913</b>							
This context is			<b>32925 = 32408</b>							
			<b>32928</b>							

Your interpretation:     Internal     External     Structural     Other (specify)

Your discussion:    This deposit is a make up for the upper level corner  
 → very uneven (large limestone of 32913 pressed into it), consisting of broken mudbricks/marble, contains limestone, but visibly less than (32913). Some of the broken bricks appear to have either marl & render or lime wash.  
 Rests on top of marl crush (32928)

Placement in square

Context same as: <b>32408</b>	See contexts:	
Site Book Refs:	Matrix phase:	Initials and date <b>Ko 7/02/2011</b>
Checked Interpretation:		
Provisional period	Group/Phase	Initials and date

Context Number

32925

GPMP

2011

Bag Numbers

Ceramics

2011-958

Objects

Environmental Samples & Type

2011-957 (2x Shovels for wet sieving)

Exotics

GRANITE (see exotics register)

Charcoal

2011-959

Other

Flint

Stones

Photographs

26/613194  
27/613195  
camera set (6)

Drawings

Plans

32925

Sections

2011-270

Top Elevation

17.14

Bottom Elevations

16.84

Site Plan

BL A

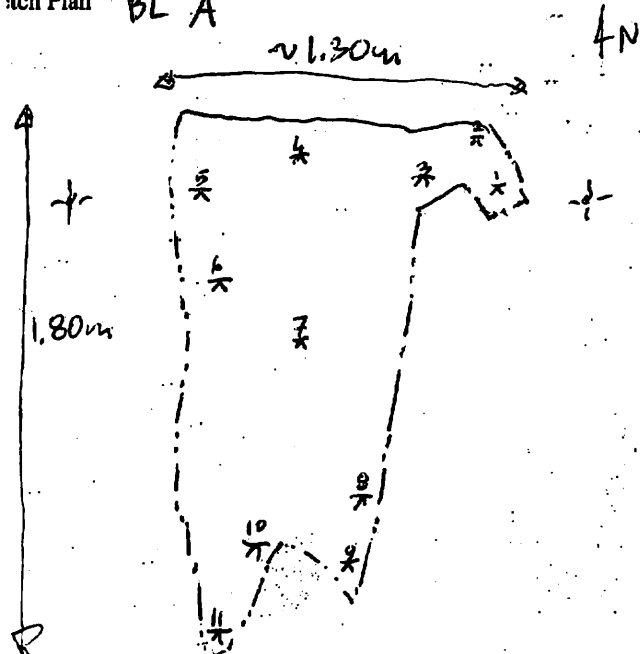

Top	17.68
DS	17.21
1H	16.89

FS	RL
1. 2.87	17.02
2. 2.83	17.06
3. 2.75	17.14
4. 2.88	17.01
5. 2.92	16.97
6. 2.87	17.02
7. 2.86	17.03
8. 2.79	17.10
9. 3.05	16.84
10. 2.91	16.98
11. 2.79	17.10