

GIZA PLATEAU MAPPING PROJECT

Grid Square(s) 201-C35	Area KKT-E	Context Type CUT	Central Coords	Context 33028																																	
DEPOSIT				CUT																																	
1. Compaction 2. Colour 3. Composition/Particle Size (Over 10%) 4. Inclusions (Under 10%) occa / mod / freq 5. Thickness and extent 6. Top and bottom boundaries 7. Other comments 8. Method and conditions	1) LINEAR	1. Shape in plan 2. Corners 3. Dimension/Depth 4. Break of slope-top 5. Sides 6. Break of slope-base 7. Base 8. Orientation 9. Inclination of axis 10. Truncated (if known) 11. Fill #s 12. Other comments Draw profile overleaf																																			
	2) UNKNOWN																																				
	3) LENGTH: 8.30m WIDTH: 0.58m DEPTH: 0.54m																																				
	4) UNKNOWN																																				
	5) VERY GRADUAL																																				
	6) GRADUAL																																				
	7) FLAT																																				
	8) NW/SE																																				
	9) N/A																																				
	10) TRUNCATED BY LATER QUARRY CUT [32975] AND EVEN LATER SLR SURFACE CUT [32958]																																				
11) LATER SLR SURFACE DEPOSITS																																					
Type of feature: QUARRY CUT																																					
Stratigraphic Matrix																																					
<table style="width: 100%; border-collapse: collapse;"> <tr> <td style="border: 1px solid black; width: 20px; height: 20px;"></td> <td style="border: 1px solid black; width: 20px; height: 20px;"></td> <td style="border: 1px solid black; width: 20px; height: 20px;"></td> <td style="border: 1px solid black; width: 20px; height: 20px; text-align: center;">32975</td> <td style="border: 1px solid black; width: 20px; height: 20px;"></td> <td style="border: 1px solid black; width: 20px; height: 20px;"></td> <td style="border: 1px solid black; width: 20px; height: 20px;"></td> <td style="border: 1px solid black; width: 20px; height: 20px;"></td> <td style="border: 1px solid black; width: 20px; height: 20px;"></td> <td style="border: 1px solid black; width: 20px; height: 20px;"></td> <td style="border: 1px solid black; width: 20px; height: 20px;"></td> </tr> <tr> <td colspan="3" style="text-align: center;">This context is</td> <td style="border: 1px solid black; width: 20px; height: 20px; text-align: center;">33028</td> <td colspan="7"></td> </tr> <tr> <td style="border: 1px solid black; width: 20px; height: 20px;"></td> <td style="border: 1px solid black; width: 20px; height: 20px;"></td> <td style="border: 1px solid black; width: 20px; height: 20px;"></td> <td style="border: 1px solid black; width: 20px; height: 20px; text-align: center;">32418</td> <td style="border: 1px solid black; width: 20px; height: 20px;"></td> <td style="border: 1px solid black; width: 20px; height: 20px;"></td> <td style="border: 1px solid black; width: 20px; height: 20px;"></td> <td style="border: 1px solid black; width: 20px; height: 20px;"></td> <td style="border: 1px solid black; width: 20px; height: 20px;"></td> <td style="border: 1px solid black; width: 20px; height: 20px;"></td> <td style="border: 1px solid black; width: 20px; height: 20px;"></td> </tr> </table>				32975								This context is			33028											32418											
			32975																																		
This context is			33028																																		
			32418																																		
Your interpretation:	Internal	External	Structural	Other (specify)																																	
Your discussion:																																					
<p>CUT INTO LIMESTONE BEDROCK (32418) TO REMOVE BLOCKS OF STONE</p>				Placement in square <div style="border: 1px solid black; width: 100%; height: 100%;"></div>																																	
Context same as:			See contexts:																																		
Site Book Refs:			Matrix phase:																																		
			Initials and date DCS 19/03/2011																																		
Checked Interpretation:																																					
Provisional period			Group/Phase																																		
			Initials and date																																		

Context Number [33028] GPMP 2011

Bag Numbers

Ceramics	Objects
Environmental Samples & Type	Exotics
Charcoal	
Bones	Other
Lithics	

Photographs 306838
306839
306840
306841

Drawings

Plans 2011-128 Sections /

Top Elevation 17.12 Bottom Elevations 16.56

Sketch Plan

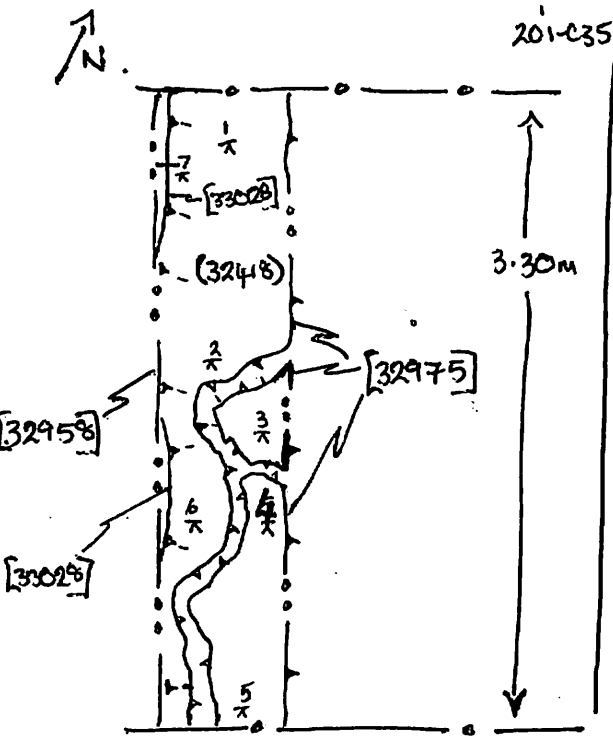

SKETCH PROFILE

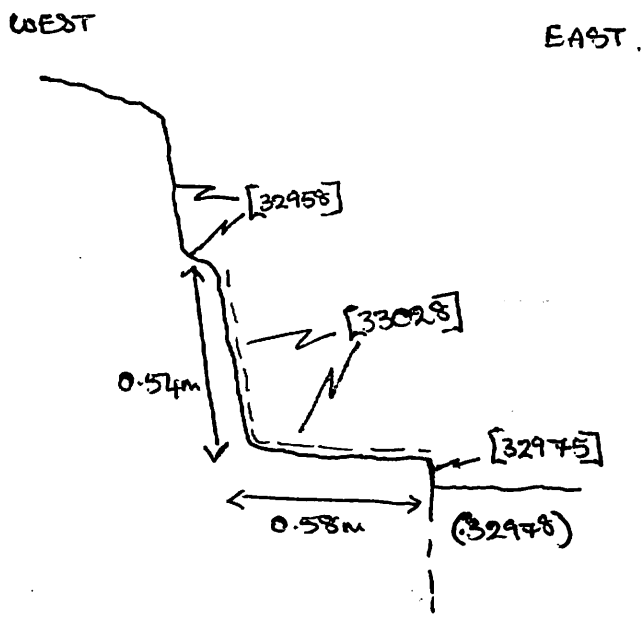

TBM: 17.68
BS: 1.21
IH: 18.89

TBM: 17.68
BS: 1.23
IH: 18.91

FS	RL	FS	RL
1 2.31	16.58	4 2.32	16.57
2 2.30	16.59	5 2.20	16.69
3 2.28	16.61	6 2.27	16.62

FS	RL
7 1.79	17.12