

AREA: MVT-E	GRID SQUARE (S): 101-M 22	GRID CO-ORDINATES: E N	INITIALS & DATE: MAR-MAAG 31 I 2012	FEATURE No.: 33114									
FEATURE TYPE (For example wall, staircase, bench, foundation structure, platform etc.): Mud brick wall / BUTTRESS.			Full extent visible in plan: YES / NO										
1. Dimensions (in metres)	Length: 0.70 M	Width: 0.75 M 0.46m	Height: 0.20 M										
2. Type of material(s) used	Mud brick												
3. Coursing (form of construction)	Visible two coursing 1- header 1- stretch												
4. Orientation	East - west												
5. Associated collapse	(32768)												
6. Cut & fill feature #'s	—												
7. Repaired?	—												
8. Associated floors	(33110) - (33127)? N/A (MUSE)												
9. Surface treatments? E.g. plaster, paint, mouldings	FOUR FLOOR SCALE BY WALL (33114)												
10. Size of one component	0.43M length x 0.20M width x 0.09M height												
11. Bonding material	Sandy silt w/ sm. ANG - GRAVEL. (MUD GRAY-BROWN)												
12. Excavated	Yes <input checked="" type="checkbox"/> No <input type="checkbox"/>												
Mini stratigraphic matrix		Abuts: (33117) Same as:											
<table border="1" style="width: 100%; text-align: center;"> <tr> <td style="width: 30%; height: 30px;"></td> <td style="width: 30%; height: 30px;">(32782)</td> <td style="width: 30%; height: 30px;"></td> </tr> <tr> <td></td> <td style="border-top: 1px solid black; height: 30px;">33114</td> <td></td> </tr> <tr> <td></td> <td style="border-top: 1px solid black; height: 30px;">33117</td> <td></td> </tr> </table>			(32782)			33114			33117		Abutted by:		
	(32782)												
	33114												
	33117												
		Bonded into:											
		Contiguous with:											
		Associated features: 33118 FOUNDATION MATERIAL.											
Discussion and interpretation:													
<p>not fully excavated</p> <p>interior East-west mud brick wall separated between spalls (11205) and in the north and spall (11206) to the south</p> <p>Firing activity on the north face</p> <p>- PART OF LATER PHASE OF SETTLEMENT WITHIN ANNOX TOWN.</p>													

A. 11/12.

Remember: do not just draw the architectural feature in isolation. Show how it relates to surrounding features and include details of surface treatments, repairs/modifications/damage, bonding material(s), and associated cuts. Annotate all aspects of the feature or use a Drawing Key. Measurements must be included for all aspects of the feature and surrounding features.

Sketch Plan - Include grid co-ordinates, North arrow, and elevations.

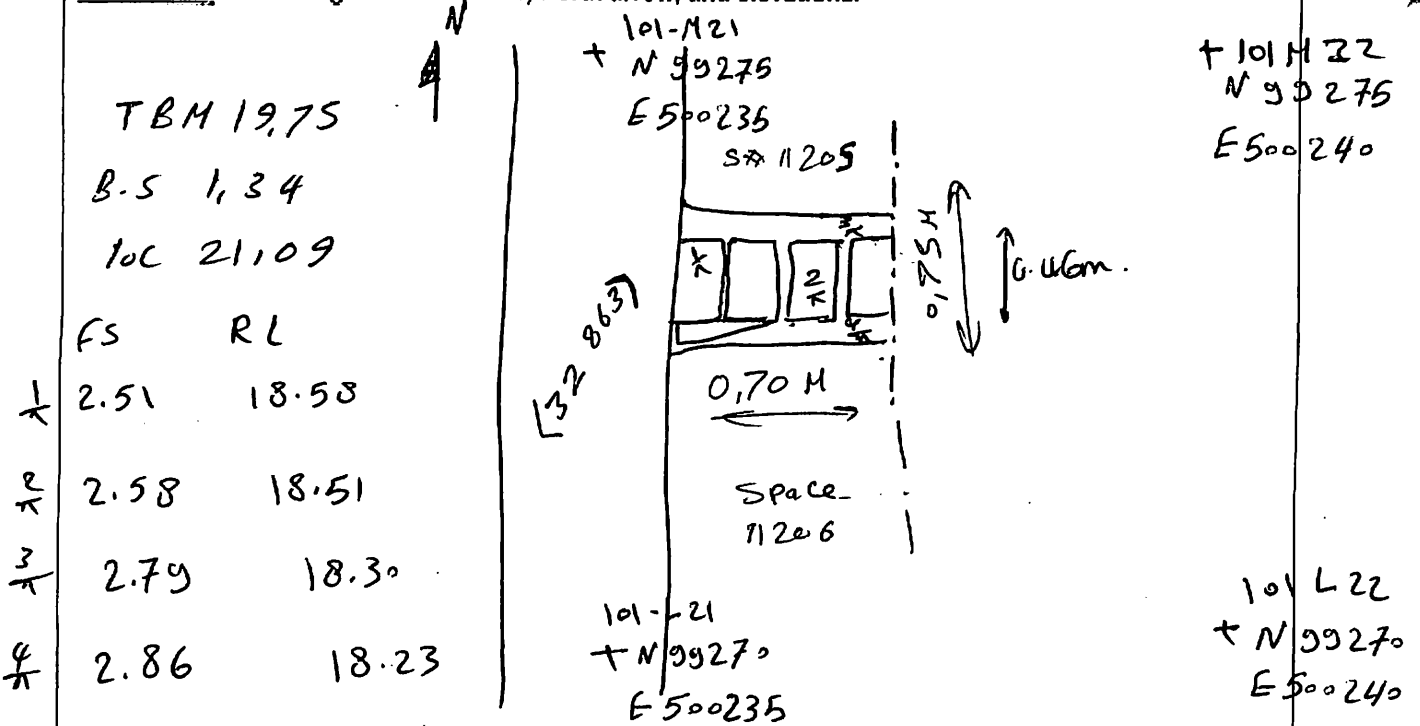

Profile Sketch - State direction the elevation of the feature being drawn is facing e.g. 'West Facing Elevation of Feature If feature was drawn in section then include the grid co-ordinates and elevations.

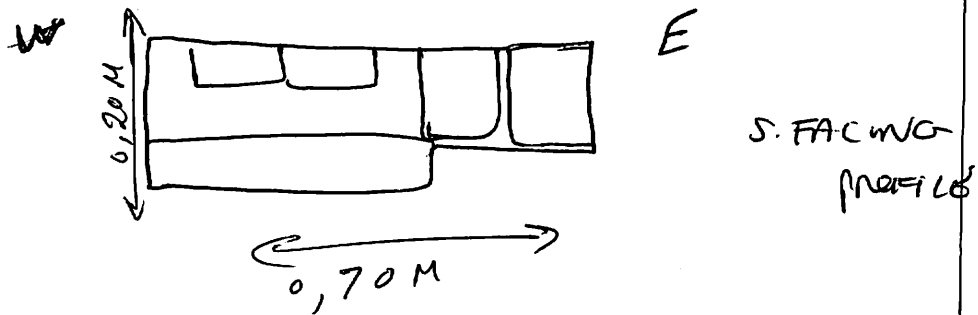

512707.708-709

Drawing No.'s:	{3314} + 2012-41	Photo No.'s:	512773-512774-512775-512776-512777
Space No.:	between S# 11205-11206	Structure No.:	
Matrix Group:		Matrix Phase:	
Samples taken:			