

14-L22

# GIZA PLATEAU MAPPING PROJECT

Grid Square(s) <b>1A-M 22</b>	Area <b>MVTE</b>	Context Type <b>deposit</b>	Central Coords	Context <b>(33119)</b>	
<b>DEPOSIT</b>				<b>CUT</b>	
1. Compaction	<b>F Mod</b>		1. Shape in plan		
2. Colour	<b>2- ONA's-R BROWN</b>		2. Corners		
3. Composition/Particle Size (Over 10%)	<b>3- made for 1:5 silt 30%</b>		3. Dimension/Depth		
4. Inclusions (Under 10%) occa / mod / freq	<b>4- —</b>		4. Break of slope-top		
5. Thickness and extent	<b>5- 0.90 m length R x 0.05 m width</b>		5. Sides		
6. Top and bottom boundaries	<b>x 2.2 m thick</b>		6. Break of slope-base		
7. Other comments	<b>6 Clear</b>		7. Base		
8. Method and conditions	<b>7 —</b>		8. Orientation		
		<b>8- sand Axe - SUNG</b>		9. Inclination of axis	
		<b>(5) FULL LENGTH AS SEEN = 2.90m (N-S)</b>		10. Truncated (if known)	
		<b>x 10mm thickness.</b>		11. Fill #s	
				12. Other comments Draw profile overleaf	

Type of feature: **Plaster (render) SURFACE TREATMENT.**

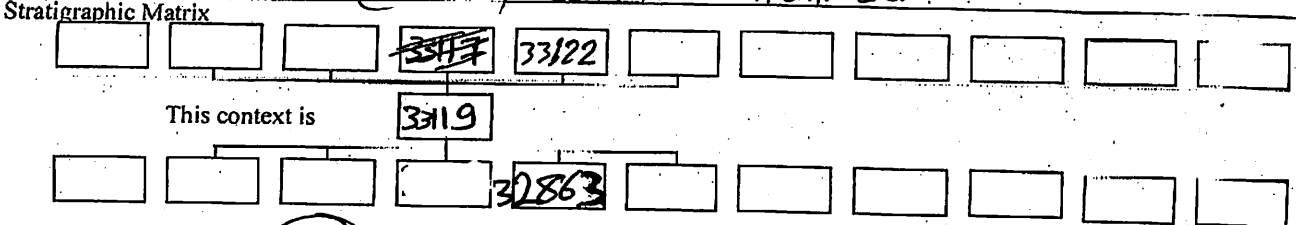

Your interpretation:  Internal    External     Structural    Other (specify)

Your discussion:  
**Plaster covered The wall <32863>**  
 The dimensions relate to section seen in sondage but probably continue along whole East face of wall <32863>

Placement in square

Context same as:	See contexts:	
Site Book Refs:	Matrix phase:	Initials and date <b>MAR-31-2012</b>
Checked Interpretation:		
Provisional period	Group/Phase	Initials and date <b>12 ii 12.</b>

Context Number 33119

GPMP MVT-E 2012

Bag Numbers

Ceramics

Objects

Environmental Samples & Type

Exotics

Charcoal

Other

Bones

Lithics

Photographs

512606, 512607, 512608

Drawings

Plans

Sections

P\* 33119

Top Elevation

18.88 MASL

Bottom Elevations

18.63 MASL

Sketch Plan

TBM. 19.75

B.S. 1.41

LOC 21.16

Fs RL

\* 2.28 18.88

\* 2.53 18.63

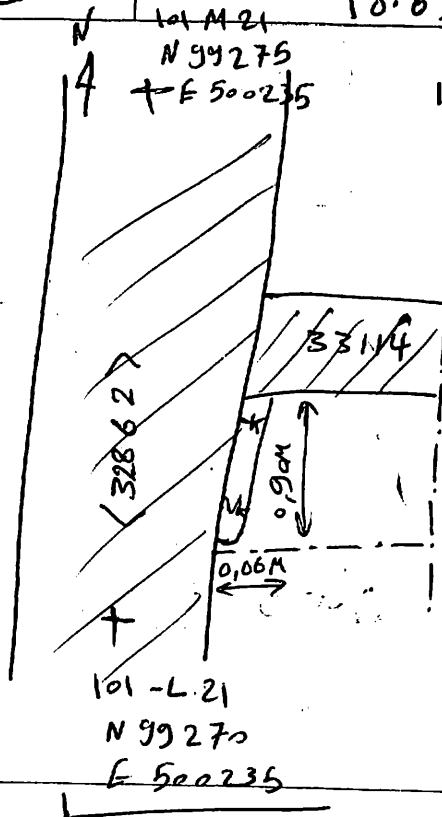

101 M 22  
N 99276  
E 500240

101-L 22  
N 99270  
E 500240

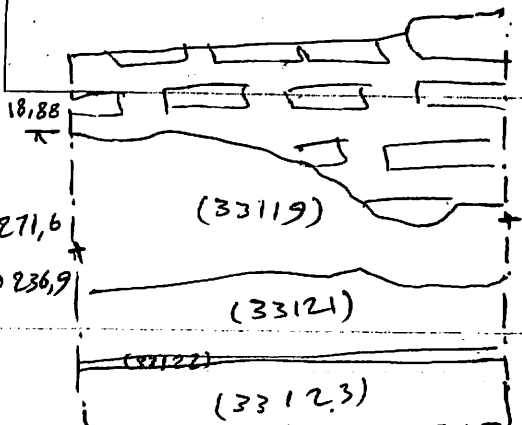

N 99272,37  
E 500536.92