

AREA: Kkt-E7	GRID SQUARE (S): I 44, 45, 46, 47 J 45, 46, 47	GRID CO-ORDINATES: E N	INITIALS & DATE: AKOA 9 March 2012	FEATURE No.: 33262
FEATURE TYPE (For example wall, staircase, bench, foundation structure, platform etc.):			Full extent visible in plan: YES / NO	
1. Dimensions (in metres)	Length: 16m	Width: 2.20m	Height: 0.50m	
2. Type of material(s) used				
3. Coursing (form of construction)				
4. Orientation	East-west			
5. Associated collapse				
6. Cut & fill feature #'s				
7. Repaired?				
8. Associated floors				
9. Surface treatments? E.g. plaster, paint, mouldings				
10. Size of one component				
11. Bonding material				
12. Excavated	Yes/No			
Mini stratigraphic matrix <pre>                 graph TD                 A[34042] --- B[ ]                 B --- C[33262]                 C --- D[NFE]                 E[ ] --- F[34057]                 </pre>		Abuts: 33423	Same as:	
		Abutted by:	Associated features:	
		Bonded into:		
		Contiguous with:		
Discussion and interpretation: - east-west massive Nile clay brick northern enclosure wall (33262) of silo building complex. Forms the north limit of spaces (11239, 11250)				

Remember: do not just draw the architectural feature in isolation. Show how it relates to surrounding features and include details of surface treatments, repairs/modifications/damage, bonding material(s), and associated cuts. Annotate all aspects of the feature or use a Drawing Key. Measurements must be included for all aspects of the feature and surrounding features.

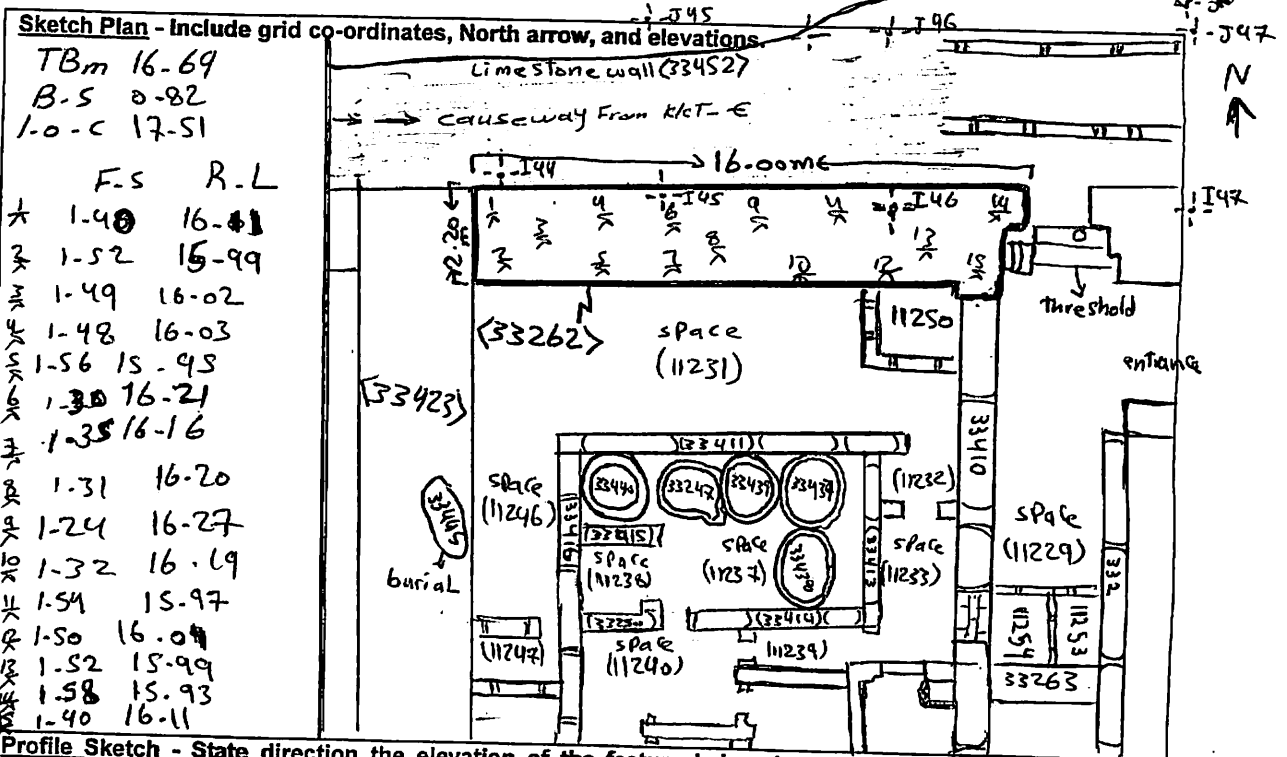

**Profile Sketch** - State direction the elevation of the feature being drawn is facing e.g. 'West Facing Elevation of Feature .... If feature was drawn in section then include the grid co-ordinates and elevations.

Drawing No.'s:	Photo No.'s:
Space No.: 11231-11250-	Structure No.:
Matrix Group:	Matrix Phase:
Samples taken:	