

AREA: Kkt-N	GRID SQUARE (S): 201C 17, 16, 15	GRID CO-ORDINATES: E N	INITIALS & DATE: SAER AFAM 22-1-2012	FEATURE No.: 33288
FEATURE TYPE (For example wall, staircase, bench, foundation structure, platform etc.): wall			Full extent visible in plan: <input checked="" type="radio"/> YES / NO	
1. Dimensions (in metres)	Length: 10.28 m	Width: 1.02 m	Height: 0.20 m (NFE)	
2. Type of material(s) used	mud brick			
3. Coursing (form of construction)	three courses			
4. Orientation	E - W			
5. Associated collapse	<del>—</del>			
6. Cut & fill feature #'s	<del>—</del>			
7. Repaired?	<del>—</del>			
8. Associated floors	<del>—</del>			
9. Surface treatments? E.g. plaster, paint, mouldings	(33287), (33285)			
10. Size of one component	40cm x 20cm			
11. Bonding material	sandy silt			
12. Excavated	Yes/No			
Mini stratigraphic matrix		Abuts: Same as:		
<div style="display: flex; justify-content: space-around;"> <div style="border: 1px solid black; padding: 2px;">33289</div> <div style="border: 1px solid black; padding: 2px;">33291</div> <div style="border: 1px solid black; padding: 2px;">33286</div> </div> <div style="text-align: center; margin: 5px 0;"> <div style="border: 1px solid black; padding: 2px;">33288</div> </div> <div style="display: flex; justify-content: space-around; margin-top: 10px;"> <div style="border: 1px solid black; width: 40px; height: 20px;"></div> <div style="border: 1px solid black; width: 40px; height: 20px;"></div> <div style="border: 1px solid black; width: 40px; height: 20px;"></div> </div>		Abutted by: <33289> <33291> Bonded into: <33285> Contiguous with:		
Associated features: (33287) (33285)				
Discussion and interpretation:				
<p>E-W mudbrick wall the main southern wall of house (C).</p> <p>The part which forms the southern wall of room (44) is a clear courses of mudbrick three courses the northern face is stretchers and the other two courses are headers, but the second part which forms the southern wall of rooms (50 and 51) not clear.</p> <p>the wall is represent the southern limit of spaces ( ) and it abutted by 33289 and 33291 (11289-11286-11285)</p>				

Remember: do not just draw the architectural feature in isolation. Show how it relates to surrounding features and include details of surface treatments, repairs/modifications/damage, bonding material(s), and associated cuts. Annotate all aspects of the feature or use a Drawing Key. Measurements must be included for all aspects of the feature and surrounding features.

**Sketch Plan** - Include grid co-ordinates, North arrow, and elevations.

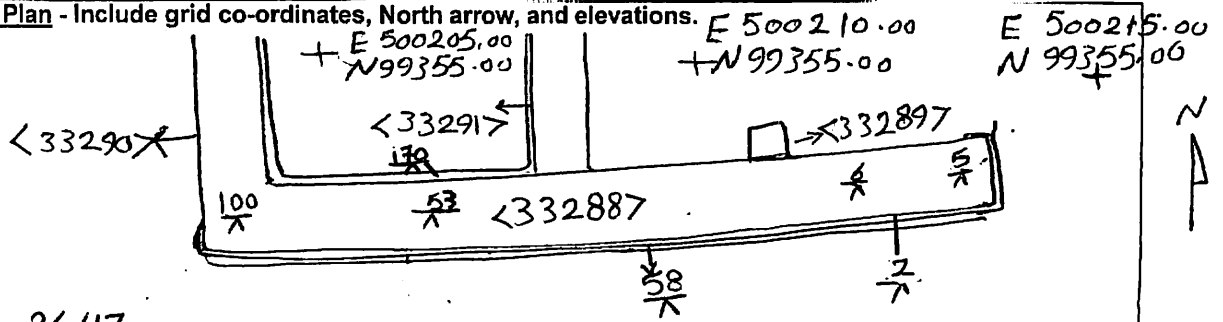

TBm 26.47  
BS 0.29  
Loc 26.76

Fs RL

Fs RL

2	2.55	24.21
5	2.50	24.26
6	2.40	24.36
53	2.09	24.67
58	2.43	24.33

100	2.00	24.76
-----	------	-------

N 99355.00  
+ E 500215.00

**Profile Sketch** - State direction the elevation of the feature being drawn is facing e.g. 'West Facing'. Elevation of Feature .... If feature was drawn in section then include the grid co-ordinates and elevations.

Drawing No.'s: 2012-1	Photo No.'s: 512489
Space No.: 11285 - 11289 - 11286	Structure No.: house (C)
Matrix Group:	Matrix Phase: 4a
Samples taken:	