

AREA: KKT-N	GRID SQUARE (S): 201 D 16 201 C 16	GRID CO-ORDINATES: E N	INITIALS & DATE: AFAM SAER 22/1/2012	FEATURE No.: 33291
FEATURE TYPE (For example wall, staircase, bench, foundation structure, platform etc.): Wall			Full extent visible in plan: YES / NO <input checked="" type="checkbox"/>	
1. Dimensions (in metres) 21	Length: 2.10 m	Width: 0.59 m	Height: 0.20 m	
2. Type of material(s) used	mud brick			
3. Coursing (form of construction)	two courses			
4. Orientation	N-S			
5. Associated collapse	-			
6. Cut & fill feature #'s	-			
7. Repaired?	-			
8. Associated floors	-			
9. Surface treatments? E.g. plaster, paint, mouldings	(33290)			
10. Size of one component	40 cm x 20 cm			
11. Bonding material	sandy silt			
12. Excavated	Yes/No <input checked="" type="checkbox"/>			
Mini stratigraphic matrix 		Abuts: <33288> Same as: Abutted by: <33292> Associated features: (33290) Bonded into: Contiguous with:		
Discussion and interpretation: mud brick wall <33291> orientated from North to south abuts the northern face of <33288> It is consist of two courses one headers and one strecher. the wall itself abutted by the E-S wall <33292> and it covered with desert crushed mark plaster from the western face (33290)				

Remember: do not just draw the architectural feature in isolation. Show how it relates to surrounding features and include details of surface treatments, repairs/modifications/damage, bonding material(s), and associated cuts. Annotate all aspects of the feature or use a Drawing Key. Measurements must be included for all aspects of the feature and surrounding features.

Sketch Plan - Include grid co-ordinates, North arrow, and elevations.

TBM 26.47

Bs 0.29

Loc 26.76

Fs RL

~~2.12~~ 24.64

~~2.09~~ 24.67

~~2.17~~ 24.59

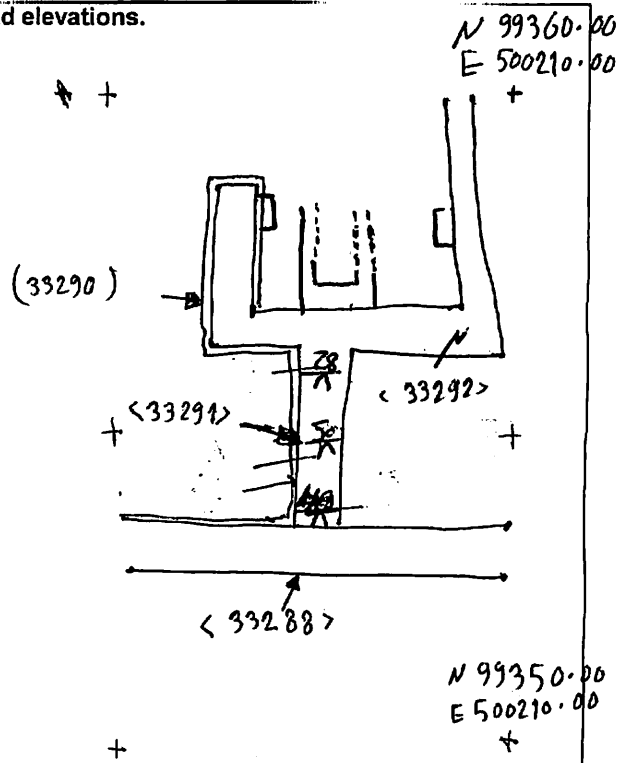

~~2.12~~  
~~4.18~~  
~~5.02~~

Profile Sketch - State direction the elevation of the feature being drawn is facing e.g. 'West Facing Elevation of Feature .... If feature was drawn in section then include the grid co-ordinates and elevations.

Drawing No.'s: 2012-1

Photo No.'s: 512459, 512460

Space No.: 11285-11289

Structure No.: house C

Matrix Group:

Matrix Phase: 4b

Samples taken: