

AREA: Kkt.N	GRID SQUARE (S): 201D16	GRID CO-ORDINATES: E N	INITIALS & DATE: SAER AFAM 23/2/2012	FEATURE No.: 33296
FEATURE TYPE (For example wall, staircase, bench, foundation structure, platform etc.): Potential hearth			Full extent visible in plan: YES / NO	
1. Dimensions (in metres)	Length: 1.05 m	Width: 0.96 m	Height: 0.15 m	
2. Type of material(s) used	mud brick			
3. Coursing (form of construction)	Not visible details			
4. Orientation	N-S			
5. Associated collapse	-			
6. Cut & fill feature #'s	-			
7. Repaired?	-			
8. Associated floors	-			
9. Surface treatments? E.g. plaster, paint, mouldings	-			
10. Size of one component	0.40 m x 2.0 m x 0.10 m			
11. Bonding material	sandy silt			
12. Excavated	Yes/No			
Mini stratigraphic matrix 		Abuts: <332927 Same as: Abutted by: Associated features: Bonded into: Contiguous with:		
Discussion and interpretation: Potential hearth related to modification phase because we found plaster layer between this <del>with</del> hearth <33296> and wall <332927> -this <del>with</del> eroded hearth				

Remember: do not just draw the architectural feature in isolation. Show how it relates to surrounding features and include details of surface treatments, repairs/modifications/damage, bonding material(s), and associated cuts. Annotate all aspects of the feature or use a Drawing Key. Measurements must be included for all aspects of the feature and surrounding features.

Sketch Plan - Include grid co-ordinates, North arrow, and elevations.

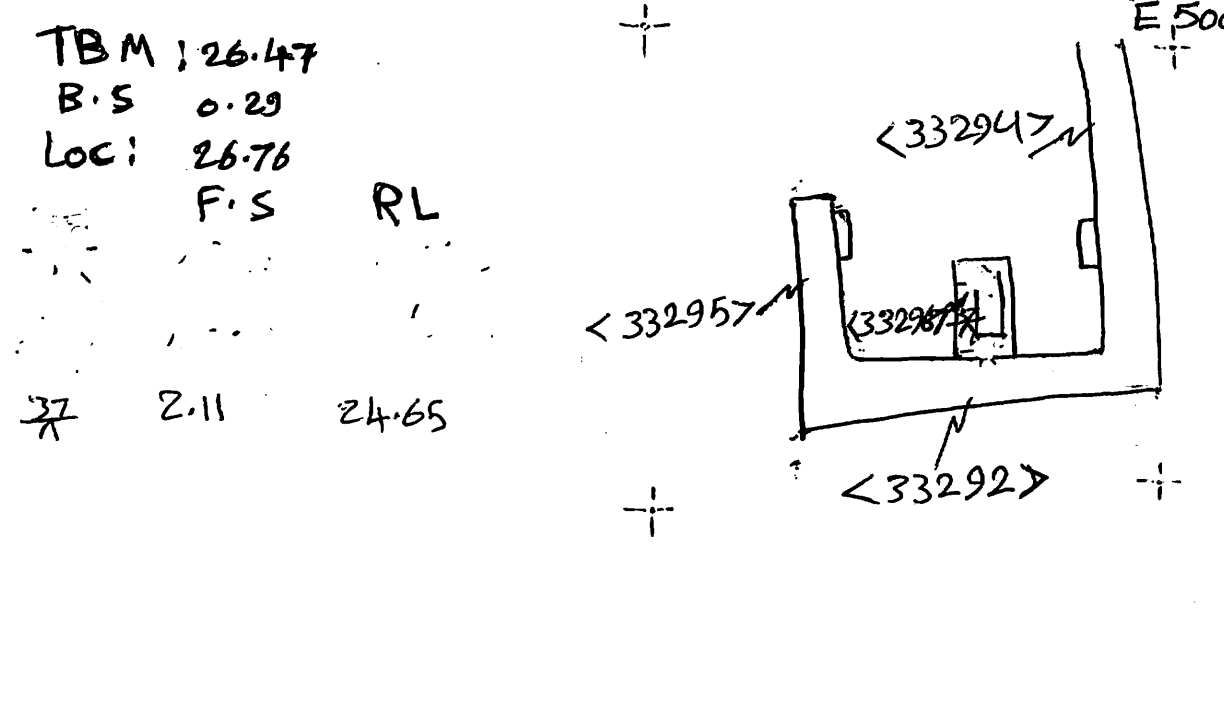

Profile Sketch - State direction the elevation of the feature being drawn is facing e.g. 'West Facing Elevation of Feature .... If feature was drawn in section then include the grid co-ordinates and elevations.

Drawing No.'s: 2012-1	Photo No.'s: 512477, 512478
Space No.: 11288	Structure No.: house (C)
Matrix Group:	Matrix Phase: 6
Samples taken:	