

AREA: KKT.N	GRID SQUARE (S): 201D16	GRID CO-ORDINATES: E N	INITIALS & DATE: AFAM 23 i 2012	FEATURE No.: 33297									
FEATURE TYPE (For example wall, staircase, bench, foundation structure, platform etc.): wall			Full extent visible in plan: <input checked="" type="radio"/> YES / NO										
1. Dimensions (in metres)		Length: 1.16M	Width: 0.84M	Height: 0.04M									
2. Type of material(s) used		mud brick.											
3. Coursing (form of construction)		Two courses											
4. Orientation		E-W											
5. Associated collapse		—											
6. Cut & fill feature #'s		—											
7. Repaired?		—											
8. Associated floors		—											
9. Surface treatments? E.g. plaster, paint, mouldings		—											
10. Size of one component		0.40M by 0.20M											
11. Bonding material		Sandy silt											
12. Excavated		Yes/No Not Excavated											
Mini stratigraphic matrix		Abuts: <33298> Same as:											
<table border="0"> <tr> <td style="border: 1px solid black; width: 40px; height: 20px;"></td> <td style="border: 1px solid black; width: 40px; height: 20px; text-align: center;">33324</td> <td style="border: 1px solid black; width: 40px; height: 20px; text-align: center;">33290</td> </tr> <tr> <td></td> <td style="border: 1px solid black; width: 40px; height: 20px; text-align: center;">33297</td> <td></td> </tr> <tr> <td style="border: 1px solid black; width: 40px; height: 20px;"></td> <td style="border: 1px solid black; width: 40px; height: 20px; text-align: center;">33298</td> <td style="border: 1px solid black; width: 40px; height: 20px;"></td> </tr> </table>			33324	33290		33297			33298		Abutted by: (33324) Associated features:		
	33324	33290											
	33297												
	33298												
		Bonded into: < 33297 >											
		Contiguous with:											
Discussion and interpretation:													
<p>the wall is made of mud brick, it's consists of two courses the Northern face is stretcher and the southern face is header its dimension from E-W, wall <33297> is the southern wall to room 4#¹¹²⁹³ and the northern wall to Room 4# 11289 ,</p> <p>The wall is coated with plaster layer from the southern side number (33307) ..</p> <p>the wall is bonding into wall <33298></p>													

Remember: do not just draw the architectural feature in isolation. Show how it relates to surrounding features and include details of surface treatments, repairs/modifications/damage, bonding material(s), and associated cuts. Annotate all aspects of the feature or use a Drawing Key. Measurements must be included for all aspects of the feature and surrounding features.

Sketch Plan - Include grid co-ordinates, North arrow, and elevations.

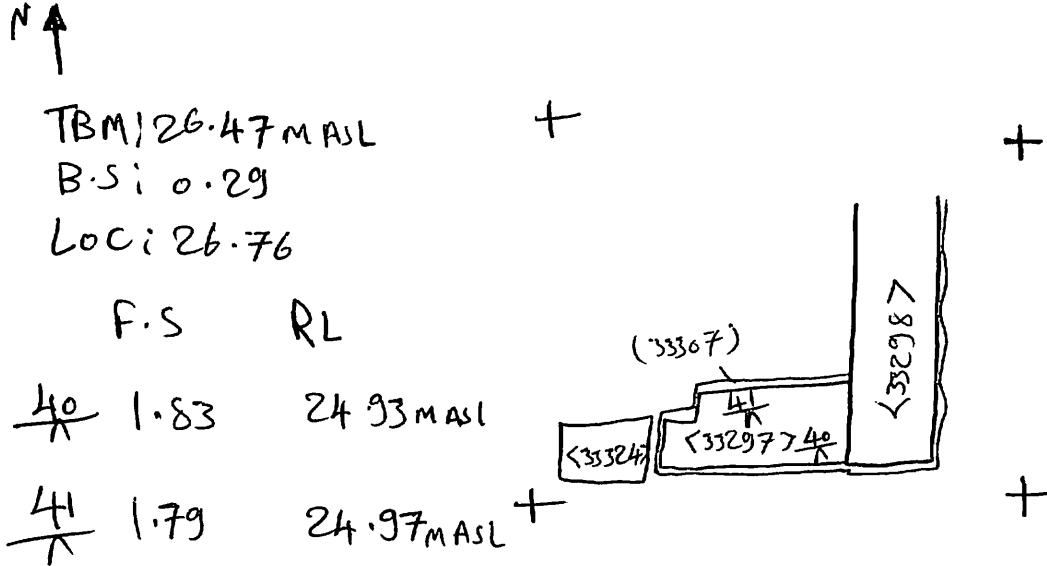

Profile Sketch - State direction the elevation of the feature being drawn is facing e.g. 'West Facing Elevation of Feature If feature was drawn in section then include the grid co-ordinates and elevations.

Drawing No.'s: 2012-1	Photo No.'s: 512727
Space No.: 112923 11288-11293	Structure No.: House C
Matrix Group:	Matrix Phase: 4b
Samples taken:	