

AREA: KKT-N	GRID SQUARE (S): 201 E15,16	GRID CO-ORDINATES: E N	INITIALS & DATE: EMS 23/2012	FEATURE No.: 33321															
FEATURE TYPE (For example wall, staircase, bench, foundation structure, platform etc.): wall			Full extent visible in plan: <input checked="" type="radio"/> YES / NO																
1. Dimensions (in metres)		Length: 2.7 m	Width: 0.6 m	Height: 0.12 m															
2. Type of material(s) used		mudbrick (w/ clay)																	
3. Coursing (form of construction)		irregular																	
4. Orientation		E-W																	
5. Associated collapse		-																	
6. Cut & fill feature #'s		-																	
7. Repaired?		-																	
8. Associated floors		-																	
9. Surface treatments? E.g. plaster, paint, mouldings		plastered on both sides																	
10. Size of one component		0.4 by 0.2 m by 0.1 m																	
11. Bonding material		sandy silt																	
12. Excavated		Yes/No NOT EXCAVATED																	
Mini stratigraphic matrix <table border="0" style="width: 100%;"> <tr> <td style="border: 1px solid black; width: 40px; height: 20px;"></td> <td style="border: 1px solid black; width: 40px; height: 20px; text-align: center;">33290</td> <td style="border: 1px solid black; width: 40px; height: 20px; text-align: center;">33307</td> </tr> <tr> <td></td> <td style="text-align: center;"> </td> <td></td> </tr> <tr> <td></td> <td style="border: 1px solid black; width: 40px; height: 20px; text-align: center;">33321</td> <td></td> </tr> <tr> <td></td> <td style="text-align: center;"> </td> <td></td> </tr> <tr> <td style="border: 1px solid black; width: 40px; height: 20px;"></td> <td style="border: 1px solid black; width: 40px; height: 20px; text-align: center;">33325</td> <td style="border: 1px solid black; width: 40px; height: 20px;"></td> </tr> </table>			33290	33307					33321						33325		Abuts: 33325 Same as: Abutted by: Associated features: Bonded into: 33298 Contiguous with:		
	33290	33307																	
	33321																		
	33325																		
Discussion and interpretation: <p>E-W mudbrick wall formed the southern border of room 47 and the Northern border of room 11292, it is bonded into N-S wall 33298</p>																			

Remember: do not just draw the architectural feature in isolation. Show how it relates to surrounding features and include details of surface treatments, repairs/modifications/damage, bonding material(s), and associated cuts. Annotate all aspects of the feature or use a Drawing Key. Measurements must be included for all aspects of the feature and surrounding features.

Sketch Plan - Include grid co-ordinates, North arrow, and elevations.

TBM. 26.47 ↑
 B.S. . 0.29
 LOC . 26.76
 F.S. RL

the western limit of house C

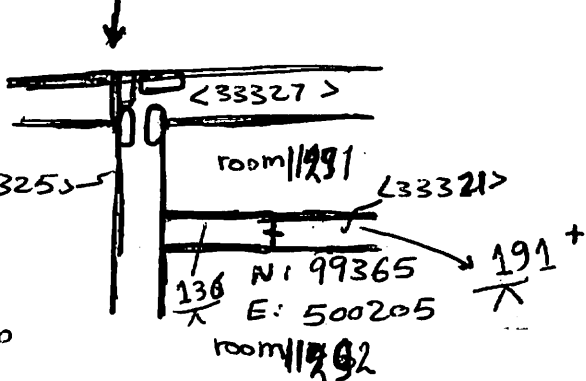

$\frac{191}{\times}$ 1.45 25.45
 $\frac{136}{\times}$ 1.22 25.54

+
 N: 99365
 E: 500200

Profile Sketch - State direction the elevation of the feature being drawn is facing e.g. 'West Facing Elevation of Feature If feature was drawn in section then include the grid co-ordinates and elevations.

Drawing No.'s: 2012-1	Photo No.'s: 512464, 512465
Space No.: 11298, 11291	Structure No.: C
Matrix Group:	Matrix Phase: 4b
Samples taken:	