

# GIZA PLATEAU MAPPING PROJECT

Grid Square(s) <b>101-N22</b>	Area <b>MVT-E</b>	Context Type <b>Deposit</b>	Central Coords	Context <b>(33355)</b>																														
<b>DEPOSIT</b>				<b>CUT</b>																														
1. Compaction 2. Colour 3. Composition/Particle Size (Over 10%) 4. Inclusions (Under 10%) occa / mod / freq 5. Thickness and extent 6. Top and bottom boundaries 7. Other comments 8. Method and conditions	1- <b>Compact</b>		1. Shape in plan 2. Corners 3. Dimension/Depth 4. Break of slope-top 5. Sides 6. Break of slope-base 7. Base 8. Orientation 9. Inclination of axis 10. Uncated (if known) 11. Fill #s 12. Other comments Draw profile overleaf																															
	2- <b>dark yellow</b>																																	
	3- <b>crushed lime stone 100%</b>																																	
	4- <b>---</b>																																	
	5- <b>0.98 M length X 0.30 M (E-W) width X</b>																																	
	6- <b>0.08m thick &amp; 80mm thickness</b>																																	
	7- <b>Not clear on top</b>																																	
	8- <b>Axis - slandy</b>																																	
Type of feature: <b>crushed limestone in space 11204 / stone-lime covering</b>																																		
Stratigraphic Matrix																																		
<table style="width: 100%; border-collapse: collapse;"> <tr> <td style="width: 10%; border: 1px solid black;"></td> <td style="width: 10%; border: 1px solid black;"></td> <td style="width: 10%; border: 1px solid black;"></td> <td style="width: 10%; border: 1px solid black; text-align: center;"><b>32863</b></td> <td style="width: 10%; border: 1px solid black;"></td> <td style="width: 10%; border: 1px solid black;"></td> <td style="width: 10%; border: 1px solid black;"></td> <td style="width: 10%; border: 1px solid black;"></td> <td style="width: 10%; border: 1px solid black;"></td> <td style="width: 10%; border: 1px solid black;"></td> </tr> <tr> <td colspan="3" style="text-align: center;">This context is</td> <td style="border: 1px solid black; text-align: center;"><b>33355</b></td> <td colspan="6"></td> </tr> <tr> <td style="border: 1px solid black;"></td> <td style="border: 1px solid black;"></td> <td style="border: 1px solid black;"></td> <td style="border: 1px solid black; text-align: center;"><b>33178</b></td> <td style="border: 1px solid black;"></td> <td style="border: 1px solid black;"></td> <td style="border: 1px solid black;"></td> <td style="border: 1px solid black;"></td> <td style="border: 1px solid black;"></td> <td style="border: 1px solid black;"></td> </tr> </table>								<b>32863</b>							This context is			<b>33355</b>										<b>33178</b>						
			<b>32863</b>																															
This context is			<b>33355</b>																															
			<b>33178</b>																															
Your interpretation:		<input type="checkbox"/> Internal <input checked="" type="checkbox"/> External <input type="checkbox"/> Structural <input type="checkbox"/> Other (specify)																																
Your discussion:																																		
<p style="font-size: 1.2em;">crushed lime stone as <del>made up</del> leveling for the mud brick wall <del>(29808)</del> in the north part of space (11204) <sup>(32863)</sup> (Pre-dates space 11204).</p>																																		
Context same as:			See contexts:																															
Site Book Refs:			Matrix phase:																															
			Initials and date <b>MAR 9 II 2012</b>																															
Checked Interpretation:																																		
Provisional period		Group/Phase		Initials and date <b>12 III 12 J.</b>																														

Context Number  
33355

GPMP  
2012

Bag Numbers

Ceramics

Objects

Environmental Samples & Type

Exotics

Charcoal

Other

Bones

Lithics

Photographs

POST-OP?

Drawings

Plans

Sections

PX 33355

Top Elevation

17.97 M ASL

Bottom Elevations

17.95 M ASL

Sketch Plan

TBM 19.75

BS 150

Loc 21.25

1/2 RL  
3.30 17.95

2/2 RL  
3.28 17.97



101M21  
N99280  
E500235

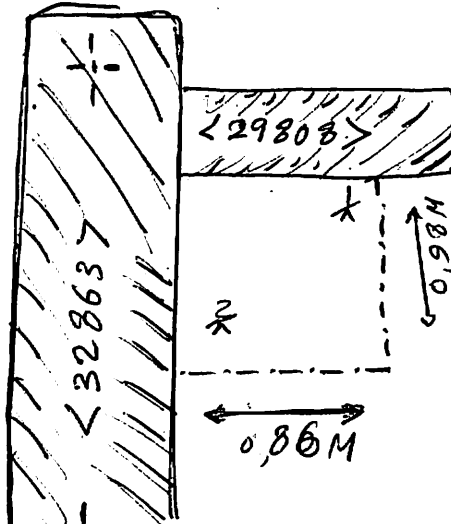

101M22  
N99280  
E500240

N99275  
E500235

101M21



N99275  
E500240

101M22