

AREA: kkt-ct	GRID SQUARE (S): H, I 45 G, 45	GRID CO-ORDINATES: E N	INITIALS & DATE: AKoA 8 March 2012	FEATURE No.: 33420 = 33416 = 33421															
FEATURE TYPE (For example wall, staircase, bench, foundation structure, platform etc.):			Full extent visible in plan: <input checked="" type="radio"/> YES / NO																
1. Dimensions (in metres)	Length: 7.60 m	Width: 0.50 m	Height: 0.55 m																
2. Type of material(s) used																			
3. Coursing (form of construction)																			
4. Orientation	North/South																		
5. Associated collapse																			
6. Cut & fill feature #'s																			
7. Repaired?																			
8. Associated floors																			
9. Surface treatments? E.g. plaster, paint, mouldings																			
10. Size of one component																			
11. Bonding material																			
12. Excavated	Yes <input checked="" type="radio"/> No																		
Mini stratigraphic matrix		Abuts <33411> Same as:																	
<table border="0"> <tr> <td>33419</td> <td>33250</td> <td>threshold</td> </tr> <tr> <td colspan="3" style="text-align: center;">└───┬───┘</td> </tr> <tr> <td colspan="3" style="text-align: center;">33420</td> </tr> <tr> <td colspan="3" style="text-align: center;">├───┬───┘</td> </tr> <tr> <td></td> <td>33415</td> <td></td> </tr> </table>		33419	33250	threshold	└───┬───┘			33420			├───┬───┘				33415		Abutted by: <33495> <33250>, <33419>		
33419	33250	threshold																	
└───┬───┘																			
33420																			
├───┬───┘																			
	33415																		
		Bonded into:																	
		Contiguous with:																	
Discussion and interpretation: North-south mud brick wall <33416> forms the western limit of spaces (11237, 11238, 11240, 11250)																			

Remember: do not just draw the architectural feature in isolation. Show how it relates to surrounding features and include details of surface treatments, repairs/modifications/damage, bonding material(s), and associated cuts. Annotate all aspects of the feature or use a Drawing Key. Measurements must be included for all aspects of the feature and surrounding features.

-I45

Sketch Plan - Include grid co-ordinates, North arrow, and elevations.

TBm 16-69
 B.S 0-58
 I.O.C 17-27

	F.S	R.L
1	1-29	15-98
2	1-17	16-10
3	1-24	16-03
4	1-23	16-04
5	1-15	16-12
6	1-17	16-10
7	1-30	15-97
8	1-29	15-98
9	1-33	15-94
10	1-15	16-12
11	1-16	16-11
12	1-15	16-12
13	1-13	16-14

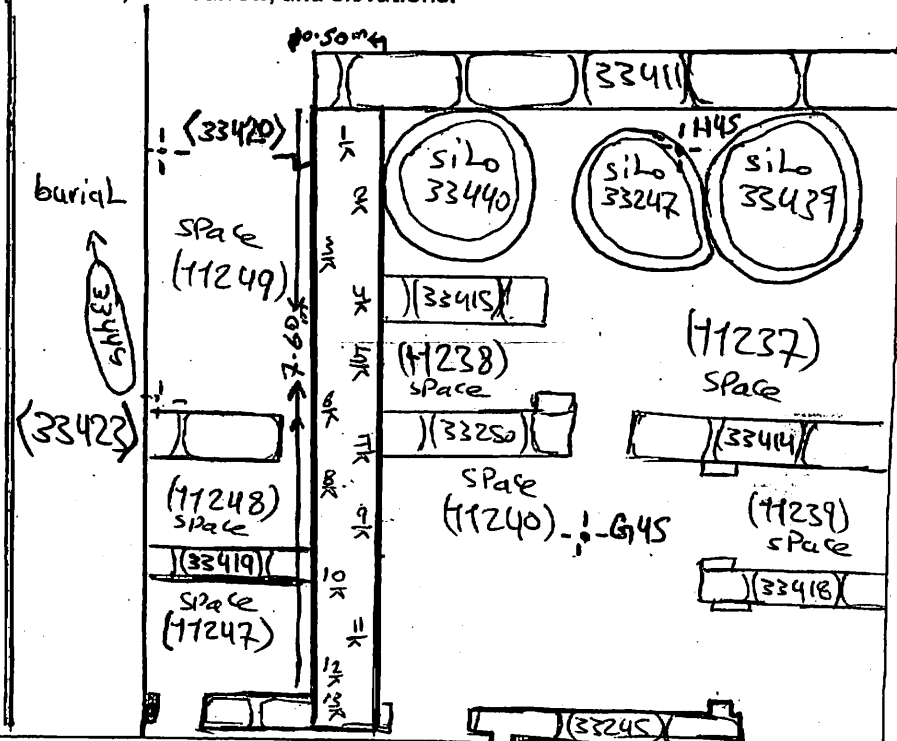

Profile Sketch - State direction the elevation of the feature being drawn is facing e.g. 'West Facing Elevation of Feature If feature was drawn in section then include the grid co-ordinates and elevations.

Drawing No.'s:	Photo No.'s:
Space No.: 11237, 11238, 11240, 11247, 11248 11249	Structure No.:
Matrix Group:	Matrix Phase:
Samples taken:	