

AREA: 14T-E+	GRID SQUARE (S): G47	GRID CO-ORDINATES: E N	INITIALS & DATE: AKOA 8 March 2012	FEATURE No.: 33426															
FEATURE TYPE (For example wall, staircase, bench, foundation structure, platform etc.):			Full extent visible in plan: <input checked="" type="radio"/> YES / NO																
1. Dimensions (in metres)		Length: 1.35 m	Width: 0.32 m	Height: 0.95 m															
2. Type of material(s) used																			
3. Coursing (form of construction) 9 2b - 7s																			
4. Orientation east/west																			
5. Associated collapse																			
6. Cut & fill feature #'s																			
7. Repaired?																			
8. Associated floors																			
9. Surface treatments? E.g. plaster, paint, mouldings																			
10. Size of one component																			
11. Bonding material																			
12. Excavated Yes <input checked="" type="radio"/> No																			
Mini stratigraphic matrix			Abuts: 33256	Same as:															
<table border="0"> <tr> <td style="border: 1px solid black; width: 40px; height: 20px;"></td> <td style="border: 1px solid black; width: 40px; height: 20px; text-align: center;">34611</td> <td style="border: 1px solid black; width: 40px; height: 20px;"></td> </tr> <tr> <td colspan="3" style="text-align: center;"> </td> </tr> <tr> <td colspan="3" style="text-align: center;">33426</td> </tr> <tr> <td colspan="3" style="text-align: center;"> </td> </tr> <tr> <td style="border: 1px solid black; width: 40px; height: 20px;"></td> <td style="border: 1px solid black; width: 40px; height: 20px; text-align: center;">33256</td> <td style="border: 1px solid black; width: 40px; height: 20px;"></td> </tr> </table>				34611					33426							33256		Abutted by:	Associated features:
	34611																		
33426																			
	33256																		
			Bonded into:																
			Contiguous with:																
Discussion and interpretation: short east-west mud brick wall (33426) forms the northern part limit of space (1235) and the southern limit of space (1234) also coated on the northern and southern face by traces of scorching...																			

Remember: do not just draw the architectural feature in isolation. Show how it relates to surrounding features and include details of surface treatments, repairs/modifications/damage, bonding material(s), and associated cuts. Annotate all aspects of the feature or use a Drawing Key. Measurements must be included for all aspects of the feature and surrounding features.

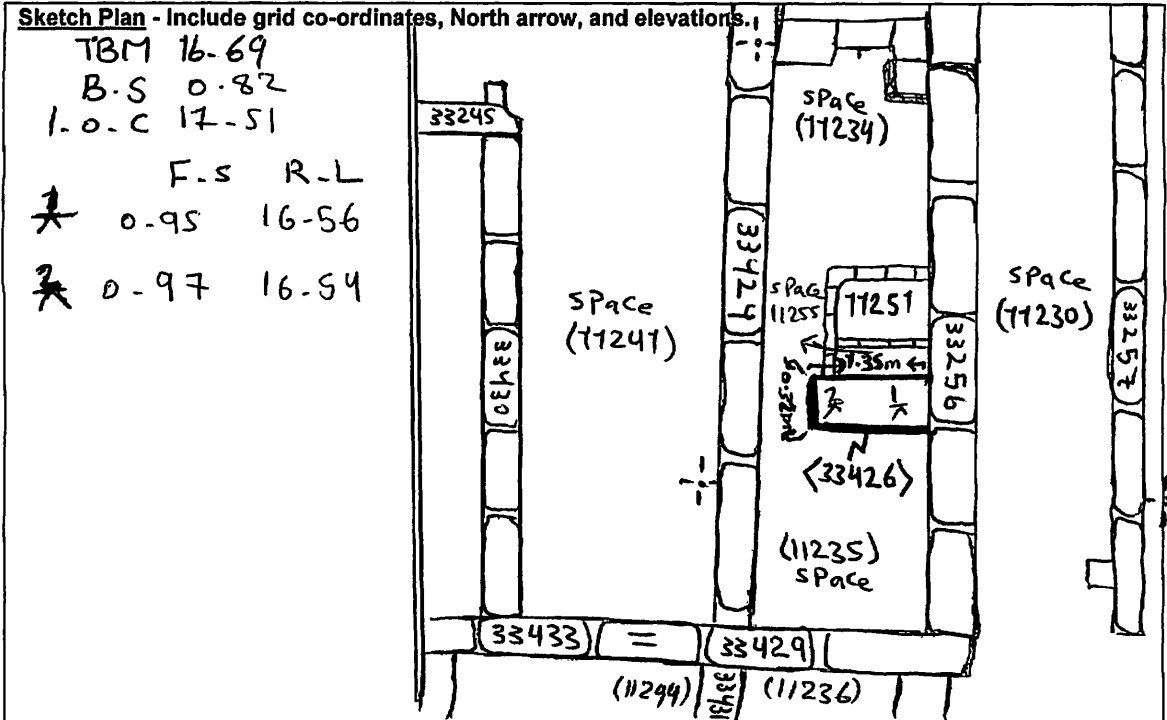

Profile Sketch - State direction the elevation of the feature being drawn is facing e.g. 'West Facing Elevation of Feature If feature was drawn in section then include the grid co-ordinates and elevations.

Drawing No.'s:	Photo No.'s:
Space No.: 11235, 11255	Structure No.:
Matrix Group:	Matrix Phase:
Samples taken:	