

AREA: KKT-Et	GRID SQUARE (S): H, I 45	GRID CO-ORDINATES: E N	INITIALS & DATE: AKoA 9 March 2012	FEATURE No.: 33440															
FEATURE TYPE (For example wall, staircase, bench, foundation structure, platform etc.):			Full extent visible in plan: YES / NO																
1. Dimensions (in metres)	Length: 1.72m N/S	Width: 1.70m E/W	Height: 0.23m																
2. Type of material(s) used																			
3. Coursing (form of construction)																			
4. Orientation																			
5. Associated collapse																			
6. Cut & fill feature #'s																			
7. Repaired?																			
8. Associated floors																			
9. Surface treatments? E.g. plaster, paint, mouldings																			
10. Size of one component																			
11. Bonding material																			
12. Excavated	Yes/No																		
Mini stratigraphic matrix <table border="1" style="margin-left: auto; margin-right: auto;"> <tr> <td style="width: 40px; height: 20px;"></td> <td style="width: 40px; height: 20px; text-align: center;">33444</td> <td style="width: 40px; height: 20px;"></td> </tr> <tr> <td></td> <td style="text-align: center;"> </td> <td></td> </tr> <tr> <td></td> <td style="width: 40px; height: 20px; text-align: center;">33440</td> <td></td> </tr> <tr> <td></td> <td style="text-align: center;"> </td> <td></td> </tr> <tr> <td style="width: 40px; height: 20px;"></td> <td style="width: 40px; height: 20px; text-align: center;">NFE</td> <td style="width: 40px; height: 20px;"></td> </tr> </table>			33444						33440						NFE		Abuts: Same as: Abutted by: Associated features: Bonded into: Contiguous with:		
	33444																		
	33440																		
	NFE																		
Discussion and interpretation:  <p style="text-align: center; font-size: 1.2em;">marl brick rounded silo in space (11237)</p>																			

Remember: do not just draw the architectural feature in isolation. Show how it relates to surrounding features and include details of surface treatments, repairs/modifications/damage, bonding material(s), and associated cuts. Annotate all aspects of the feature or use a Drawing Key. Measurements must be included for all aspects of the feature and surrounding features.

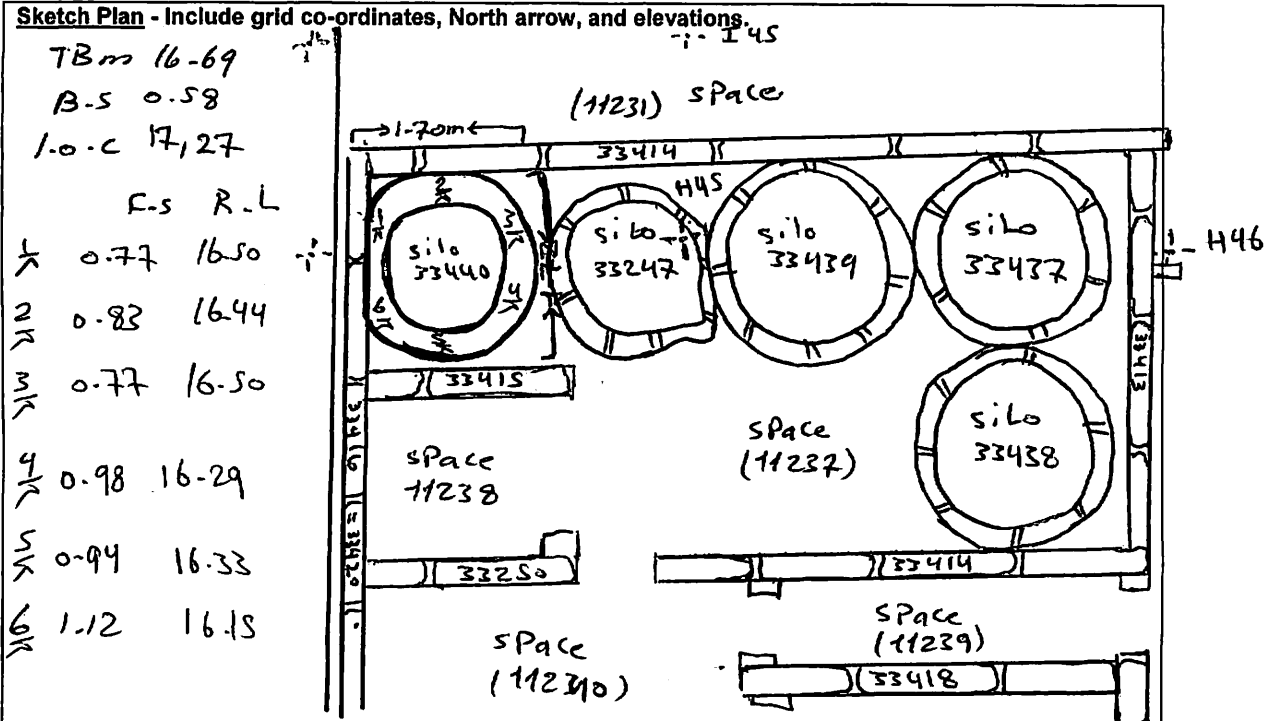

**Profile Sketch** - State direction the elevation of the feature being drawn is facing e.g. 'West Facing Elevation of Feature .... If feature was drawn in section then include the grid co-ordinates and elevations.

Drawing No.'s:	Photo No.'s:
Space No.: (11237)	Structure No.:
Matrix Group:	Matrix Phase:
Samples taken:	