

AREA: Kkt-N	GRID SQUARE (S): 201C14 201D14	GRID CO-ORDINATES: E N	INITIALS & DATE: MFMH 1-2-2012	FEATURE No.: 33474
----------------	--------------------------------------	------------------------------	--------------------------------------	-----------------------

FEATURE TYPE (For example wall, staircase, bench, foundation structure, platform etc.): wall	Full extent visible in plan: <input checked="" type="radio"/> YES / NO
---	---

1. Dimensions (in metres)	Length: 2.00 m	Width: 0.65 m	Height: 0.02 m
2. Type of material(s) used	mudbrick		
3. Coursing (form of construction)	two courses of mudbrick		
4. Orientation	E-W		
5. Associated collapse	—		
6. Cut & fill feature #'s	—		
7. Repaired?	—		
8. Associated floors	—		
9. Surface treatments? E.g. plaster, paint, mouldings	plastered by (33484)		
10. Size of one component	0.40 m by 0.15 m		
11. Bonding material	Sandy silt		
12. Excavated	Yes <input checked="" type="radio"/> No <input type="radio"/> Not excavated		

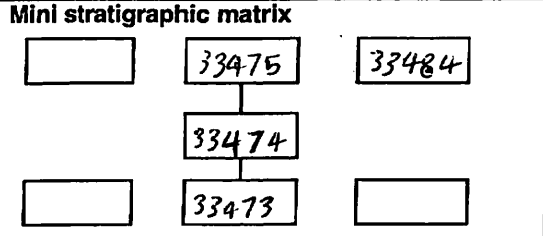

Abuts: <33473> Same as:
 Abutted by: <33475> Associated features:
 Bonded into:
 Contiguous with:

Discussion and interpretation:
 It is a mudbrick wall (E-W), it consists of two courses, the southern one is headers, and the northern one is stretchers; it measures 2.00 m by 0.65 m. It is abutted by the wall <33475> and abuts the wall <33473>, it is coated by a plaster layer (33484), and located between the spaces (11303, 11304, 11305).
 It might be abutted ends in its eastern face with the entrance (according to Selim Hassen plan).

Remember: do not just draw the architectural feature in isolation. Show how it relates to surrounding features and include details of surface treatments, repairs/modifications/damage, bonding material(s), and associated cuts. Annotate all aspects of the feature or use a Drawing Key. Measurements must be included for all aspects of the feature and surrounding features.

Sketch Plan - Include grid co-ordinates, North arrow, and elevations.

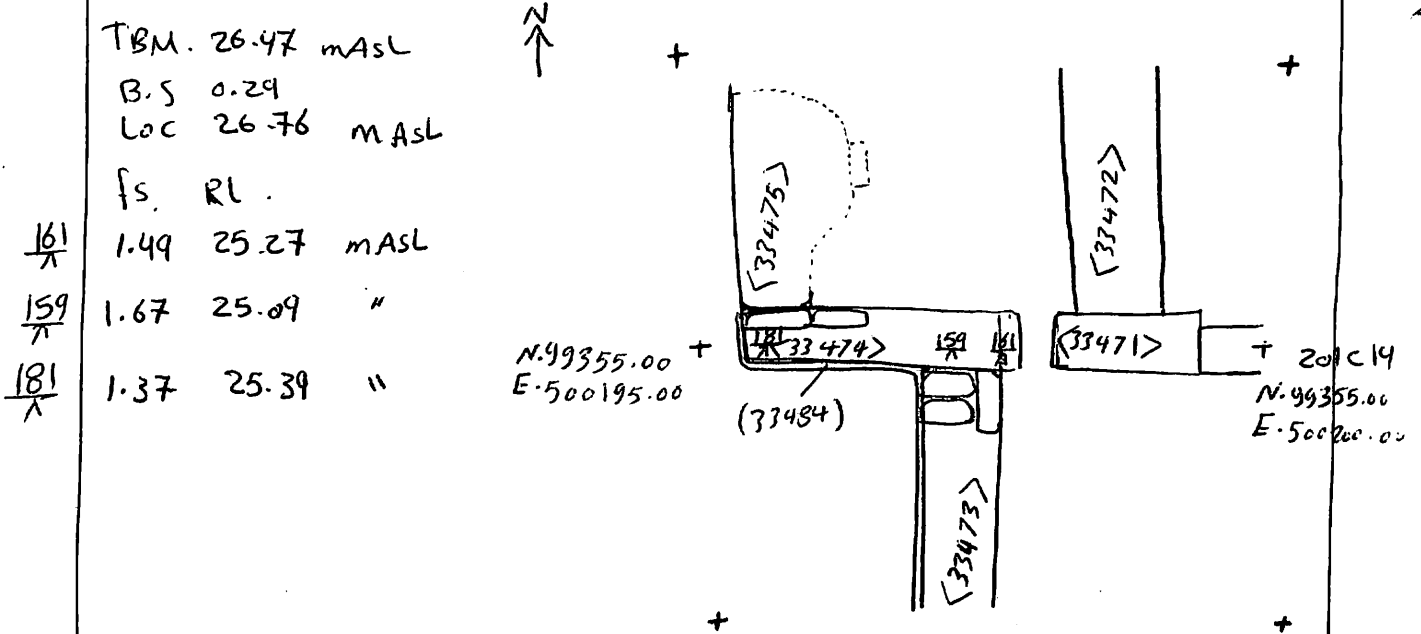

Profile Sketch - State direction the elevation of the feature being drawn is facing e.g. 'West Facing Elevation of Feature If feature was drawn in section then include the grid co-ordinates and elevations.

Drawing No.'s: 2012-2	Photo No.'s: 512746, 512747
Space No.: 11303, 11304, 11305	Structure No.: house (B)
Matrix Group:	Matrix Phase: 5
Samples taken:	