

AREA: KKE-N	GRID SQUARE (S): 201C13 201D13 201E13	GRID CO-ORDINATES: E N	INITIALS & DATE: MFMH 1-2-2012	FEATURE No.: 33477
----------------	--	------------------------------	--------------------------------------	-----------------------

FEATURE TYPE (For example wall, staircase, bench, foundation structure, platform etc.): Wall	Full extent visible in plan: <input checked="" type="radio"/> YES / NO
---	---

1. Dimensions (in metres)	Length: 12.50 m	Width: 0.87 m	Height: 0.15 m
2. Type of material(s) used	mud brick		
3. Coursing (form of construction)	two courses from the southern end and three courses from the northern end		
4. Orientation	N-S		
5. Associated collapse	-		
6. Cut & fill feature #'s	-		
7. Repaired?	-		
8. Associated floors	-		
9. Surface treatments? E.g. plaster, paint, mouldings	plastered by (33484)		
10. Size of one component	0.40 m by 0.20 m		
11. Bonding material	Sandy silt		
12. Excavated	Yes <input checked="" type="radio"/> No <input type="radio"/> Not excavated		

Mini stratigraphic matrix <div style="display: flex; flex-direction: column; align-items: center;"> <div style="display: flex; justify-content: space-around; width: 100%;"> <div style="border: 1px solid black; padding: 2px;">33478</div> <div style="border: 1px solid black; padding: 2px;">33484</div> <div style="border: 1px solid black; padding: 2px;">33479</div> </div> <div style="margin: 5px 0;"> </div> <div style="border: 1px solid black; padding: 2px;">33477</div> <div style="margin: 5px 0;"> </div> <div style="display: flex; justify-content: space-around; width: 100%;"> <div style="border: 1px solid black; padding: 2px; width: 30px; height: 20px;"></div> <div style="border: 1px solid black; padding: 2px;">33467</div> <div style="border: 1px solid black; padding: 2px;">33478</div> </div> </div>	Abuts: <33467>      Same as: Abutted by: <33478>      Associated features: Bonded into: <33486> Contiguous with:
---	---

Discussion and interpretation:

it is a (N-S) wall of mud brick, it measures 12.50 m Length by 0.87 m width, coated by a plaster layer (33484) of its eastern face.

this wall for is a main western one of the house (B), so, it forms the western wall of the spaces (11305, 11306, 11309).

we notice also, that it consist of two courses header but from the northern end consist of three courses two courses stretchers and between them one course header.

and bonded into the main northern wall of the house (B).

Remember: do not just draw the architectural feature in isolation. Show how it relates to surrounding features and include details of surface treatments; repairs/modifications/damage, bonding material(s), and associated cuts. Annotate all aspects of the feature or use a Drawing Key. Measurements must be included for all aspects of the feature and surrounding features.

Sketch Plan - Include grid co-ordinates, North arrow, and elevations.

TBM. 26.47 mASL  
 BS. 0.43  
 Loc 26.90 mASL



Fs. RL.  
 241 1.38 25.528 m Asl

253 1.06 25.84 "

265 0.93 25.97 "

270 0.63 26.27 "

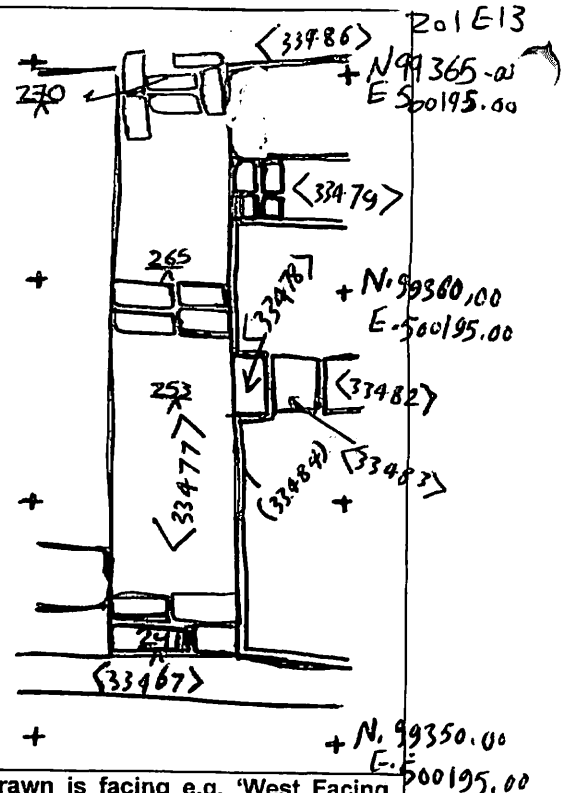

Profile Sketch - State direction the elevation of the feature being drawn is facing e.g. 'West Facing Elevation of Feature .... If feature was drawn in section then include the grid co-ordinates and elevations.

Drawing No.'s: 2012-2	Photo No.'s: 512717
Space No.: (11305, 11306, 11307)	Structure No.: house (B)
Matrix Group:	Matrix Phase: 4a
Samples taken:	