

AREA: Kkt-W	GRID SQUARE (S): 201E13	GRID CO-ORDINATES: E N	INITIALS & DATE: HAAA 11/2/2012	FEATURE No.: 33479									
FEATURE TYPE (For example, wall, staircase, bench, foundation structure, platform etc.): Wall			Full extent visible in plan: <input checked="" type="radio"/> YES / NO										
1. Dimensions (in metres)	Length: 2.70m	Width: 0.60m	Height: 0.25m										
2. Type of material(s) used	Mud brick												
3. Coursing (form of construction)	two courses of mud brick												
4. Orientation	E-W												
5. Associated collapse	-												
6. Cut & fill feature #'s	-												
7. Repaired?	-												
8. Associated floors	-												
9. Surface treatments? E.g. plaster, paint, mouldings	Plaster (33484)												
10. Size of one component	0.40m by 0.18m												
11. Bonding material	Sandy silt												
12. Excavated	Yes/No Not Excavated												
Mini stratigraphic matrix		Abuts: <33477> Same as:											
<table border="1"> <tr> <td></td> <td>33484</td> <td></td> </tr> <tr> <td></td> <td>33479</td> <td></td> </tr> <tr> <td></td> <td>33477</td> <td></td> </tr> </table>			33484			33479			33477		Abutted by: Associated features:		
	33484												
	33479												
	33477												
		Bonded into: <33480>											
		Contiguous with:											
Discussion and interpretation: it is a wall of mud brick (E-W), it consists of two courses. The southern face is stretcher and northern face is headers. it measures 2.70m length by 0.60m width, it abuts the wall <33477>, it is form the northern wall of the space (11306) and it is form the southern wall of the space (11309). The wall coated by plaster of (33484)													

Remember: do not just draw the architectural feature in isolation. Show how it relates to surrounding features and include details of surface treatments, repairs/modifications/damage, bonding material(s), and associated cuts. Annotate all aspects of the feature or use a Drawing Key. Measurements must be included for all aspects of the feature and surrounding features.

Sketch Plan - Include grid co-ordinates, North arrow, and elevations.

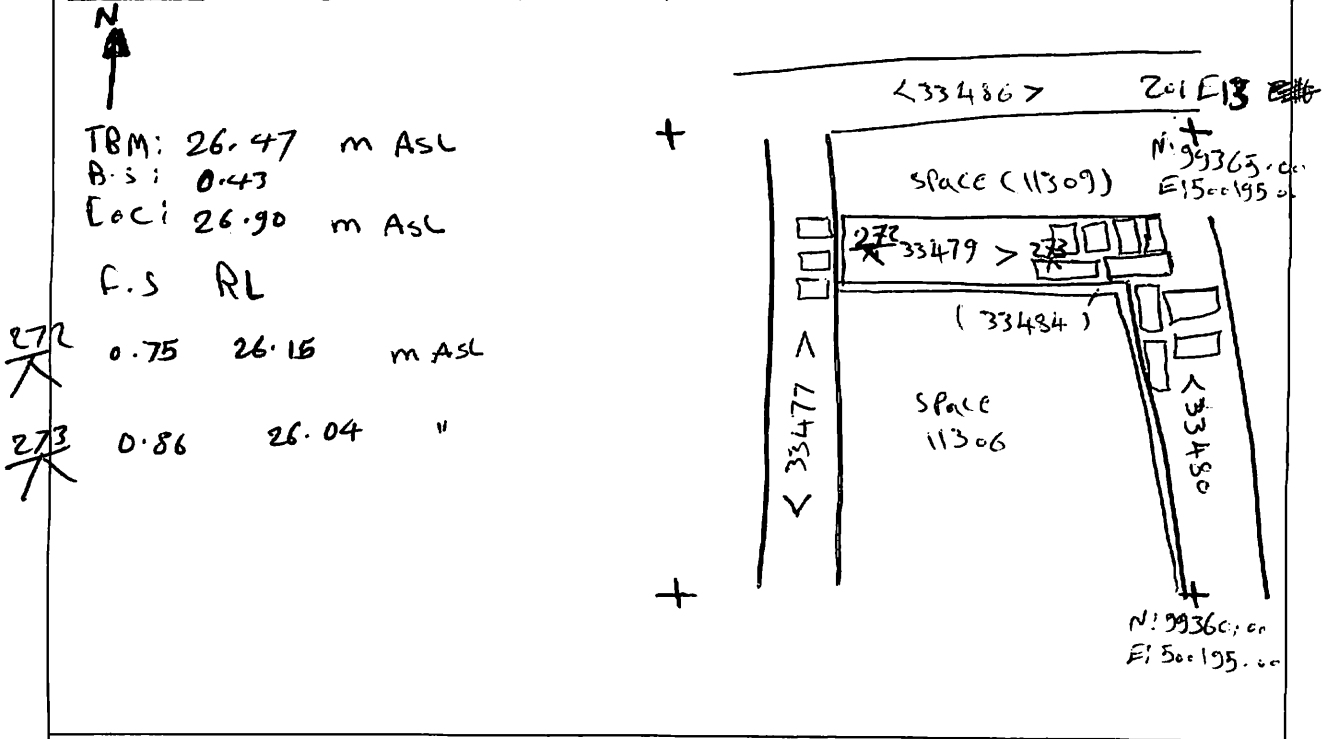

Profile Sketch - State direction the elevation of the feature being drawn is facing e.g. 'West Facing Elevation of Feature If feature was drawn in section then include the grid co-ordinates and elevations.

Drawing No.'s: 2012-2	Photo No.'s: 512724, 512725
Space No.: 11309 - 11306	Structure No.: House B
Matrix Group:	Matrix Phase: 5
Samples taken:	